



County of Santa Cruz

DEPARTMENT OF PUBLIC WORKS PARKS, OPEN SPACE, AND CULTURAL SERVICES DIVISION

979 17TH AVENUE, SANTA CRUZ, CA 95062

(831) 454-7901 FAX: (831) 454-7940 TDD: (831) 454-7978

JOHN J. PRESLEIGH
DIRECTOR OF PUBLIC WORKS

PARKS AND RECREATION COMMISSION AGENDA

Monday, April 15, 2013
7:00 p.m.
Regular Meeting

Simpkins Family Swim Center
979 17th Avenue
Santa Cruz, CA 95062

- I. CALL TO ORDER / ROLL CALL
- II. AGENDA MODIFICATIONS OR LATE ADDITIONS
- III. CONSENT AGENDA (Action)
 - A. Approve minutes from February 11, 2013.....Page 1
 - B. Consider Reports:
 1. Maintenance Section – Status ReportPages 2-3
 2. Facilities Section – Status ReportPage 4
 3. Planning Section – Status Report.....Pages 5-6
 4. Recreation Section – Status ReportPages 7-11

ORAL COMMUNICATIONS

Opportunity for persons to address the Commission on matters which are within the scope of responsibility of the Commission but not on today's agenda. Presentations must not exceed three (3) minutes in length, and individuals may speak only once during Oral Communications.

IV. DIRECTOR'S REPORT

V. REGULAR AGENDA (Pages 12-48) - (Action)

1. Consider status report regarding proposals to install a nine-hole disc golf course and to preserve open space and enhance existing trails at Anna Jean Cummings Park.
2. Select nominations for Chair and Vice-Chair for the Commission.

VII. WRITTEN CORRESPONDENCE LISTING



County of Santa Cruz

DEPARTMENT OF PUBLIC WORKS PARKS, OPEN SPACE, AND CULTURAL SERVICES DIVISION

979 17TH AVENUE, SANTA CRUZ, CA 95062

(831) 454-7901 FAX: (831) 454-7940 TDD: (831) 454-7978

JOHN J. PRESLEIGH
DIRECTOR OF PUBLIC WORKS

PARKS & RECREATION COMMISSION Minutes of February 11, 2013, 7:00 p.m. meeting 979 17th Avenue, Room B Santa Cruz, California

I. ROLL CALL

Present: Jim Lang, Katharine Minott, Steven Bennett, Dave Mercer, Michael Rosenberg

Staff: Betsey Lynberg, Gretchen Iliff

Excused Absence:

Unexcused Absence:

II. AGENDA MODIFICATIONS: None

III. CONSENT AGENDA

A. Approved Minutes from November 19, 2012, meeting.

Motion/Second: Bennett/Minott

AYES: 5

NOES: 0

ABSTAIN: 0

ABSENT: 0

B. Accepted and filed Information and Reports

Motion/Second: Rosenberg/Minott

AYES: 5

NOES: 0

ABSTAIN: 0

ABSENT: 0

IV. REGULAR AGENDA

ACTION ITEMS

1. Approved nomination of Evelyn Bernstein as a member of the Board for the non-profit Supporters & Helpers of Arts, Recreation, and Parks (SHARP).

Motion/Second: Minott/Mercer

AYES: 5

NOES: 0

ABSTAIN: 0

ABSENT: 0

V. ADJOURNMENT: The meeting was adjourned.



County of Santa Cruz

DEPARTMENT OF PUBLIC WORKS PARKS, OPEN SPACE, AND CULTURAL SERVICES DIVISION

979 17TH AVENUE, SANTA CRUZ, CA 95062

(831) 454-7901 FAX: (831) 454-7940 TDD: (831) 454-7978

JOHN J. PRESLEIGH
DIRECTOR OF PUBLIC WORKS

DATE: APRIL 10, 2013
TO: PARKS & RECREATION COMMISSION
ARTS COMMISSION
FROM: GRETCHEN ILIFF, MAINTENANCE DIVISION
RE: STATUS REPORTS ON CURRENT PROJECTS

PARKS, BUILDING, AND GROUNDS MAINTENANCE

NORTH COUNTY PARKS (Highlands, Ben Lomond, Felton Covered Bridge, Probation, Michael Gray Field, Quail Hollow Ranch and the North Coast)

- New park rules signs were install at the Miller property.
- New Beach Rule signs were install on the North Coast Beaches this month
- Staff attending an information session related to Snowy Plover Protection on North Coast beaches

MID-COUNTY PARKS (AJC, Government Center, Emeline Complex, Twin Lakes, Brommer, Felt, Floral, Coffee Lane, Soquel Lyons, Jose Avenue, Winkle Farm, Willowbrook Lane, Moran Lake, Maplethorpe, Santa Cruz Gardens, Mid-County beach access areas)

- Several large irrigation repairs were made at 701 Ocean St. Government Center.
- A section of fencing was repaired at Twin Lakes Park.
- The environmental Club from Soquel High School held two workdays and removed non-native broom from Anna Jean Cummings Park this month

SOUTH COUNTY PARKS (Polo Grounds, Valencia Hall, Hidden Beach, Seascape, Aptos Village, South County Beach access areas, Scott Park, Scott Estate, Aldridge Lane, Mesa Village, Pinto Lake, Freedom Government Annex)

- Athletic fields at Polo Grounds Parks opened March 15 for organized team use.
- Two memorial benches were installed at the Polo Grounds park.

SIMPKINS FAMILY SWIM CENTER

- Two new ADA compliant pool lifts were purchased and installed this month at the Simpkins Swim Center
- Staff received training in 'Riparian primer" , pesticide safety and safe use of equipment.



County of Santa Cruz

DEPARTMENT OF PUBLIC WORKS PARKS, OPEN SPACE, AND CULTURAL SERVICES DIVISION

979 17TH AVENUE, SANTA CRUZ, CA 95062

(831) 454-7901 FAX: (831) 454-7940 TDD: (831) 454-7978

JOHN J. PRESLEIGH
DIRECTOR OF PUBLIC WORKS

DATE: April 10, 2013
TO: Arts Commission, Parks & Recreation Commission
FROM: Gretchen Iliff, Facilities Management Division
RE: Status Report on Current Projects

Summary for reservations in the Parks for the months of February and March 2013 (excluding SFSC):

Rental revenue \$33,345.00

Attendance at Reserved Facilities:

The months of February and March begin the increased use of parks including picnic reservations, athletic field use, and center rentals that have hosted weddings, parties and memorial services. Staff estimates that approximately 21,273 park visitors attended events in reserved facilities at County Parks during these two months.

Center and Meeting Room Rentals in February and March 2013:

There were 7 weddings and receptions held at our various Park Centers and 44 meetings. Center and meeting room rental revenues totaled \$4,700.00.

The office has been very busy with inquiries and bookings for weddings and receptions for 2013 events. The summer schedule is quickly filling up.

Picnic Areas in February and March 2013:

Picnic area rentals have become busy once again as the spring season increases park use altogether. 32 picnics took place during these two months and revenues totaled \$3,150.00

Athletic Fields in February and March 2013:

Athletic fields, both baseball and soccer, opened between mid-February and mid-March after the winter season and annual renovations. Baseball, soccer and volleyball programs have quickly filled the schedules throughout County Parks' fields. Revenues for these two months totaled \$10,450.00.

Garden Plots:

Garden plot renewals at Jose Avenue and Felt Street Parks took place during the last two months. Jose Avenue has 14 garden plots and Felt Street Park has 17 plus 2 ADA garden plots. All plots have either been renewed or new gardeners have now been given an opportunity to access these plots due to a number of plots recently released during the renewal process. Many of these new gardeners have been on waitlists for years and are excited about starting their gardening experience in County Parks. Waitlists are also being maintained for garden plots at the future parks sites of Chanticleer Park and The Farm.

4



County of Santa Cruz

DEPARTMENT OF PUBLIC WORKS PARKS, OPEN SPACE, AND CULTURAL SERVICES DIVISION

979 17TH AVENUE, SANTA CRUZ, CA 95062

(831) 454-7901 FAX: (831) 454-7940 TDD: (831) 454-7978

JOHN J. PRESLEIGH
DIRECTOR OF PUBLIC WORKS

DATE: APRIL 10, 2013
TO: PARKS AND RECREATION COMMISSION, ARTS COMMISSION
FROM: BETSEY LYNBERG, ASSISTANT DIRECTOR
SUBJECT: PARK PLANNING DIVISION STATUS REPORT

BERT SCOTT ESTATE ROOF REPLACEMENT

Wald Ruhnke & Dost has prepared draft plans and specifications for replacing the roofs on the main house and on the caretaker's house. Staff is reviewing the draft construction documents.

CARMICHAEL TRAIL

This trail will provide connections between Cabrillo College, Vienna Woods neighborhoods and Nisene Marks State Park. Conservation Corps crews will clear and construct the trail mid-summer, with the trail expected to be open to the public in late summer.

CHANTICLEER PARK

On December 5, 2012 Supervisor John Leopold and Parks hosted a community meeting at the Live Oak Grange to discuss the project status, interim development and phasing plan for Chanticleer Park. The meeting was well attended and the community discussions were positive and upbeat. Staff is working with the Consultant, County Planning and community members on the approvals and implementation of the interim plan.

EAST CLIFF PARKWAY PROJECT

Although not quite complete, the community continues to enjoy the parkway improvements. The contractor has replaced the decomposed granite pathway with a more durable Granite Crete Product. The World Surfing Reserve plaque was installed in Pleasure Point Park as was a drinking fountain. The Contractor is completing other miscellaneous punch list items and change order requests.

THE FARM PARK

Parks staff continued with efforts to implement the Prop 84 Urban Greening Grant for stream and oak woodland habitat restoration and a community garden. Fish and Game permits for stream bed restoration have been secured and plant propagation is underway. A Request for Qualifications has been issued for design development and final construction documents.

FELT STREET PARK

The Contractor will be completing a warranty issue having to do with the quality of the asphalt paving in the parking lot this spring. The warmer weather will allow for a better application of the slurry seal and striping.

FELTON COVERED BRIDGE ROOF RESTORATION

Caltrans has completed the Preliminary Environmental Study for the replacement of the roof for the Felton Covered Bridge. To comply with the preliminary findings, the County has obtained a proposal from Environmental Science Associates to perform a Historic Properties Survey Report and establish the Area of Potential Effect. The results of this work will be sent to Caltrans.

HEART OF SOQUEL

Development permit application for creek side trail; gathering area; and parking & circulation improvements has been submitted and a hearing is anticipated for 2013. The County was recently awarded a State Water Board Grant over \$500,000 for low impact development features at Heart of Soquel.

MCGREGOR PARK SITE

The Consultant is preparing plans and documentation necessary to submit to the Planning Department for development permits for Phase 1 improvements of McGregor Park. Phase 1 improvements are planned to include drainage and site infrastructure, park walkways and a sidewalk along McGregor Drive, picnic area, play area, accessible parking, turf and landscaping.

PROPOSITION 40 UNALLOCATED FUNDING

In July 2011, Parks received notification that the enacted State Budget provided additional time for Proposition 40 grant recipients to complete their projects under the Per Capita and RZH Block Contracts. To date, Parks has utilized all but \$131,119 of the original grant amounts. Parks staff has submitted three new grant applications to the State. The projects include: additional picnic tables at Ben Lomond Park; new poured in place surfacing and tot structure at Willowbrook Park; and a new group picnic area and shelter at Pinto Lake Park. New Contracts with the State have been approved. Parks staff will proceed with the projects as soon as deed restriction can be recorded for each project.

6



County of Santa Cruz

DEPARTMENT OF PUBLIC WORKS - PARKS, OPEN SPACE & CULTURAL SERVICES

JOHN PRESLEIGH
DIRECTOR OF PUBLIC WORKS

979 17TH AVENUE, SANTA CRUZ, CA 95062
(831) 454-7901 FAX: (831) 454-7940 TDD: (831) 454-7978

DATE: April 8, 2013
TO: Arts Commission, Parks and Recreation Commission
FROM: Kathy DeWild, Program Coordinator
RE: Recreation and Cultural Services Division Status Report – February-April, 2013

ARTS AND CULTURAL

Public Art Projects – Artists have been selected for Phase 3 of Outside the Box, and work on seven traffic boxes will begin mid-April. The Arts Commission approved the selection panel's recommendation for the Hidden Beach Pump Station public art project; the artist will be presenting their proposal to the Sanitation Board in May.

Art Exhibitions – Karen Asherah's photographs will be on exhibition at the Simpkins Family Swim Center / Parks office through May 27.

QUAIL HOLLOW RANCH INTERPRETIVE PROGRAMS

Recent interpretive programs:

1. Eric Feuss from the Santa Cruz Bird Club offered a Beginning Birding program on Sunday, March 3 from 8:00 – 10:00 a.m. A total of 12 people enjoyed the program.
2. Two more Broom Bashes took place on Saturday, March 9 & 23 from 10:00 a.m. – 1:00 p.m. Linda Brodman from the CNPS habitat Restoration Team along with volunteer Chuck Baughman headed up the work party. Many of the old growth sites have been maintained for this year allowing efforts to expand into "old growth" broom.
3. The Nest Box Monitoring program kicked off the season on Sunday, March 10 from 10:30 a.m. – 1:00 p.m. with a training and potluck picnic. A total of about 15 people attended the training along with 5 new volunteers in the group.
4. A Composting class was offered by Otis Johnson on Sunday, March 24 from 10:00 a.m. – 12:00 p.m. Otis continued the composting theme by teaching a Vermiculture class (worm composting) in the afternoon, Sunday, March 24 from 12:30 – 1:30 p.m.
5. Five volunteers attended a Broom Bashes on Saturday, April 6 & 20 from 10:00 a.m. – 1:00 p.m. Linda Brodman led the work
6. Master Gardener, Peter Quintanilla was back for another program on Pruning Small Trees and Shrubs on Sunday, April 7 from 10:00 a.m. – 12:00 p.m.

The Mission of the Santa Cruz County Department of Parks, Open Space and Cultural Services is to provide safe, well designed and maintained parks and a wide variety of recreational and cultural opportunities for our diverse community

7

7. The first of the season's Trek to the Forbidden Sandhills began on Sunday, April 7 from 10:00 a.m. – 12:30 p.m. Sean Wharton led 10 people to the Fish and Wildlife's property to learn all about the rare and endangered flora of the sandhills habitat. In the coming weeks more wildflower lovers will have a chance to do the same each Sunday of the month.
8. Paul Haskins was back for another herp walk: In Search of Herps – Reptiles and Amphibians on Sunday, April 7 from 1:00 – 3:00 p.m. A total of 15 people enjoyed wondering along the Discovery Trail.

After two serious injuries within one month, updated safety procedures are being produced and volunteer safety trainings will take place to address emergencies on the weekend.

Upcoming interpretive programs:

1. A total of three schools will be coming out to Quail Hollow for a field trip to learn about the differences between insects and spiders in a Creepy Crawly program with Park Interpreter, Lee Summers. Programs will take place on Friday, April 12 from 10:00 a.m. – 12:00 p.m. for 9 1st and 2nd graders attending the Aptos Academy; Monday, April 15 from 10:00 – 11:30 a.m. for 16 kids going to St. Andrews Pre-school in Ben Lomond, and Monday, April 22 from 10:00 – 11:30 a.m. for a 1st and 2nd combination class attending Tierra Pacifica Charter School. Park Interpreter, Lee Summers will lead all three programs.
2. A Lost and Found birthday party will be offered by Interpreter, Lee Summers on Saturday, April 20 from 4:00 – 6:00 p.m. in which 10-year-olds will learn how to use a compass to find an invisible trail and a treasure chest of goodie bags.
3. Another Creepy Crawly field trip with Lee Summers, Park Interpreter, will happen on Friday, May 3 from 10:00 – 11:30 a.m. for 19 kindergarten kids from Tierra Pacifica Charter School.
4. Simon Stapleton along with other Master Gardeners will offer Mother's Day Fun program for kids and Dads who want to make a living gift for Moms. On Sunday, May 5 from 1:00 – 3:00 p.m. groups will decorate pots and plant flowers in them as well as make a Mother's Day card.
5. The last of the season's herp walks: In Search of Herps will take place with Paul Haskins on Sunday, May 5 from 1:00 – 3:00 p.m. The reptiles and amphibians found on these surveys will add to the park's fauna record.
6. The Santa Cruz Natural History Museum's docents will visit the park on Saturday, May 11 from 10:00 a.m. – 12:30 p.m. for a Sandhills Trek with Lee Summers, Park Interpreter. This understanding of the rare sandhills habitat will aid the group in interpreting the Morgan Reserve to children's groups that they offer.
7. A 1st and 2nd grade class from Aptos Academy will visit the park with Lee Summers, Interpreter, for a Mad Scientist Experiments program on Friday, May 17 from 10:00 a.m. – 12:00 p.m.
8. A Star and Moon Gazing program with the Santa Cruz Astronomy Club will happen on Friday, May 17 from 8:00 p.m. – 12:00 a.m. Views of Saturn will highlight the evening.
9. From Laundry to Landscape: Simple Greywater Harvesting will take place on Sunday, May 19 from 10:00 a.m. – 12:00 p.m. with Leann Ravenelle.
10. A continuation of the Leann's morning program will continue with Simple Rainwater Harvesting on Sunday, May 19 from 12:30 -2:30 p.m.

11. The Water Smart Website will be reviewed and discussed on Sunday, May 19 from 2:30 – 3:30 p.m. with Vai Campbell.
12. The Scotts Valley Charter School will visit Quail Hollow on Friday, May 24 from 10:00 – 11:30 a.m. for a Creepy Crawly field trip with Lee Summers, Park Interpreter.
13. Water's Footprints with Lee Summers, Interpreter, will take place on Sunday, May 26 from 10:30 a.m. – 12:00 p.m.

Park Interpreter, Lee Summers will attend an interpretive training on Saturday, April 27 from 10:00 a.m. – 4:00 p.m. Sam Ham, international speaker and author, will be in Santa Cruz promoting his new book on Interpretation and offering a day-long training.

ADULT AND SENIOR PROGRAMS

In April, we took a trip to the Napa Valley Wine Train and Oxbow Public Marketplace. Participants were delighted by the elegance of the Vista Dome Car that we rode in and the attention to detail that the staff delivered. The four-course lunch that was prepared and served aboard the train surpassed our expectations. In fact, one trip-goer said it was the best meal that she had ever had! Many people requested that we offer the trip again in the future. Also in April, we will be taking a trip to Golden Gate Park. Participants will be dropped off at a central location inside the park and can catch shuttles to several points of interest and plan to do what best suits their interests.

In May, we have two trips planned. On May 8 we will take a trip to AT&T Park to watch the Giants play the Philadelphia Phillies. Then, on May 25, we will take a trip to the Asian Art Museum to take a tour of the Terracotta Warrior exhibit and visit the Japanese Tea Garden.

Registration for trips scheduled through May 2014 began April 8 and staff has been very busy with registration in response to the new trips!

YOUTH PROGRAMS

In the spotlight this time around – **La Selva ACE Program and Spring Camp**

La Selva ACE - La Selva Beach After-school Childhood Enrichment wrapped up a wonderful winter and is off to a super spring. Recent weekly themes included Bouncing Bunnies with activities such as a pom pom bunnies craft, rabbit races, paper plate bunny craft, an egg hunt, colorful eggs art, spring scenes water colors and a rabbit obstacle course. A Celebrate Spring theme followed which included island tag, aluminum art, cherry blossom trees and Japanese symbols, ice cream sundaes, a flying snake craft and flag football. A Leaping Leprechaun's theme followed with activities such as coffee filter butterflies, an edible cup of worms food activity, lucky bingo, lucky survivor basketball game, tie dye paper and scratch art. A Green and Growing theme followed with activities such as egg shell planters, parachute games, mini pizzas, a new lucky blocks craft and a new construction paper flowers craft. Highlights for the past month have been a field trip to Pump'd Inflatable Fun Center, a extra special fun Wednesday, a St. Patrick's Day Potluck Party and a field trip to Mini-Golf and Laser Tag. We look forward to the rest of the spring season.

Winter Camp - All aboard! This year's Spring Camp theme was Ports of Call. Staff took participants on an imaginary cruise aboard a cruise ship and explored a different country or continent each day. After the intake party, during which participants made passports and played getting-to-know-you games, they were off to explore Australia. They made their own boomerangs and flew them, took a "Walkabout" and played Bull Rush (a traditional Australian children's game). The next port of call was the Caribbean Islands. They played games such as Sea/Shore/Sand, Capt. Jack Sparrow obstacle course, Pass the Coconut, Island Tag and more. They also made seashell necklaces and porthole crafts. On Wednesday, they took a field trip to the Boardwalk for a day of rides and fun in the sun! During their exploration of Africa, they participated in games such as a Zulu Warrior rhythm game, Mbube Mbube (a traditional African children's game), and a wild jungle obstacle course. Lastly was a visit to Mexico, where they learned a Mexican Hat Dance, broke piñatas, and played Ojo De Toro and Arco Iris. They also enjoyed face paints and music games during their BBQ potluck fiesta.

AQUATIC PROGRAMS

Spring schedule runs through March 2 –June 13, 2013

Lap Swimming - The lap pool is open for lap swimming Monday through Friday 6:00 am to 7:30 pm. Saturday it is open 9:00 am to 4:00 pm and on Sundays from 9:00 am to 12:30 pm

Warm-water Pool - The warm-water pool is available for general use on:

Tuesday/Thursday	6:00 a.m.-7:30 p.m. (Shared w/swim lessons 10:30 a.m.-12:30 p.m.)
Monday/Wednesday/Friday	6:00 a.m.- 9:30 a.m. 6:30 p.m.- 7:30 p.m.
Saturdays	9:00 a.m.-10:30 a.m. (adults only) 10:30 a.m.-12:30 p.m. (adults and children)
Sundays	9:00 a.m.-12:30 p.m. (all ages)

Recreation Swim – We provide recreation swim times which include the warm water pool and first lane or two of the 50M pool. During the summer months it will also include the deep end tube area and climbing wall as well as the water slide.

Mondays – Fridays 3:00 p.m.-5:00 p.m.

Saturdays 12:30 p.m.-4:00 p.m.

Swim Lessons - Lessons are held on Tuesday and Thursday mornings from 10:30 a.m.-12:30 p.m. and evening sessions provided on Monday/Wednesday/Friday evenings from 4:00-7:00 p.m. and Tuesday/Thursday evenings from 4:00-7:00 p.m.

Spring Junior Guard Camp - This year we held a very successful Spring Junior Lifeguard program which served the maximum amount of participants of 40 which was held April 1 – 5.

10

Adult Fitness Swimming - Adult Fitness Swimming is very popular at the Simpkins Family Swim Center. The most well attended workouts are Tuesday and Saturday mornings. Up to 49 swimmers fill the 50-meter pool at these times. Fitness swimmers may choose from among three different times each day to work out mid-week. Workouts are held at 6:00 a.m., 12:00 p.m. and 6:00 p.m. Tuesday through Thursday, Fridays at 6:00 a.m. and 12:00 p.m., and Saturdays at 9:00 a.m.

Water Aerobics & Exercise - The Water exercise classes this year reached their highest capacity so far. Water exercise is an excellent way for people to meet their fitness goals without impact on the joints. Classes are designed to appeal to all levels of ability including, healthy, pre-natal, seniors, arthritic, and rehabilitating or cross training fitness enthusiasts. A monthly calendar is available with dates, times and instructors names. Previous swimming or water exercise experience is not required to participate in the water exercise classes.

Saturday Water Polo - Drop-in Water Polo is held on Sundays from 10:30 am – 12:30 pm. You must be a member of USAWPA to participate in the program.

Pool Rentals - The Santa Cruz County Aquatics and the Cabrillo Threshers swim teams continue to rent lanes in the 50-meter pool. The swim teams offer school-age competitive swimming programs Monday through Friday from 4:00 p.m. to 6:30 p.m.

Lifeguard Training Classes – Parks is offering 4 Lifeguard Training Classes at the Simpkins Family Swim Center starting in February 2013 through May 2013. Two classes have been held during spring breaks and other two will be held on Friday evenings and Saturdays. Interested candidates can find more information on our website at www.scparks.com.



County of Santa Cruz

DEPARTMENT OF PUBLIC WORKS PARKS, OPEN SPACE, AND CULTURAL SERVICES DIVISION

979 17TH AVENUE, SANTA CRUZ, CA 95062

(831) 454-7901 FAX: (831) 454-7940 TDD: (831) 454-7978

JOHN J. PRESLEIGH
DIRECTOR OF PUBLIC WORKS

AGENDA: APRIL 15, 2013

Parks and Recreation Commission
979 17th Avenue
Santa Cruz, CA 95060

SUBJECT: STATUS REPORT REGARDING PROPOSALS FOR A SEASONAL NINE-HOLE RECREATIONAL DISC GOLF COURSE AND PRESERVATION OF OPEN SPACE AND DEDICATION AND ENHANCEMENT OF EXISTING TRAILS AT ANNA JEAN CUMMINGS PARK

Members of the Parks and Recreation Commission:

During oral communications at the November 14, 2011, Commission meeting Soquel High School students and supporters of disc golf addressed the Commission with the idea of adding disc golf at Anna Jean Cummings Park.

At the March 19, 2012, Commission meeting staff provided an overview of the process for adding new recreational features at Anna Jean Cummings Park. It was noted that the Anna Jean Cummings Park Recreational Master Plan was adopted by the Board of Supervisors in 1998 and that the Master Plan includes areas designated for recreational uses (these areas have been developed for those purposes), open space, and an area reserved for "future park uses." Staff further explained that once a project is conceptually defined that the process would include consideration before the Parks and Recreation Commission and the Board of Supervisors. Once a conceptual plan is approved, the project would be designed in further detail. Additional environmental analysis would be prepared and reviewed by the Planning Department as required by the California Environmental Quality Act, and finally amendment of the Master Plan Development Permit for Anna Jean Cummings Park would be considered by the Planning Commission.

In March 2012 the Commission also received a three page written proposal from a group of Soquel residents for the Preservation of Open Space, and Dedication and Enhancement of Existing Trails at Anna Jean Cummings Park.

At the May 21, 2012, Commission meeting, members of the Soquel High School Disc Golf Club submitted a nine page written proposal and made a PowerPoint presentation for a Seasonal Nine Hole Recreational Golf Course. The proposed course layout was shown on the portion of the park designated for "Future Park Uses" in the 1998 Recreational Master Plan. The proposal provides information about: the sport of disc golf, environmental impact and seasonal use, course design/safety, proposed course layout, construction, maintenance, proposed management, and a preliminary budget.

12

Soquel residents also presented their proposal for Open Space, and Dedication and Enhancement of Existing Trails. The proposal outlines two goals: 1) Preserve Open Space and Dedicate Existing Trails, and 2) Enhance Existing Trails. Signage conveying information about the trails, habitat, rare and endangered species, and rules are also proposed. A trail map identifies existing ad hoc trails at Anna Jean Cummings Park. Existing trails are located in park areas identified as "Open Space" and for "Future Park Uses" in the 1998 Recreational Master Plan.

Oral communications at Commission meetings and written correspondence received over this period expressed interest in supporting the high school student's proposal, the need for recreation, and the interest in preserving trails for walking and observing nature. Specific concerns were raised about the safety of discs and the possibility of environmental degradation associated with disc golf.

Given the considerable amount of input received by the Commission both in favor and opposed to disc golf, and in order to give the larger community the opportunity to understand and comment upon the proposals, a community meeting was held on February 5, 2013, at the Congregational Church of Soquel. Well over 100 people attended this meeting. Supervisor Leopold served as the meeting moderator. Both groups were given 10 minutes each to present their proposal, and the meeting was then opened to questions and comments. Participants were also given the opportunity to submit written questions and comments at the end of the meeting. All comments received at the meeting are summarized on Attachment 4. About 44 people spoke at the meeting and another 24 submitted written comments. Comments can be generally categorized as those speaking in favor of disc golf, those clearly not in favor of disc golf, and those comments considered more neutral in nature including questions, suggestions for disc golf at other locations, and other general comments. Overall, of those commenting at the meeting, more support was expressed for retaining the undeveloped portions of the park as currently used for walking, observing nature, and open space compared to those expressing support for installing seasonal disc golf.

Options

Given the two proposals and community input, Parks could proceed in a number of ways at this time.

- Develop plans for a disc golf course in more detail and prepare initial environmental analysis. The goal of this work would be to develop additional information to address community concerns about safety, shared use, and mitigation of any environmental impacts. Additional community meetings would be held to share this information and receive additional input.
- Develop plans for dedication and enhancement of open space and trails in more detail and prepare initial environmental analysis. The goal of this work would be to define this proposal in more detail and to understand the implications of permanent open space and trail dedication with regard to future park use, accessibility, and mitigation of any environmental impacts. Additional community meetings would be held to share this information and receive additional input.
- Take no further action with regard to the proposals for Anna Jean Cummings Park at this time. The Open Space and Future Park Use designations would remain as adopted in the 1998 Recreational Master Plan. The park would continue to be used as currently used.

This would not preclude continued consideration or discussion of disc golf or other recreational uses at Anna Jean Cummings Park should community interest and support warrant. Nor would this preclude consideration of other opportunities for disc golf at other locations.

Discussion and Next Steps

Santa Cruz County Parks takes pride in meeting the diverse needs of Santa Cruz County at 59 parks and facilities throughout the unincorporated areas of the County. These facilities run the full gamut from coastal access points, beaches and open space, to neighborhood parks, community parks, and community centers. Santa Cruz County Parks serve less populated rural areas and mid-county urbanized neighborhoods. Parks and recreational needs and interests are not static. Needs and interests change and evolve over time. As new sports such as skateboarding and bicycle jumping, and new park interests such as off-leash dog areas have presented themselves, County Parks has responded by engaging with the community to identify community interest, concerns and opportunities. Disc golf is an emerging sport popular among Santa Cruz County residents.

Over the last year, County Parks staff and members of the Parks Commission has received considerable input regarding the proposal for seasonal disc golf at Anna Jean Cummings Park. Well over 100 residents attended the February 2013 community meeting. As described, the process to design, plan, permit, and implement either the disc golf proposal and/or the open space and trail enhancement proposal requires considerable time and resources. County Parks has pursued similar efforts in the past when there have been sufficient community interest and support and management resources.

Staff could recommend proceeding with disc golf at Anna Jean Cummings Park only with clear community support. Currently, more interest has been expressed for retaining the current uses in the park. Thus far, no analysis has been prepared or conclusions drawn as to whether or not safety or environmental issues would be created as the result of implementing a seasonal disc golf course, nor how any possible safety or environmental issues could be addressed in the design and management of a seasonal disc golf course. Considerable time and resources would be required to design, plan, and implement disc golf at Anna Jean Cummings Park. Taking no further action regarding disc golf at Anna Jean Cummings Park would not preclude consideration of other opportunities for disc golf at other locations.

Trails exist throughout the portions of Anna Jean Cummings Park designated as Open Space and for Future Park Use in the Recreational Master Plan. Given that trails already exist, and because to take additional action with regard to open space and trails would divert resources from other County Park needs and commitments, staff is reluctant to devote resources to the Open Space and Trails proposal at this time.

Anna Jean Cummings is a well used and loved park. County Parks is dedicated to working with the community to address the diverse and changing recreational needs of the community. Staff is completing the compilation input and evaluation of proposals for Anna Jean Cummings Park and anticipates scheduling this for further action at the June 17, 2013 meeting of the Commission.

Yours truly,

JOHN J. PRESLEIGH
Director of Public Works

By:



Betsey Lynberg
Assistant Director of Public Works
Parks, Open Space and Cultural Services Division

JJP:BAL:mh

Attachments:

Anna Jean Cummings Park Master Plan
Proposal for Seasonal Nine-Hole Recreational Disc Golf
Proposal for Dedication of Open Space and Enhancement of Trails
February 5, 2013 Community Meeting Comments

AJC- disc golf report.doc

Anna Jean Cummings Park County of Santa Cruz

Draft Recreational Master Plan

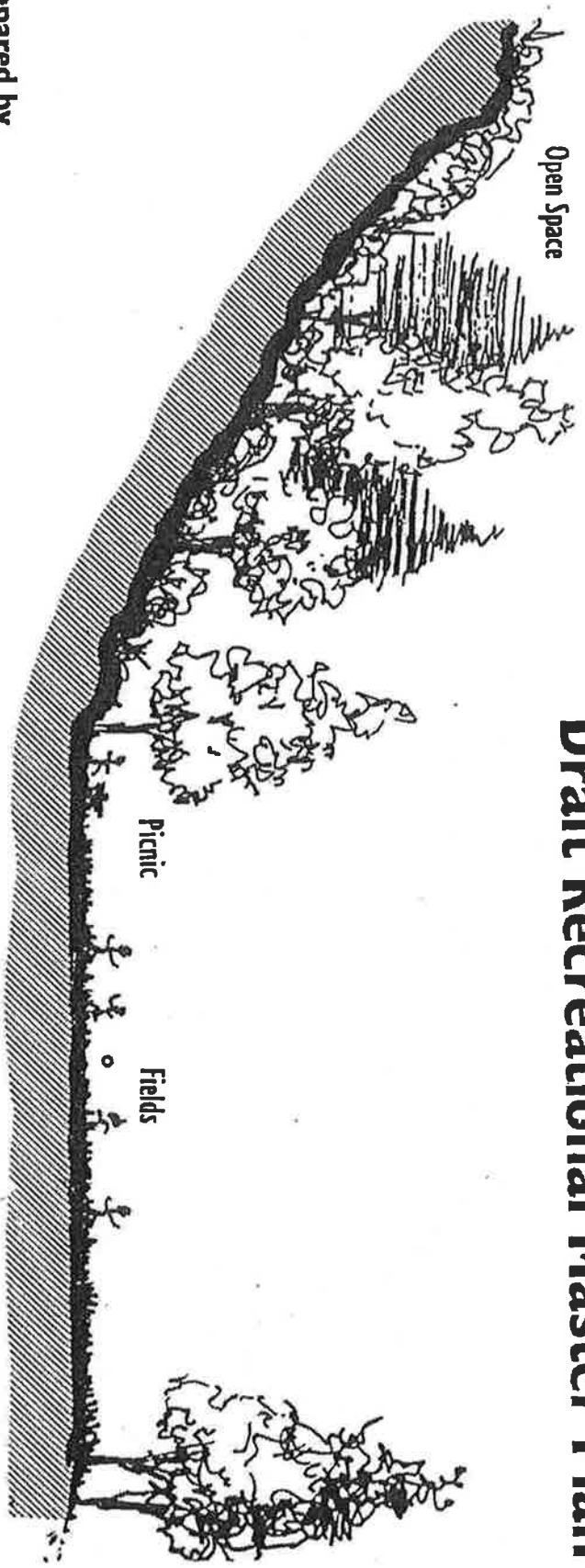

Prepared by
County of Santa Cruz Redevelopment Agency

May 1998

Introduction

The O'Neill Ranch property, now known as Anna Jean Cummings Park, was originally purchased by the Redevelopment Agency in 1989. Since that time, there has been an on-going dialog with the community about protection of the property and the design of the improvements. In 1996 the Board of Directors of the Redevelopment Agency approved an Environmental Impact Report as well as a Conceptual Plan for the property. With the approval of the concept plan attention was then focused on planning a portion of the property known as the upper and lower benches for active recreational uses. The purpose of this master plan report is to review the conceptual land use planning efforts that became the basis for the park master plan and to present the park master plan, setting the stage for the construction of major new recreational facilities serving Soquel and the mid-county area.

Background & Setting

The Anna Jean Cummings Park property is a 96.5 acre, "T" shaped property, located about one quarter mile north of Soquel Village (see figure 1 - Setting and Context). The property is vacant, and is characterized by a series of terraces, vegetated by grasses and shrubs. Riparian corridors with willow oak and eucalyptus trees, as well as riparian under story vegetation are in the southern, eastern and northeastern portions of the property.

Historically the property was used for grazing dairy cattle as a part of a large ranch which once also encompassed the Soquel Highlands neighborhood. There is no evidence that any structures were ever built on the site. For years the property has been used informally by hikers and enjoyed by the community as a visual reminder of Soquel's rural past.

The property includes more than 200 feet of frontage along Soquel-San Jose Road. An existing unpaved access from Soquel-San Jose Road travels along the property line with Soquel High School and provides access to the upper areas of the property. One private road (Greenbrae Lane) and several public roads (Valera Drive and Dawn Lane) parallel or dead-end at the property line. Many informal pathways are also found on the property.

The Anna Jean Cummings Park property has been designated for both community and neighborhood park use for a number of years. The property is adjacent to Soquel High School to the east and the currently undeveloped Tan property to the northwest. Residential uses surround the remainder of the property, with a larger lot, semi-rural neighborhood to the west (Greenbrae Lane), and suburban subdivisions to the north and northeast (Soquel Highlands, Dawn Lane and Paper Mill). To the south, a mobile home park borders the property across a broad riparian corridor. Various small businesses and vacant commercially zoned properties are located to the southwest of the property.

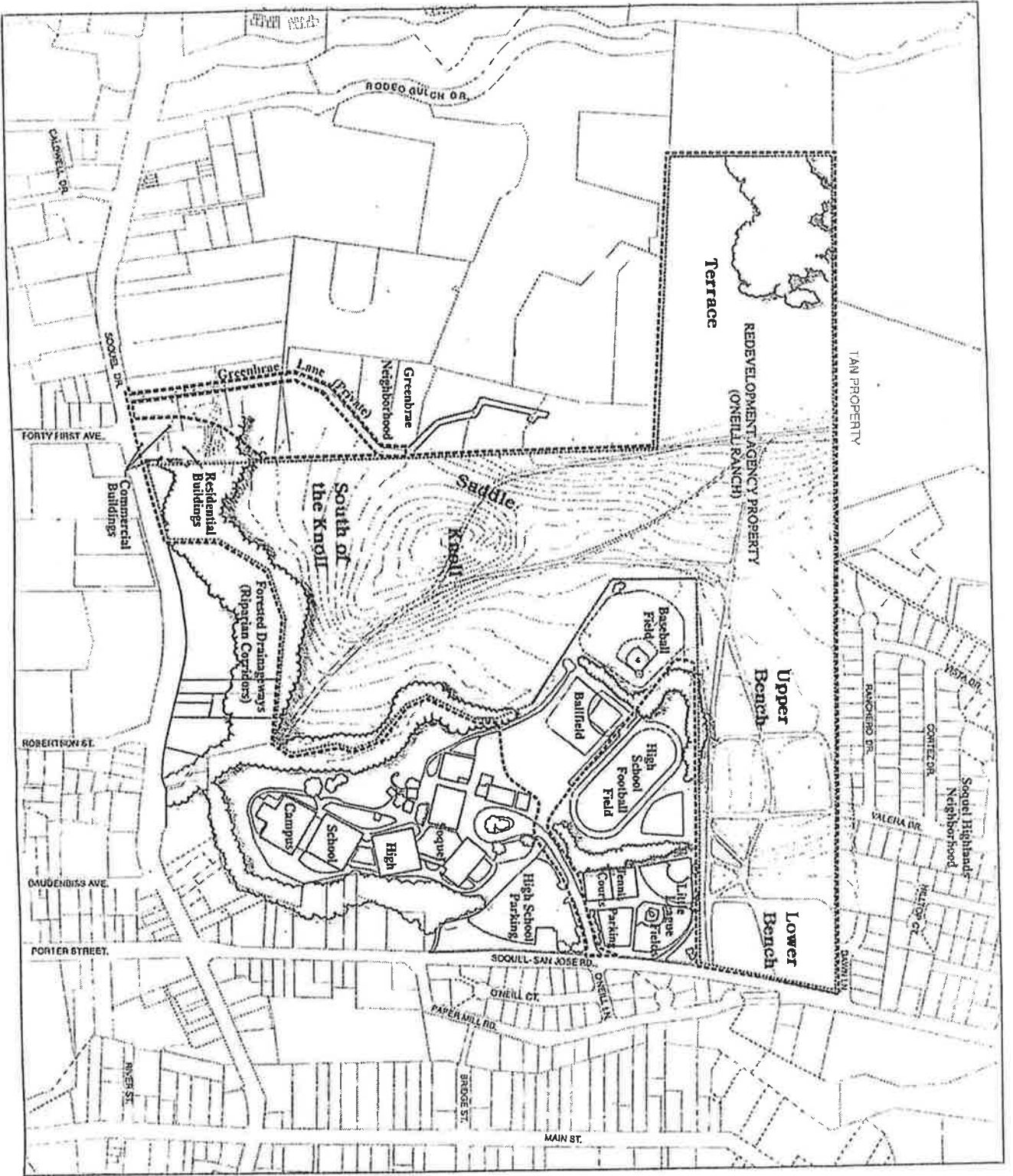

LEGEND

- Anna Jean Cummings Park Master Plan Boundary
- Redevelopment Agency Property Line
- Pedestrian Path
- ~~~~~ Existing Trees

**Anna Jean Cummings Park
Setting And Context**

Figure 1

Topography

The site can be described by a series of topographic features, several of which are visible from some distance. A series of benches characterizes the northeast leg of the "T." The lower bench (immediately adjacent to Soquel-San Jose Road) is level, approximately 4 acres, and vegetated with scrub bushes and nonnative grasses. The lower bench is separated from the upper bench by a high, steep slope.

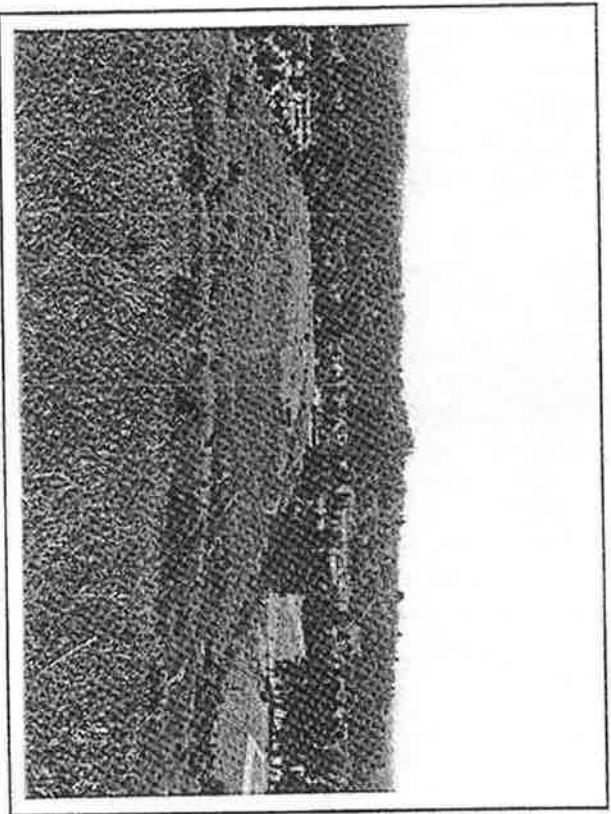

A view looking east from the upper slopes of the Anna Jean Cummings Park property, down across the upper bench.

The natural contours of the slope were altered by the placement of fill which was generated some time ago, possibly when Soquel High School or Soquel-San Jose Road were constructed.

The upper bench is a large, approximately 18 acre, nearly level area. Beyond a rolling hillside (created by an ancient, dormant landslide) is yet another terrace, the uppermost portion of the property. Portions of this series of terraces and slopes are visible from Soquel-San Jose Road.

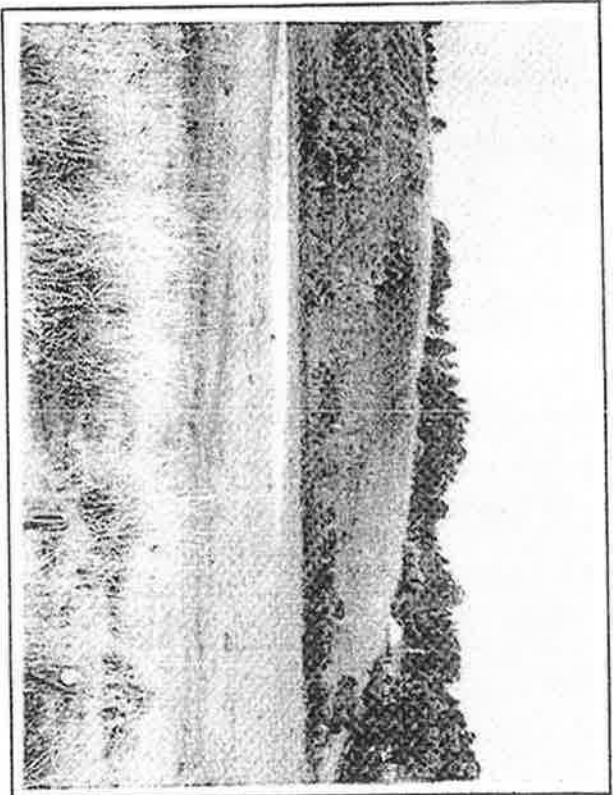

A view looking west from Soquel-San Jose Road across the lower bench, where access to the park is proposed.

The northeast leg of the "T" is composed of a terrace that is geographically continuous with the Tan property to the north. This uppermost terrace is bisected by a gully which terminates to the west in a riparian corridor that drains into Rodeo Gulch. This terrace is the habitat for rare and endangered plant species: Santa Cruz tarplant and Gairdner's yampah.

The main vertical leg of the "T" is bound on the east by a riparian corridor characterized by willows. This riparian corridor separates the property from the Soquel High School campus. Dominating this area is the knoll, a conical, steep-sloped feature which is a remnant of an ancient stream terrace. Between the knoll and the slope to the west (extending to the Greenbrae neighborhood), is a saddle or low point. South of the knoll is a gently sloping area, which terminates in an incised riparian corridor, composed mainly of oak and eucalyptus trees with a few other riparian tree species. On the other side of the riparian corridor, there is a small vacant area fronting on Soquel Drive.

Conceptual Plan

Community Process

Over the years, as various proposals were considered for the Anna Jean Cummings Park property, a considerable amount of environmental information has been developed for the site. Although the property is large, there are a number of constraints which restrict the suitable areas for development. As a part of the community planning process for the property,

a constraints map was prepared based on the information from environmental documents¹, field reconnaissance, and other technical information (see figure 2 - Site Constraints). This map helped guide decisions made about the uses and areas of activity proposed for the site.

These site constraints included:

- * Riparian corridors
- * Geologic Hazards
- * Visually Sensitive Areas
- * Steep Slopes
- * Rare and Endangered Plant Habitats

Of the entire 96-acre property, only approximately 36 acres are suitable for development. The areas of the site identified as appropriate for development include the area south of the knoll, an area between the knoll and Soquel High School, and the upper and lower benches. Because the two benches are relatively level and are not in proximity to sensitive habitats or riparian areas, it was determined that they were the best location for park uses such as playing fields.

Based on these constraints and ideas from the community planning process, a series of land use plan alternatives were proposed and environmental analysis prepared². This information was ultimately used to reach community agreement

¹ Environmental documents include a 1979 EIR prepared by Jones and Stokes for a proposed residential development.

² O'Neill Ranch Master Plan Draft Environmental Impact Report, prepared by Michael Clayton & Associates July 1991

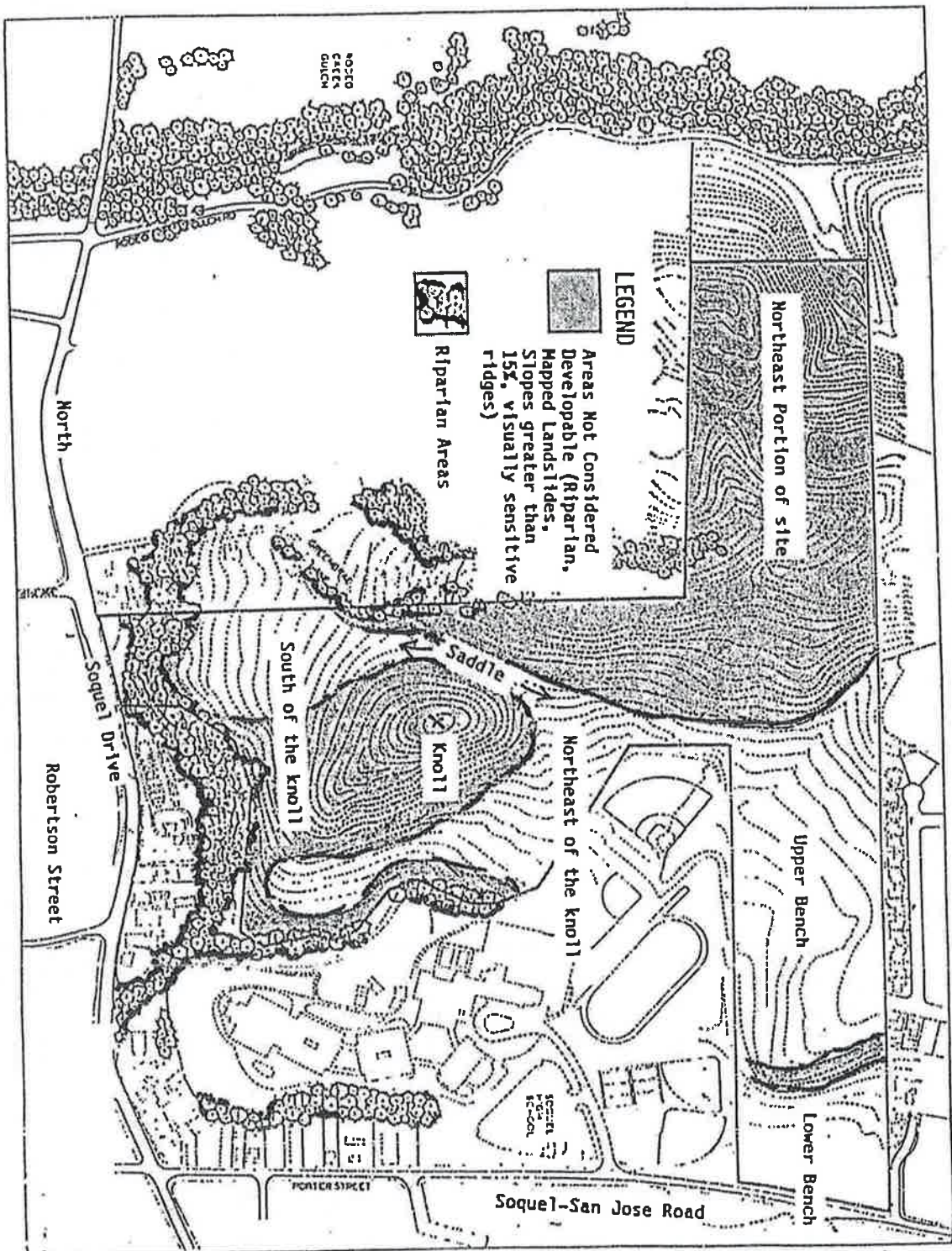

**Anna Jean Cummings Park
Site Constraints**

Figure 2

on a preferred land use plan for the purposes of further analysis. The preferred land use plan was analyzed in an Environmental Impact Report (EIR) prepared by Brady and Associates in August 1995. The EIR also looked at a number of alternatives to the project including development of the site entirely as a park.

After several public hearings and considerable community input, the Board of Directors of the Redevelopment Agency approved the O'Neill Ranch Conceptual Plan in August 1996 (see Figure 3 - Conceptual Land Use Plan).

The Conceptual Land Use Plan

The conceptual land use plan sets aside areas of the property for active recreational use, open space, future park uses, and a small commercial/office use. These general activity areas provide locations on the site to accommodate a broad range of activities, consistent with the site recreational goals developed during community and neighborhood meetings and the overall goals for development of the property (see Figure 4 - Conceptual Plan Goals).

This plan clusters active recreational uses in the northeastern portion of the site, on the upper and lower benches adjacent to Soquel-San Jose Road. These uses include a wide range of community and neighborhood recreational activities including picnic areas, play structures and playing fields for adult and youth league sports. The master plan for these active recreational uses and site access is discussed in greater detail in the following section.

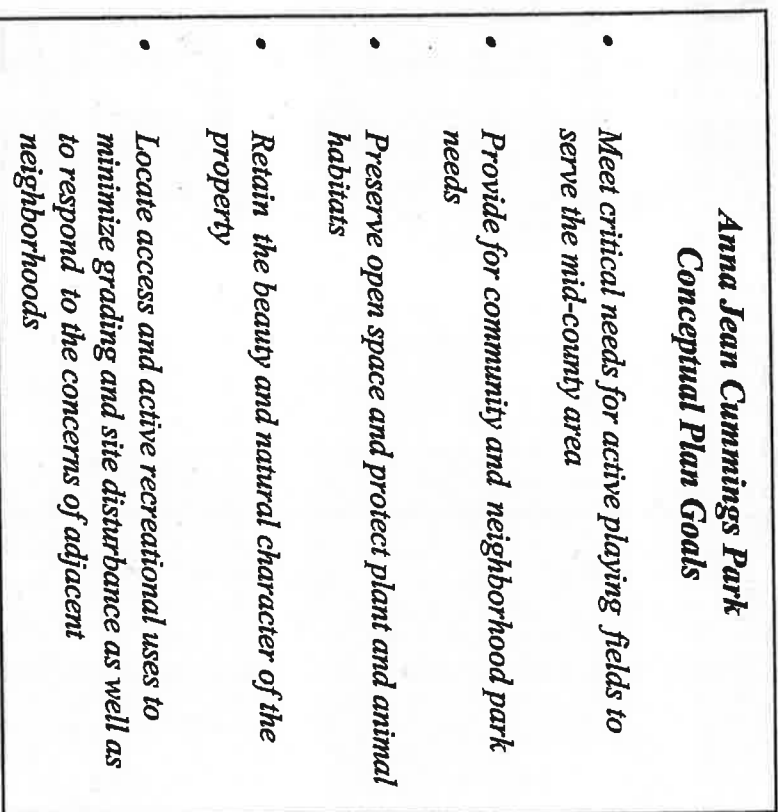
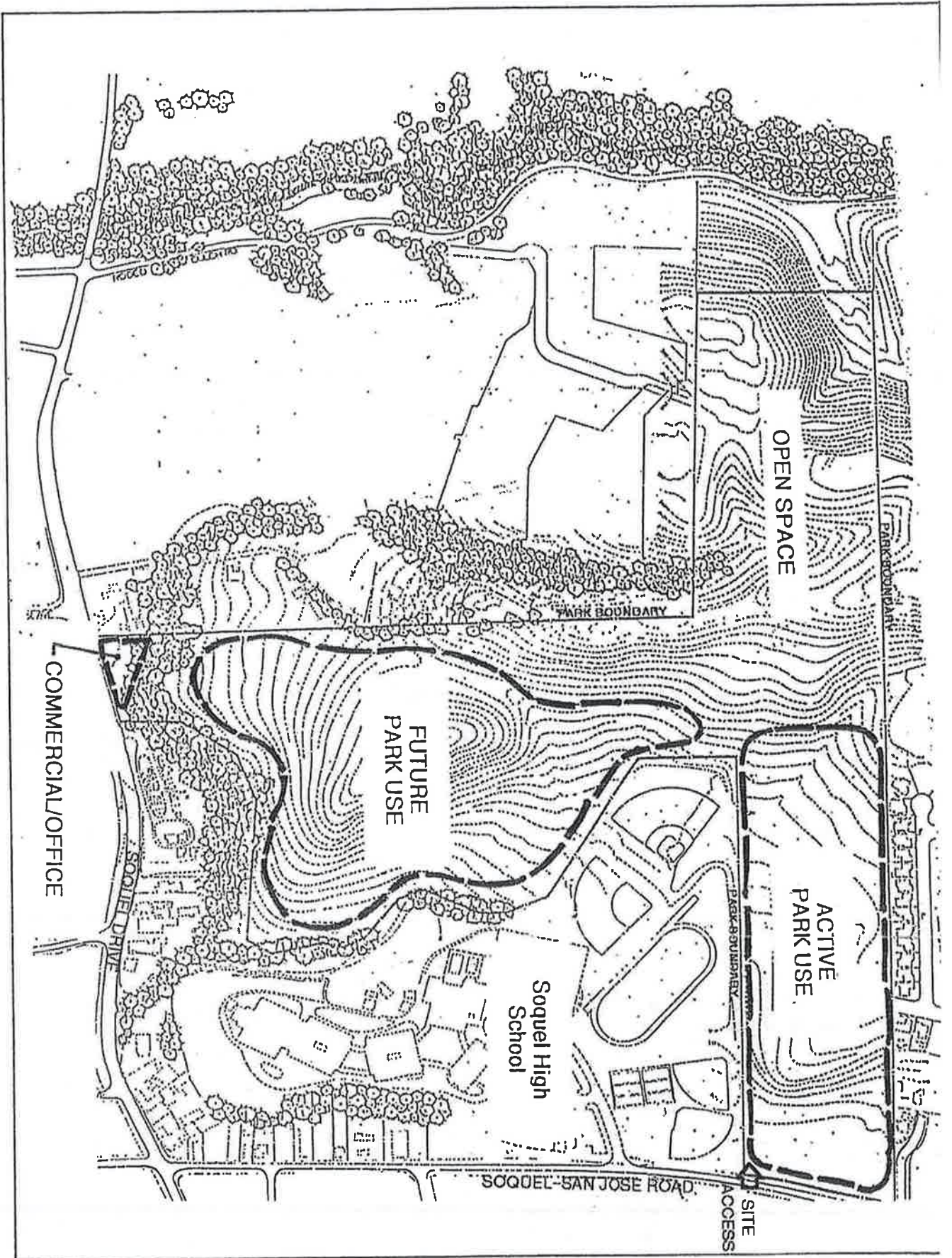

Figure 4

The upper terrace area is reserved for hiking, nature appreciation and other passive recreation activities. Habitat preservation of the Santa Cruz tarplant and Gairdner's yampah will also occur in this area.

Additional park uses, to be defined at a future time, would be located south of the knoll, and between Soquel High School and the knoll. The remaining steeper portions of the property and riparian areas would be retained as open space.



Anna Jean Cummings Park
 Conceptual Land Use Plan

Figure 3

52

Every effort was made to locate the site access and active playing fields away from riparian corridors, steep slopes and rare and endangered plant habitats (see Appendix 1 - Tar Plant Mitigation). The proposed locations of the most intensive activity have also been planned to minimize site disturbance and grading. In addition, through the community planning process, the concerns of adjacent neighborhoods and members of the community have been incorporated into the plan.

***Anna Jean Cummings Park
Recreation Elements***

- *Playing Fields for Youth and Adults*
- *Community and Family Picnic Areas*
- *Hiking and Jogging Trails*
- *Open Space and Habitat Management*
- *Access and Parking Close to Playing Fields and Picnic Areas*
- *Community Funding Partnership*
- *Potential future Expansion of Park Uses*
- *Possible Cooperative Use of Facilities with Soquel High School*

Park Master Plan

A critical community need for the expansion of active playing fields to serve the mid-county area was identified during the planning process. The need for neighborhood and regional park facilities serving the Soquel area was also recognized. As a result the park master plan envisions broad community use of the Anna Jean Cummings Park property in a variety of activities (see figure 5- Conceptual Plan for Upper and Lower Benches).

Community Design Workshops

A number of community and neighborhood design concerns were identified from the EIR and previous planning processes. Several of these concerns specifically related to how the design of the active recreation facilities affects the adjoining neighborhood, while others were tied to the function and design of the park uses that will serve the entire community.

In the spring of 1997, community design workshops were held with representatives of organized sports leagues in mid-county and members of the community to develop a plan for active recreation on the upper and lower benches. These series of meetings focused on design solutions to address the issues and concerns relating to the proposed park, and concluded with a presentation of a Preliminary Master Plan for Anna Jean Cummings Park, which with minor modifications to field layout and landscape buffers received general community support.

The area on the upper and lower benches proposed for active recreation is approximately 25 acres and is designed to blend with the natural topographic features of the site. The general features of the plan are described below followed by more detailed descriptions of actual facilities (see Figure 6- Preliminary Master Plan).

Access and Parking

Access to the site is planned from Soquel-San Jose Road at the location of an existing, unpaved driveway parallel to the southern property boundary with Soquel High School. This access has been chosen because it is the most cost effective, creates the least environmental impacts and provides direct access to the areas of most intensive activity. Because parking is proposed both on the lower bench and on the northern side of an access road on the upper bench (between the road and the playing fields), this design concept also addresses a major neighborhood concern about park users parking on residential streets. The access road would terminate in a turnaround at the base of the slope leading to the open space and regional park area. In addition to the parking along the northern edge of the access road, an area on the upper bench has been reserved for future parking, if needed

Recreational Uses

The main entrance to the park will be located on the lower bench. The master plan calls for "neighborhood" park uses, a picnic area, children's play area, restrooms and informal turf on

the lower bench as suggested by the community. Parking will be provided to accommodate use of these facilities and provide for spillover parking from the upper bench uses. As a part of development of park uses sidewalks will be constructed along the Soquel San-Jose Road property frontage. No formal access to the park will be provided from Dawn Lane. Both the access road and a pedestrian pathway will lead up to the upper bench, where the most active recreational uses will be located. These uses include two soccer fields, a multipurpose field, and additional informal picnic areas. The intention is to design the fields so that they can be reconfigured as necessary to allow for use by varied age groups and sports organizations. In order to minimize grading, the fields will be constructed in three levels. Restrooms with a concession area will be provided between the two field levels, adjacent to the parking lot and walkways.

As opportunities arise, cooperative use of park and Soquel High School athletic facilities will be explored. Future expansion of park areas and activities will occur as funds are available and community interest grows. In the interim, the area designated for future park use will continue to be used informally for passive recreation.

Highlights of the Preliminary Master Plan include:

Upper Bench

- Parking Lot - is located in close proximity to the active recreation, space for 100 cars is shown on the upper

26

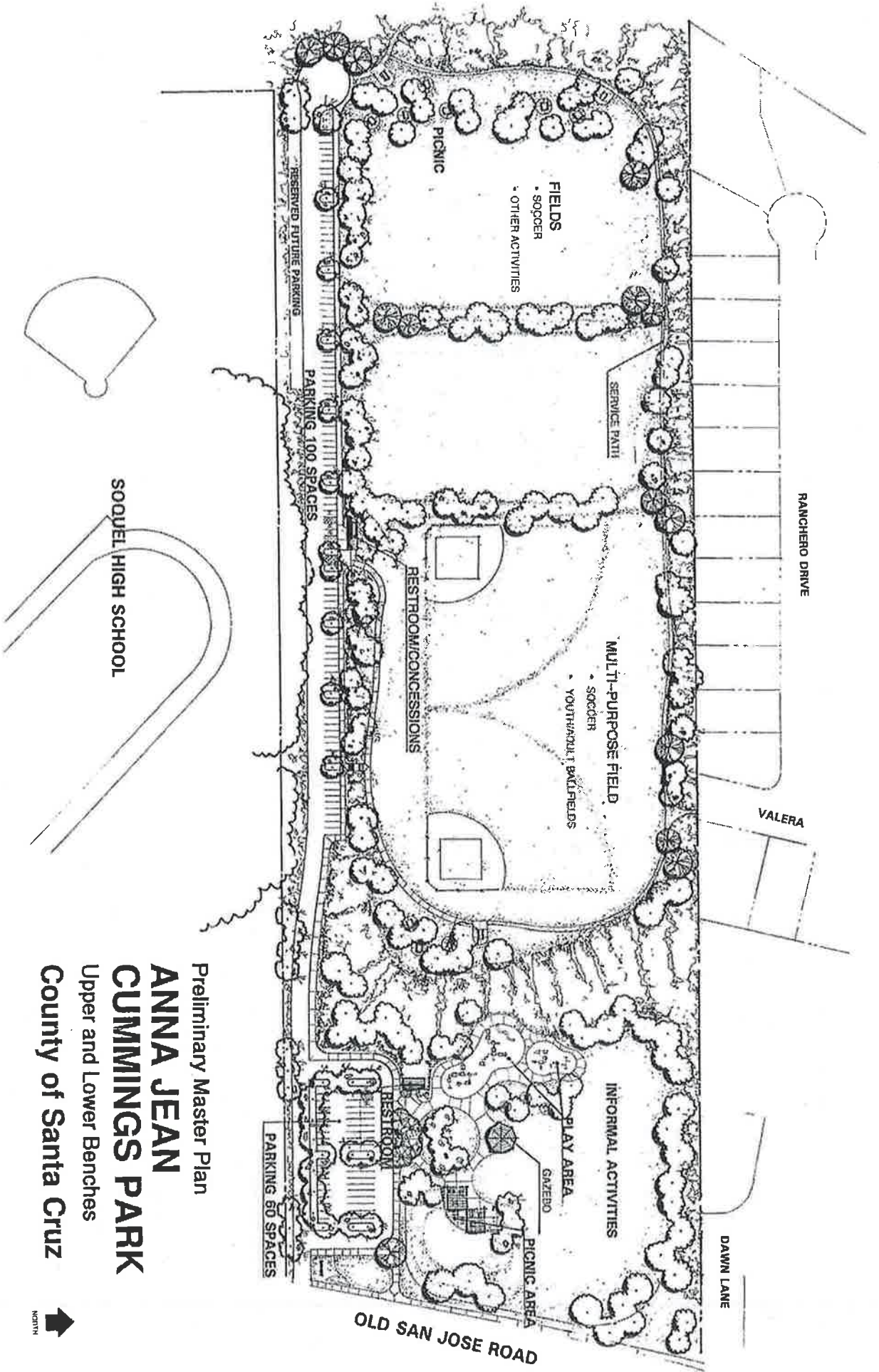

Preliminary Master Plan
ANNA JEAN CUMMINGS PARK
 Upper and Lower Benches
 County of Santa Cruz



Figure 6

bench with an additional area set aside which could increase the lot size to 140 spaces in the future. This amount of parking will discourage the use of residential street parking in the surrounding neighborhoods. The parking lot will have signage to inform high school students of restricted to park use parking only and will be landscaped.

Fields for Active Recreation - the upper bench will be regraded to create 3 terraces to accommodate 2 soccer fields and a large multi-purpose field. The multi-purpose field will incorporate 2 youth/adult ball fields or soccer play in a variety of arrangements. This plan will help the community meet the needs for active recreation in the mid-county area.

Picnic Areas - informal picnic opportunities will be available at individual locations in the upper bench area of the park intended for more private gatherings or a small party after a game. These locations will have a table and possibly a barbecue set upon a concrete pad (away from open space) located in the open sun or sometimes near a shade tree.

Restroom/Concession Building - will be conveniently located next to parking and the fields for active recreation. The prefabricated structure will be designed to not only accommodate restrooms, but also storage and concessions as suggested by organized teams. The



building will meet all codes and accessibility requirements.

Pedestrian Access - will be possible from Valera Drive, Old San Jose Road, and different points along the High School property line providing greater access to the park.

Landscaping - will consist of mixed species of trees located to shade and define activity areas such as field spaces and picnic areas and to buffer residential property lines. Landscaping will be designed to blend into the native hillside areas beyond the formal park improvements. The understory will consist of native material mixed with drought tolerant perennials for water conservation and selected with consideration of fire resistance, erosion control, and low maintenance requirements. Open turf areas will be suitable for a variety of active recreational uses.

Setback Buffer - included in the development of the park is a requirement for a buffer to mitigate noise and restrict encroachment of active park uses for residences adjacent to the park along Rancho and Valera Drives. A substantial landscaped setback will slope down from the property line to the field areas and will be planted with a variety of trees and shrubs. (see Figure 7 - Section Drawings). Existing fencing will be left in place. If after the park has been constructed and is in use, residents desire additional noise mitigation, the Redevelopment Agency will construct a new 6 foot high solid board fence.

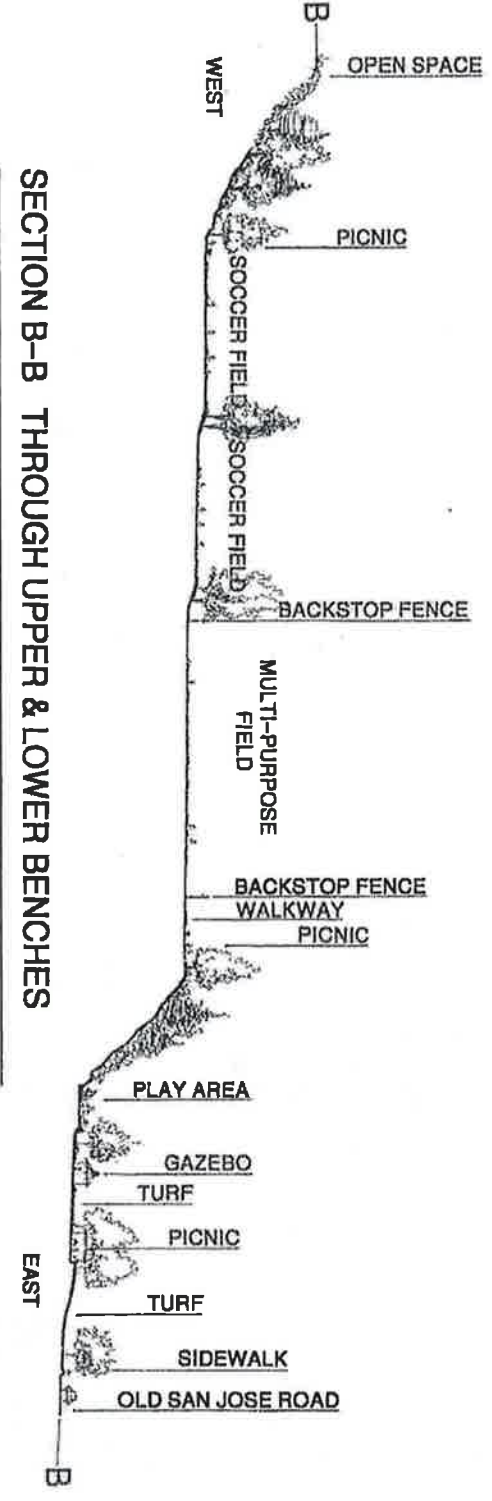
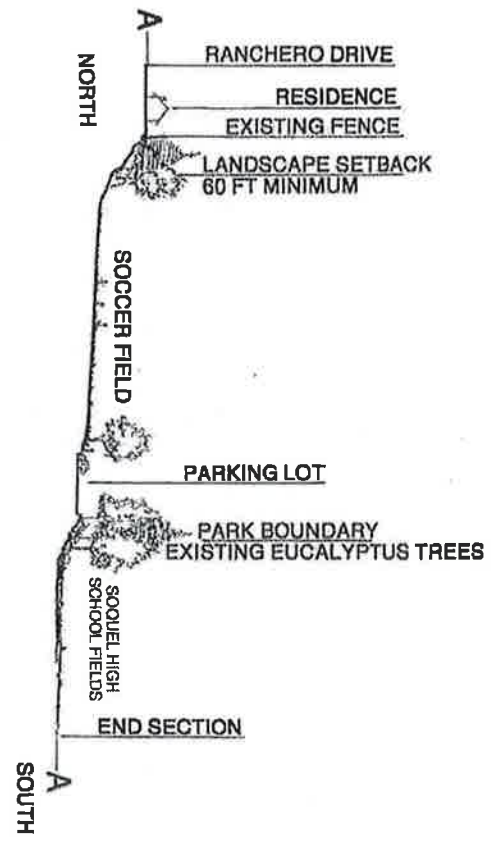

PRELIMINARY MASTER PLAN
ANNA JEAN CUMMINGS PARK
 UPPER & LOWER BENCHES

Figure 7

Lower Bench

- Parking Lot - located off Soquel-San Jose Road, will provide vehicle access to the park site. Spaces for 60 cars are located on the lower bench where picnicking and play areas are located. The lot will be landscaped.
- Picnic Area - the picnic area located on the lower bench, near the play area and will consist of a groups of tables, barbecues, trash receptacles under a shade structure surrounded by a tree canopy.
- Play Areas - on the lower bench, a large free form play area is planned which will house a multiple of play structures and swings for various age groups and will be surrounded by bench seating for careful watch by parents. The play area will meet all safety and accessibility guidelines.
- Gazebo - located off the walkway near the picnic area will provide a focal point for the lower bench and be used for presentations, informal performances, displays, or other recreation programs.
- Restroom/Maintenance Building - this small scale prefabricated structure is tucked up at the base of the slope, yet is conveniently located to serve the play area and group picnic area. This building area will also include space for equipment and supplies related to maintenance of this park facility. Maintenance areas will be appropriately screened from public views.
- Landscaping - will consist of shade trees mixed with occasional flowering accent trees grouped in locations to shade and distinguish activity areas such as; picnic areas,

- the play area, or the edges of turf areas where someone might relax away from other park activities. The understory will consist of native material mixed with drought tolerant perennials for water conservation and selected with consideration of fire resistance, erosion control, and low maintenance requirements. Open turf areas suitable for all types of informal park activities will cover the rest of this portion of the park.
- Informal Activities - the park improvements on the lower bench offer opportunities for formal and informal recreation.
 - Safety and Visibility - the layout of the park elements has been done with safety and visibility as a key requirement. The arrangement of these elements in the vicinity of the parking area allows the sheriff and other security personnel direct visibility of the restroom, play area, picnic areas, soccer and baseball fields, from the patrol vehicles. The parking lot entrance will be secured with a gate during nighttime hours.
 - Public Art - a public art component will be included in the development of the park. Two percent of the construction cost is budgeted to cover the cost of the artist fees and art component.

Anna Jean Cummings Memorial

Anna Jean Cummings, the original executive director for the Land Trust of Santa Cruz County, was instrumental in bringing community focus to the O'Neill Ranch property eventually leading to the purchase of the property by the Santa Cruz

30

County Redevelopment Agency. The Land Trust of Santa Cruz County has established a memorial fund in Anna Jean's name with the intention of constructing a tribute to her on the park property. The Land Trust will work with the Redevelopment Agency and the Parks Department to determine an appropriate setting and theme for this memorial.

Preliminary Cost Estimates

Park Development Costs

A preliminary cost estimate for the design and construction of improvements described in this plan is \$2,200,000. This estimate includes all costs associated with the design and development of the park improvements including utilities, grading and drainage, parking lots, restroom and concession buildings, all walkways, picnic areas, play equipment, a gazebo, irrigation, turf areas, landscaping and a public art project. However, only \$2,100,000 in funds have been identified for this project in the Redevelopment Agency's Capital Improvement Project Budget leaving a budget shortfall of \$100,000. In the past, organized sports leagues have expressed interest in possibly contributing to the park development to bridge any funding gaps. The budget shortfall may thus be addressed by a cooperative venture with organized sports leagues.

Park Maintenance Costs

While the development of the upper and lower benches at

Anna Jean Cummings Park will be funded by the Redevelopment Agency, state law prohibits Redevelopment Agency's from funding on-going maintenance and operations costs. Thus once the park improvements have been completed, the County Parks Department will assume maintenance and operations responsibilities.

Park maintenance cost are based on personnel costs, the cost of supplies and materials, and utility costs. The maintenance costs indicated in this report are based on existing County Park Department standards which represent a medium to high quality level of maintenance. This level of maintenance insures protection of the initial development investment as well as providing useable, well maintained facilities for the park user.

Based on existing maintenance practices within the County Parks Department, one Park Maintenance Worker is responsible for 7.3 acres of developed parkland. This figure includes supervision and specialist classifications currently used for equipment operation and repair. Material/supply costs are based on current expenditures within the County Parks Department.

Using these standards the estimated annual cost of maintaining the proposed park improvements is \$221,000 in 1998 dollars. It should also be noted that there is the opportunity for this facility to generate revenues from the use of park facilities to offset part of these maintenance and operation costs. Funding for operations and maintenance of Anna Jean Cummings Park is not currently allocated in the Parks Department Budget and will

need to be approved by the Board of Supervisors as part of the department's annual budget process.

Plan Adoption and Implementation

Plan Adoption

This Preliminary Park Master Plan must be reviewed and approved by the Parks and Recreation Commission. Then the plan will be forwarded to the Board of Supervisors for review and adoption before the Redevelopment Agency can proceed with the next steps towards implementing this plan. Public hearings will be scheduled by both the Parks and Recreation Commission and the Board of Supervisors.

Implementation

Once the park master plan has been adopted the Redevelopment Agency can proceed with the following:

- Public Art Process - which includes formation of a selection committee, development of conceptual ideas, artist selection, and public art project approval by the Art Commission and the Board of Supervisors.
- Tar Plant Management Plan- will be developed and implemented to address the management and protection of this endangered species.
- Development Permit- submitted to the Planning

Department includes review of preliminary grading and drainage plans as well as other preliminary site development plans by county departments and other agencies.

Detailed Design- once the Development Permit is approved, detailed drawings will be generated clarifying all aspects of the design and the details necessary to construct the improvements. Cost estimates will be fine tuned.

Construction Documents and Specifications- these documents are the nuts and bolts needed to hire a Contractor to develop the park. From the detailed drawings this set of documents will be used to bid the project.

Bidding and Construction- once bids have been received and reviewed by the Redevelopment Agency, a recommendation will go to the Board of Supervisors for an Award of Contract, and then actual construction will begin. At this time that date is anticipated by the Spring of 2000.



32

Appendix I

Tar Plant Mitigation

A Santa Cruz tarplant management plan will be prepared by a qualified botanist and implemented. The plan will identify areas where tarplant growth is likely, and management methods to encourage tarplant growth in these areas. Tarplant grows in moisture retaining soils where competing grasses are short due to grazing, mowing, or fire. Plan preparation is to include research on the site slope and soil conditions conducive to tarplant growth, and pilot management program (such as mowing) of some of the areas. A 5 year monitoring program and management will be set up and adjusted per habitat changes. These actions are also expected to benefit the growth of the Gairdner's yampah.

A 10 foot buffer zone will be established around existing populations of Santa Cruz tarplant and Gairdner's yampah in the northwestern part of the site. These buffer zones will be protected from human intrusion by low fences and "Do Not Enter" signs.

Acknowledgments

Santa Cruz County Redevelopment Agency Board of Directors and Santa Cruz County Board of Supervisors

Jan Beautz	First District
Walter J. Symons	Second District
Mardi Wormhoudt	Third District
Ray Belgard	Fourth District
Jeff Almqvist	Fifth District

Santa Cruz County Redevelopment Agency

Susan A. Mauriello	Executive Director
Tom Burns	Agency Administrator
Sue Gilchrist	Project Coordinator
Betsey Lynberg	Urban Designer
Gary Carlson	Park Planner

Santa Cruz County Department of Parks, Open Space and Cultural Services

Barry Samuel	Director
Dave Mitchell	Park Planning and Development Manager
Gretchen Illiff	Facilities and Maintenance Manager
Clark Beattie	Recreation and Cultural Services Manager

Anna Jean Cummings Park Proposal:

1. Preservation of Open Space
2. Dedication and Enhancement of Existing Trails

Summary

The open space and trails at Anna Jean Cummings Park are highly popular with the immediate Soquel community and residents from throughout the county. Most of these trails existed prior to the establishment of the park in 2000. Trail use has increased exponentially over the years since then. It is the only public open space in Soquel and only one of a few areas in the mid-county where safe, natural trails are available and easily accessible. Both the moderate and the more challenging trails continue to be used by nature-lovers, dog-walkers, hikers, runners, athletic teams from sport clubs and the neighboring high school, and out-of-town visitors while enjoying local sports events.

See EXHIBIT A: AJC Trail Map

Goal #1: Preserve Open Space and Dedicate Existing Trails

The open space of Anna Jean Cummings Park has offered the community an historical and visual corridor, gracing the village since Soquel was established in the 1800's. In the years prior to becoming a park, the property was a dairy farm known as the O'Neill Ranch. After the dairy stopped operating almost 50 years ago, Soquel residents began using the property as a corridor from Soquel Highlands to the high school and village and as a place for running, walking and passive enjoyment of the open space.

Maintaining this open space and trail use was a priority during the extensive community planning process that resulted in the 1998 Parks Master Plan still in effect today. Dedication of the trails and open space would encourage good stewardship and would ensure that the existing open space be protected for passive recreational use for future generations.

Goal #2: Enhance Existing Trails

Visitors to Anna Jean Cummings Park are often confused about the boundaries of the open space areas of the park and unclear about where the trails lead. Informational maps, trail names and directional signage would help visitors orient themselves in the open space and assist them in planning their time there. Information would also protect the natural terrain. Some specific improvements might include:

1. Informational and directional signs for trail users near the upper parking lot and at several key points along the trails. These might include a trail map, arrow signs, trail names and mileage markers.
2. Educational information highlighting the chronological history of the park and its ecological features such as geological, flora and fauna. This could possibly include the six known biotic habitats (seasonal wetland, mixed evergreen forest, non-native grassland, coyote scrub, chaparral, and mixed riparian forest.)
3. "Sensitive Habitat" or "Stay on Trail" signs located where terrain is especially vulnerable to users. This might include areas within a high water table, riparian corridor, or containing endangered plants, such as Gairdner's Yampah, Bunchgrass and Tar Plant.
4. Identification markers for common, rare and endangered species of animals, plants and insects identified in the 1995 E.I.R. which inhabit the Anna Jean Cummings Park open space. Such markers could be placed along trails to help familiarize visitors with the unique characteristics of the park and act as an educational opportunity and enhancement. This project could encourage participation by both local environmental and educational groups.
5. "Dog Etiquette Rules" and "Pack Your Trash" signs along the trail. The land and wildlife should be respected. Dog poop and trash left behind have negative visual and environmental impact. Additional biodegradable poop stations (as are commonly found in other parks) and trash receptacles would be helpful.

Respectfully Submitted by:

Friends of AJC Park

EXHIBIT A: AJC Trail Map

— AJC Park Boundary

— Existing Trails

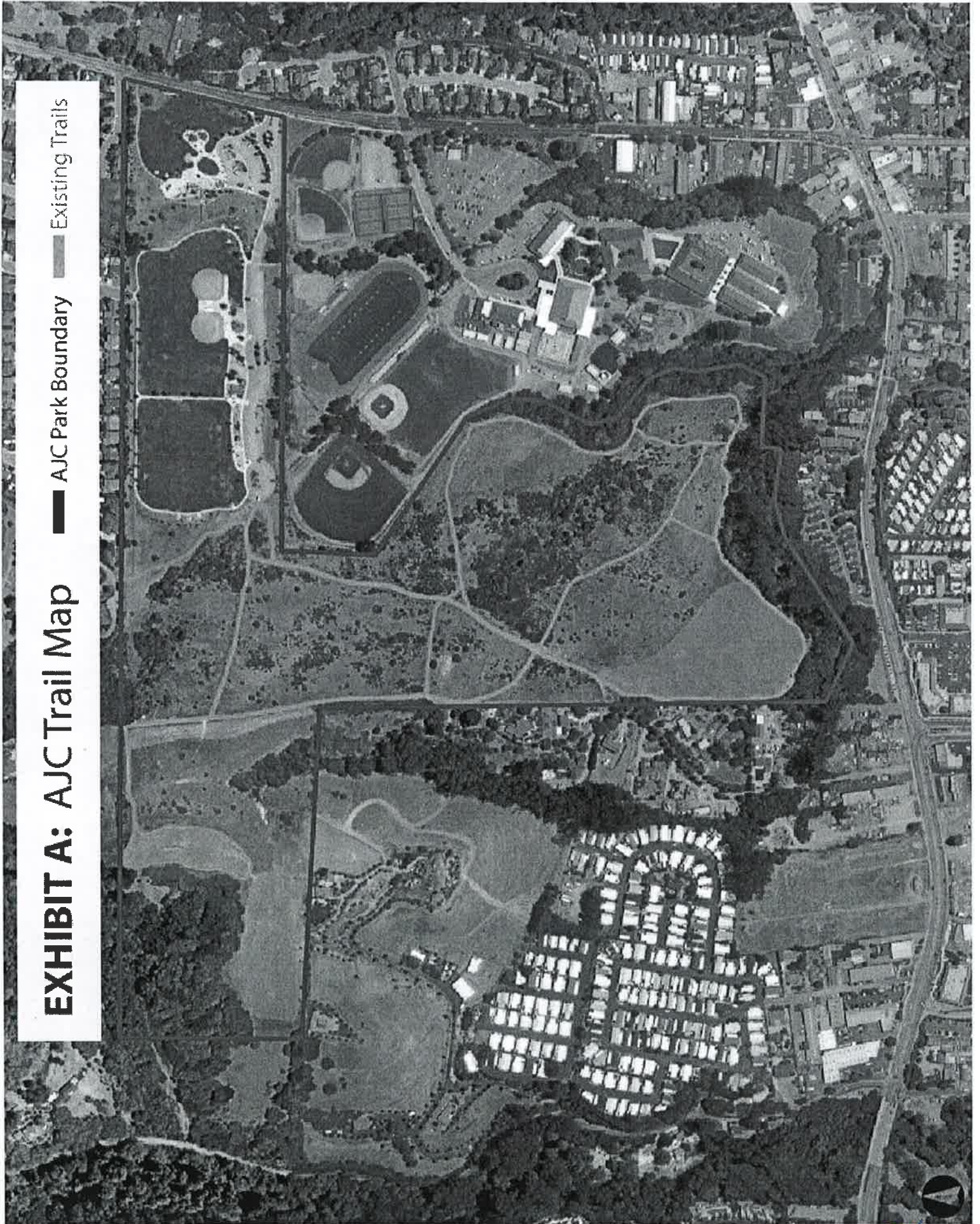

Proposal for Enhancement to Anna Jean Cummings County Park; Seasonal Nine Hole Recreational Disc Golf Course

The Soquel High Disc Golf Club (SHDGC) proposes to install a 9-hole seasonal disc golf course at Anna Jean Cummings (AJC) County Park "south of the knoll and between Soquel High School and the knoll."¹ The course will be installed on a 12 month provisional basis, after which time there will be a review to determine whether the course should remain, any changes should be made, or be removed.

BACKGROUND

In 1999, the Soquel High School Disc Golf Club was founded, and in that same year they started competing in the Santa Cruz County Interscholastic Disc Golf League (SCCIDGL). The original club included current world champion Nate Doss, however, it is the current club and its members who are finally acting on the club's long time dream to design a disc golf course for interscholastic competition, team practice, and off season recreation at Anna Jean Cummings County Park. Our season starts in mid March and continues into May. Each Sunday; during the season, all the teams of the league (Soquel, Aptos, SLV, Santa Cruz, Harbor, PCS, and Scotts Valley) meet for inter-league competition. All the matches this past season were split between the SLV and Aptos home courses. Scotts Valley is currently working on one for their school while Harbor has a 6 hole course around the track and their playing fields.

RATIONALE

Like the Disc Golf Clubs of SLV, Aptos, Scotts Valley and to some extent Harbor, the Soquel club would like to have a local home course as well. Unfortunately our campus only has the space to support a couple of practice holes and so we have looked to AJC not only to install a course for team practice and league competition, but for the promotion of the sport with the students of Soquel High School, the SHS physical education program and for the greater Soquel community itself. Our closest disc golf course, DeLaveaga, is a 27-hole championship course that is rated as one of the most difficult courses in the world. What we are proposing for AJC is a *recreational* course designed for all types of players especially for beginners and those just learning the game. With limited space on the Soquel High grounds, and with AJC being adjacent to the campus and part of our local community, it is the ideal location for our proposed course.

The installation of a disc golf course would also be consistent with the stated goals of the recreational master plan for AJC. Under the Conceptual Land Use Plan on page 6 the plan mentions "Additional park uses, to be defined at a future time, would be located south of the knoll, and between Soquel High School and the Knoll" and then the Conceptual Land Use map on pg. 7 (figure 3) designates an area for "future park use." It is within this "future park use" area that we have designed our 9 hole course.

On pg. 8 of the master plan, under the AJC Park Recreation Elements "cooperative use of facilities with Soquel High School" is mentioned and later on pg. 10 under Recreational Uses once again it states that "As opportunities arise, cooperative use of park and Soquel High School athletic facilities will be explored. Future expansion of park areas and activities will occur as funds are available and community interest grows." The P.E. Department from Soquel High School has been very supportive of our proposal and would look forward to cooperative use of the facilities as would we during our disc golf season.

With kids spending more and more time in front of the computer on the Internet, watching TV, playing video games or doing all the above on their phones, we are proposing a healthy alternative. The cost to play a sport on campus can run a family hundreds and hundreds of dollars, disc golf is inexpensive and can be enjoyed immediately on your first time out, not just by students, but people of all ages and abilities.

¹ County of Santa Cruz Redevelopment Agency. *Anna Jean Cummings Park*. County of Santa Cruz Redevelopment Agency. N.p.: n.p., 1998. 10. Print.

Proposal for Enhancement to Anna Jean Cummings County Park; Seasonal Nine Hole Recreational Disc Golf Course

What is Disc Golf?

Disc golf is a fun and inexpensive game that can be enjoyed by people of all ages and abilities. It is played much like traditional golf, only instead of hitting a ball into a "hole", you throw a disc into an elevated metal basket. As players progress from the "tee" to the "hole," they must make each consecutive shot from the spot where the previous throw landed. Once you get close enough, you throw the "putter" into the basket, ending the hole. The natural changes in terrain provide challenging obstacles for the golfer to meet the goal of completing the course in the fewest number of shots.

Meeting Recreational Needs:

Disc golf is the fastest growing sport across the United States, especially in the Bay Area. There are now more than and more than 2,400 disc golf courses (with over 52,000 registered disc golfers) in the United States and Canada, many installed by city and county parks departments who have found that there are few recreational activities that offer the high benefit-to-cost ratio of disc golf. A disc golf course at AJC will provide an inexpensive form of recreation for people of all ages, from children to seniors, and be a welcome addition to the Physical Education Department curriculum at Soquel High School.

Affordability & Accessibility:

At a time when school sports can cost hundreds of dollars to play, disc golf is an inexpensive alternative. The course will be free to the public and open on a seasonal basis to coincide with the County Parks seasonal use of the playing fields at AJC. The only equipment needed is a disc which can cost between \$5-\$20 and can be used over and over again.

Environmental Impact: Why a seasonal 9 hole Course?

Though the impact is less significant compared to other recreational sports, a byproduct of disc golf is foot traffic and trails will be created. We are proposing a seasonal course (pulling the baskets in the off season) from November 15th thru March 15th in hopes to significantly reduce environmental impact during the rainy winter months. AJC Park closes their playing fields during this same time period, and so we would coincide with AJC's seasonal closures.

Disc golfers tend to take great pride in where they play, which helps reduce potential litter on the course. Most recreational activities require alterations to the landscape and continual maintenance, while disc golf uses each unique landscape as an obstacle and requires minimal maintenance. The visual corridor or impact of a disc golf course on the surrounding area is also minimal: the tees are level with the ground and are visible only from a short distance, while the baskets are a dull metal color and do not significantly stand out. At AJC, the course has been designed to avoid riparian areas. The existing trails will be improved during course installation (especially the steep path down the eastern side of the knoll), and new paths will be added in certain areas to minimize the impact of foot traffic, and reduce erosion.

Course Design/Safety:

The 9 hole course has been designed with the safety of players and park-users as the top priority. Flight path is directed away from trails, while out-of-bounds helps to ensure safety, and reduce environmental impact. Eight of the nine proposed holes are specifically designed to discourage the throwing of discs in the direction prospective shared users using the perimeter trail. Care has been taken in the design of the course to eliminate user conflicts, minimize potential damage to foliage, and reduce erosion.

The course has also intentionally been designed as a *recreational* course, in comparison to a *Champion* Course, like those found at Pinto Lake and DeLaveaga. A recreational course tends to be shorter and caters more towards the beginner and intermediate players; perfect for youth, families, and anyone else who is unfamiliar with the sport. There are many of these beginners attending Soquel High who could use this course, either for their PE class, an after-school sport, or for practice and competition in the disc golf club.

Proposal for Enhancement to Anna Jean Cummings County Park; Seasonal Nine Hole Recreational Disc Golf Course

The holes (a brief summary and length):

The course begins at the upper parking lot where a rules and etiquette sign will be posted with a course map, notifying both players and walkers where the shared use area of the park will be. Along the "Saddle" trail, and throughout the course are located small signs close to the ground with arrows that will help direct players to the following tee. The perimeter trail and the major trails dissecting the knoll are all to be designated out of bounds.

- 1 140 feet (O'Neil Ranch*): Located in the south west corner of the knoll on a slight uphill slope, it's a great first tee shot that shoots away from the perimeter trails and it is not too difficult. From hole one basket to hole two tee, we will create a defined path (115 feet) with rope going to the trail to the top of the knoll establishing a single trail.
- 2 449 feet (41st): Starting on top of the knoll, this hole slopes into the grassy plain and is the longest of the nine holes. We will create another defined path going down from the 3rd tee.
- 3 250 feet (Low Income Housing, The Development): Slightly aside from the grassy plain, there is out of bounds to the right of the hole to even further discourage players to avoid the perimeter trail.
- 4 238 feet (Soquel High School): Laying on the side of the knoll at a gradual incline, this putt ends at the top of the knoll. As you crest the knoll you have your first view of the Soquel High School campus behind the pin, before the existing trail which leads you out of bounds.
- 5 249 feet (Riparian Corridor): At the bottom of the knoll, this hole slopes into the Eastern corner of the park. We will set up an out of bounds behind the hole, marked with rope, to prevent people from throwing towards the trail and the riparian corridor.
- 6 240 feet (Save Soquel): The hole goes away from the path and we have added out of bounds to ensure discs avoid the perimeter trail. This hole is damp during the winter and will benefit from seasonal closure.
- 7 280 feet (The Pasture): A slightly rising hole in a large open field shooting away from the trail along the base of the slope on the west side of the field.
- 8 150 feet (Anna Jean Cummings): is a short uphill hole that starts in a small oak grove and goes through a open field, ending near the base of the knoll. A sign will direct you to hole 9 and a small trail will need to be created through the coyote brush on the north side of the perimeter trail.
- 9 180 feet (Soquel High Disc Golf Club): Is directly behind the varsity baseball field (right field). To reach the tee pad, you have to walk into an inner meadow past the large coyote bushes. Similar to hole eight in length, it shoots around the curve of the baseball's outfield and ends near the parking lot, completing the loop. Another sign will direct you towards the parking lot.

Average hole length: 242 ft. According to Disc Golf designers, the average hole length of an intermediate/beginner course should be under 250 ft.

*Within the parenthesis () are possible names with historical meaning honoring the preservation of AJC. Later signs could be added telling a history of the park as you play the course.

The Mission of the Santa Cruz County Department of Parks, Open Space and Cultural Services is to provide safe, well-designed and maintained parks, and a wide variety of recreational and cultural opportunities for our diverse community.

We believe the proposed course at AJC not only works with the goals of the recreational master plan, but also the Santa Cruz County Parks mission statement by providing a safe, well designed and maintained course that offers an opportunity for our diverse community to play disc golf!

Proposal for Enhancement to Anna Jean Cummings County Park; Seasonal Nine Hole Recreational Disc Golf Course

RESPONSIBILITIES OF SHSDGC

Construction:

The installation of a 9-hole disc golf course in AJC will involve the construction of tees, the installation of inexpensive yet durable signs and baskets, and minimal clearing of poison oak, coyote brush and dead branches. Under the proper supervision of the Park & Recreation staff, the SHDGC, along with volunteers, will install the equipment in accordance with manufacturer instructions.

Pads:

Each hole will have one tee pad measuring approximately 4' x 8' x 4" and will be made of concrete (**Annex 1**) We have researched a rubber alternative but have found that Concrete is less expensive and safer for the discgolfer.

Baskets:

DGA Mach III Disc Hole basket with a locking collar set in a cement hole measuring approximately 10" in diameter and 28" deep (technical specifications for the installation of tees and baskets can be found in **Annex 2**). All 9 baskets are to be donated by the De Laveaga Disc Golf Club.

Signs:

Club members have discussed with both the wood shop and metal shop teachers to create tee signs, and the information/rules sign that will be placed in the upper parking lot for players to read before they begin the course. The rules and information sign will be constructed using two 4' x 4' wood posts sunk in concrete four feet apart. A board measuring 4' x 4' and 1" thick will then be attached to the posts with the help of new club members, students, volunteers, wood shop, and metal shop.

Each hole will have a tee sign indicating the hole number, length, out of bounds, constructed by sinking a 6 foot long 4' x 4' wood post into a cement hole measuring 18" wide and 24" deep. A 1' x 1' piece of wood 1" thick will then be attached to the post and then an aluminum sign attached to that. The design of the signs will be done in cooperation with the Parks and Recreation Department to ensure consistency with the overall Park "look" and standards.

Paths and Out of Bounds:

Install steps (possibly railroad ties) into the trail on the Eastern Side of the Knoll and install roped pathways where designated. Out of Bounds would be designated by a yellow rope on the ground between short 4x4 posts in the ground much like the Out of Bounds found at Pinto Lake.

Maintenance:

Baskets:

SHDGC will be responsible for pulling the baskets each November, storing them, and replacing them in March. In the unlikely event that one of the baskets is stolen or damaged beyond repair, the Club agrees to repair or replace it.

Signs:

SHDGC will be responsible for maintaining the course signs, ensuring that they remain free of graffiti and replacing them in the event they become damaged due to vandalism or weather.

Proposal for Enhancement to Anna Jean Cummings County Park; Seasonal Nine Hole Recreational Disc Golf Course

Trash:

SHDGC will be responsible for taking care of all trash cans and picking up any trash on the course or nearby. The trash cans will be locked to a foundation with a dead bolt, unlocked with a key, and will be taken out when full. The club will replace them in the event that they are stolen or damaged beyond repair.

We will have a rotating schedule of duties that members of the SHDGC will perform weekly. We have an active recruiting program, which already includes six incoming 8th graders from both Shoreline and New Brighton Middle School, ensuring that we will have a steady flow of members to continue course maintenance under the supervision of the Club Adviser.

Additional Responsibilities:

- 9 temporary baskets can be brought in so that Park staff can have a chance to see what the proposed course would look like.
- Provide a liaison to the Department on maintenance and recreational program issues.
- All physical changes to the facility shall be requested in writing and approved in advance by the Recreation and Parks Department.
- Provide the Department with a quarterly report on the installation, operation and maintenance issues.

RESPONSIBILITIES OF THE PARKS & RECREATION DEPARTMENT

The Parks Department will:

- Designate Department personnel to work with SHDGC in coordinating the approval process for the course layout and development of the course.
- Provide two waste receptacles for the course.
- Provide wood-chips for the club to distribute on the course when necessary.
- Notify the club of any grievances communicated to the department about the appearance or operation of the course.

Proposal for Enhancement to Anna Jean Cummings County Park; Seasonal Nine Hole Recreational Disc Golf Course

ESTIMATED PRELIMINARY BUDGET

Item	Quantity	Unit Cost	Total
Mach III Deluxe Disc Pole Hole	9	\$399.00	\$00.00
Additional Anchor Assemblies	9	\$24.00	\$216.00
Concrete for Installation of Baskets and signs,	9x4=36 (80lb. bags)	\$4.00	\$144.00
Small directional signs	9	\$10.00	\$90.00
Tee Signs (Wood and Metal Shop)	9	\$50.00	\$450.00
Master Locks	9	\$11.00	\$99.00
Rope (3/8" Hollow Braid)	4 (100ft. ea.)	\$12.00	\$48.00
4x4 Pressure Treat Posts	16 (10')	\$17.00	\$272.00
Rules and Information Sign	1	\$100.00	\$100.00
Concrete Tee Pads	9x24=216(80lb. bags)	\$4.00	\$864.00
Forms for pads	Will be donated by local concrete contractor		
<i>(Alternative Rubber tee pads (fly18.com) 90' x5'x 1/2"</i>		\$1260.00	\$1260.00)
Labor for Installation		Volunteers	Volunteers
		Total (Concrete) : Approx.	\$2193.00
		Total (Rubber) : Approx.	\$2589.00

Fundraising completed

-Sold discs for a Team Keen sponsored fundraiser , in which the proceeds were donated to the club

Fundraising to be done if proposal is approved

-Disc Golf Tournament at SLV and Aptos (work together with other schools for common goal)

-Place a donation box at the beginning of the course

-Pizza My Heart, Panda Express fundraisers (30% of proceeds)

-Tee Sponsors (1 year=\$100) (5 year \$350) (Lifetime \$1000) (x9)

-Bake Sales

Proposal for Enhancement to Anna Jean Cummings County Park; Seasonal Nine Hole Recreational Disc Golf Course

Annex 1

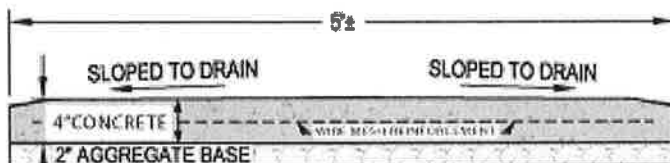
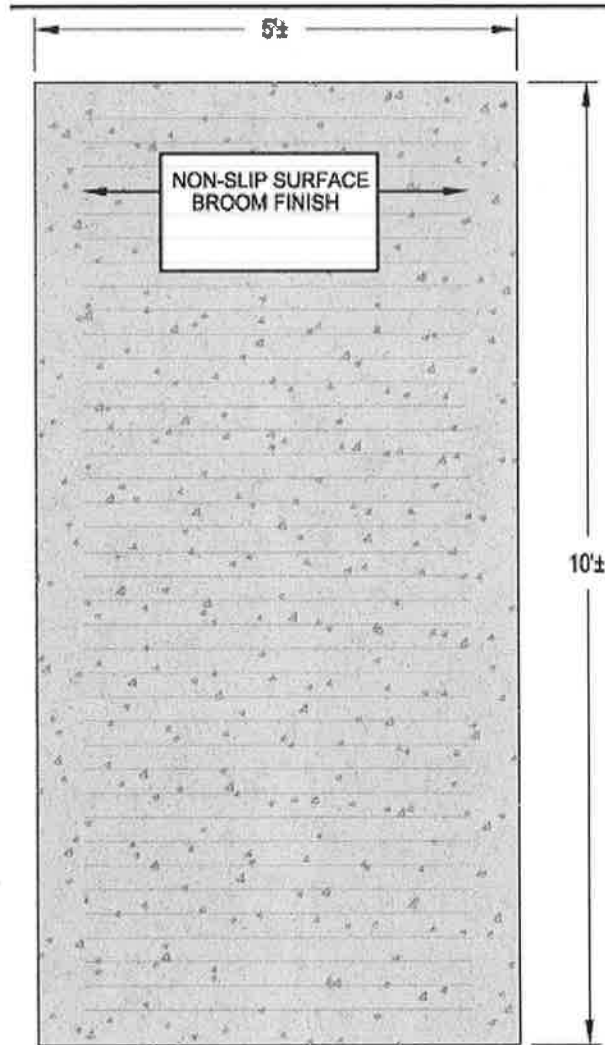
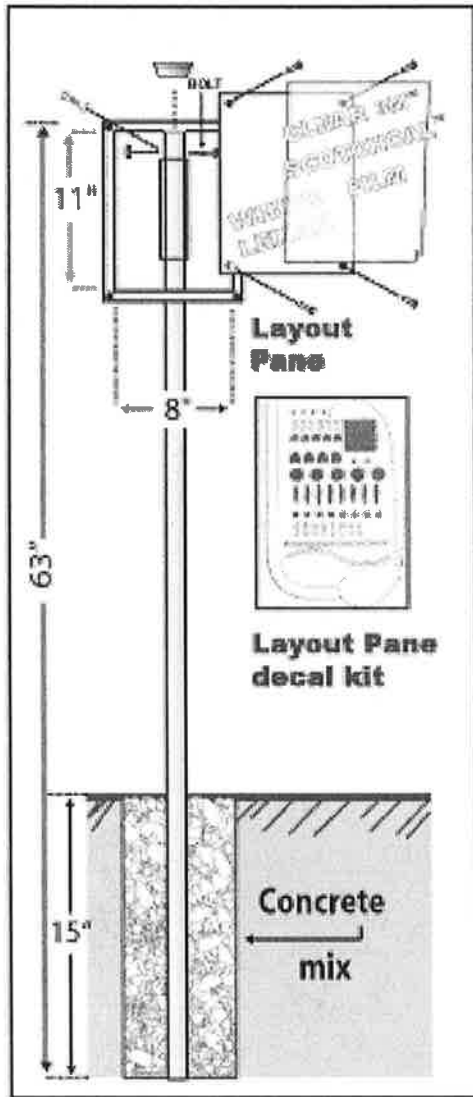

Proposal for Enhancement to Anna Jean Cummings County Park; Seasonal Nine Hole Recreational Disc Golf Course

Annex 2

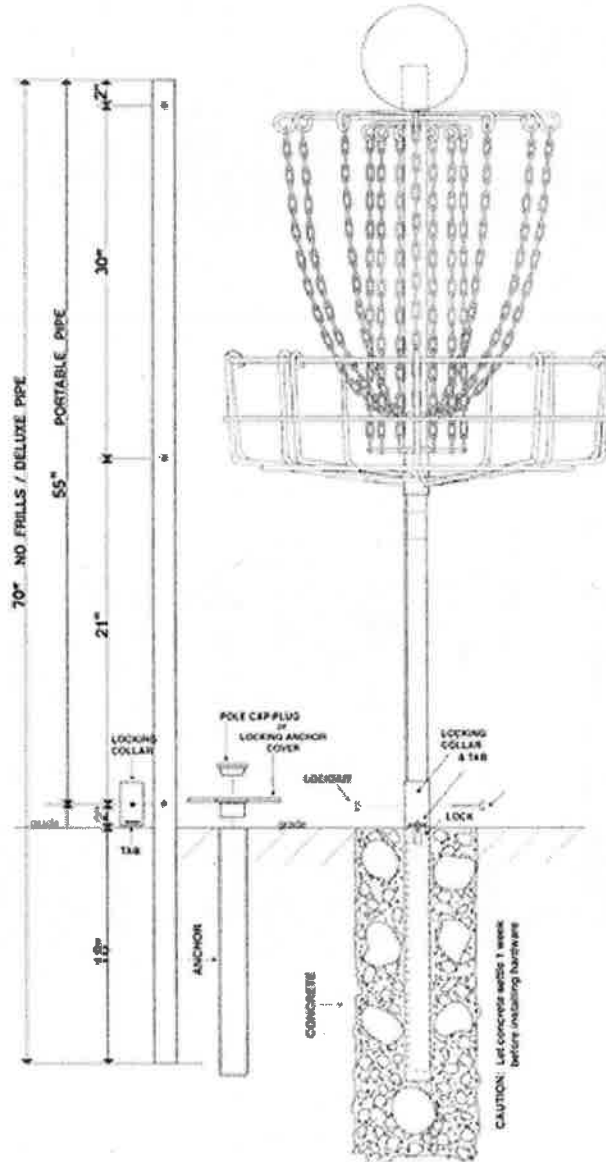

Soquel Disc Golf Course Proposal Works Cited

County of Santa Cruz Redevelopment Agency. *Anna Jean Cummings Park*. County of Santa Cruz Redevelopment Agency. N.p.: n.p., 1998. 10. Print.

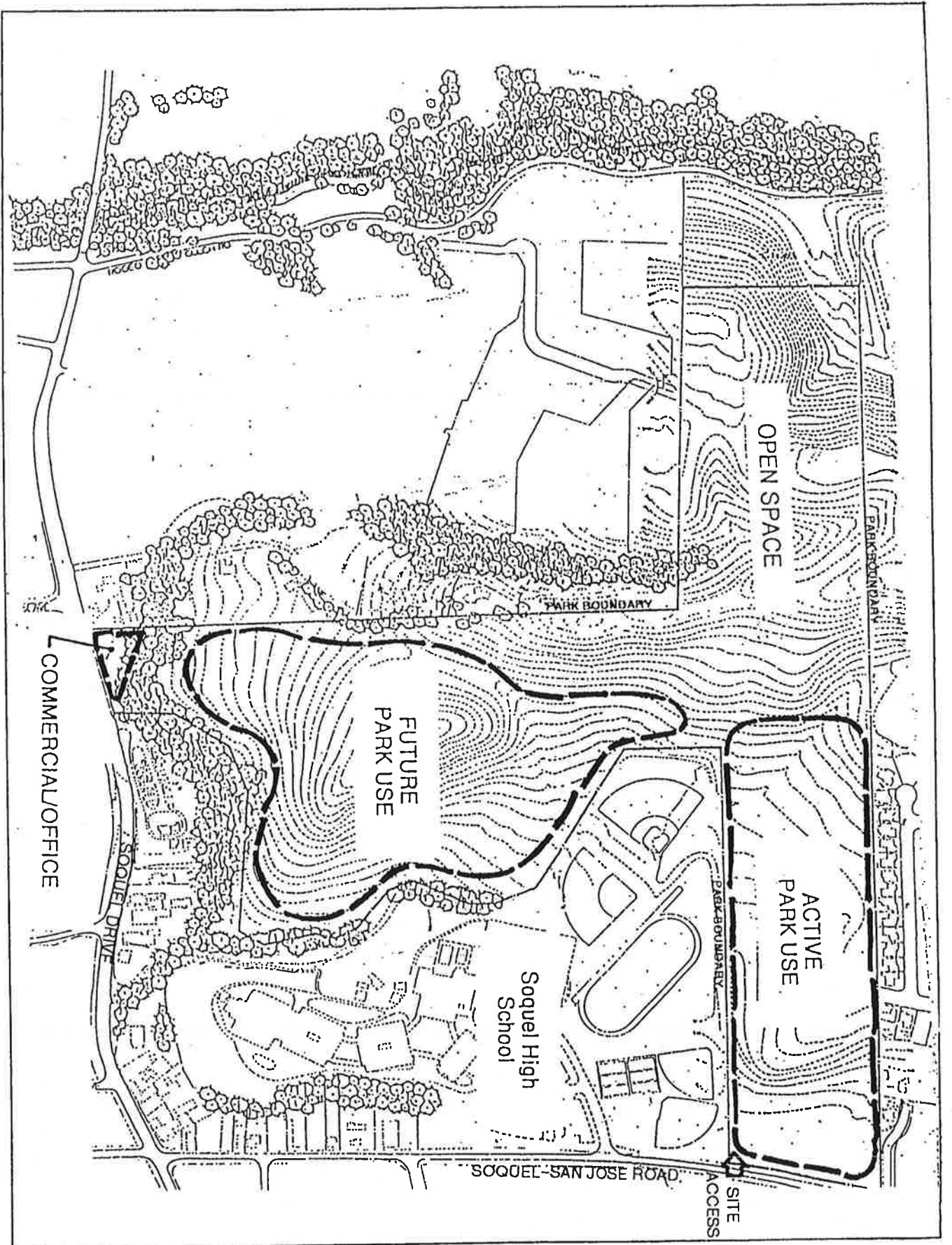

Anna Jean Cummings Park
 Conceptual Land Use Plan

Figure 3

ANNA JEAN CUMMINGS PARK
FEBRUARY 5, 2013, MEETING
COMMENT CARDS SUMMARY

1. I am an 8th grader at new Brighton Middle School. I support the Soquel High Disc Golf Course. I think it is a good idea because I disc golf often with my brother. People who claim that walking or running in the park would be limited by the course, but this is false. I have seen runners, dogs, walkers, and bird watchers at De Laveaga Park. I think this is a good idea.
2. Bad Idea. Can you please leave this beautiful park alone for the enjoyment of the community and neighbors? What is next? A landing strip or helicopter pad? Open space means open space - you don't have to develop just because there is space. Enhance the trails!
3. Disc golf would destroy the environment, a lot of wildlife uses that space and encroaching on their space continues to impact them. Please no golf. Trash, Disc golf = pot smokers
4. I find it hard to respect the scare tactics of the AJC when most of the people who "use" the open space fail to respect it themselves. The amount of off-leash dogs and dog feces is what is ruining the open space.
5. This area is threatened in the future. We need to connect kids to these types of outdoor activities so they have a long-term investment in the area. Please allow for the action to pursue this plan.
6. I am a 20 + resident of Santa Cruz. My daughter is president of the Soquel Disc Club. I think the kids are trying hard to create something beneficial for everyone. They deserve our trust and they deserve to enjoy the park in all its beauty too. Thank you.
7. I walk in the proposed park area on a regular basis and enjoy great peace of mind in such a lovely natural area. It's one of the last public natural spaces in the area. Please leave the park as it is for thousands to enjoy instead of for a few hundred.
8. I live 4 miles up Old San Jose Road. There is no where safe to walk and still be in nature. I love the meadow and the seasonal changes. I walk at Blue Ball Park at least 3 times a week. I also introduce many friends to the beauty of the meadow. It is very different to walk there then around the track especially when the fields are being used for athletic games. I oppose disc golf for this space. Thank you.
9. Concerns: No way to keep golfers out of "shrubs." The stomping of natural grass and compacting of dirt can't be repaired. I just do not see how disc golf can be supported. I would love to see the kids have something positive and positive outdoor interaction instead other. I don't see it happening there.
10. Please consider my experience with trying to hike at Pinto Lake and De Lavaega. It is not peaceful to be in the same environment with disc golfers, no matter how polite they are. Also, very few really control a disc. They always hit trees, get lost, etc. And very concerned with the chewing up of the environment.
11. The disc golf community is full of the nicest, kindest, most giving. They are the type of people that will give half their sandwich or some of their water or just a listening ear or shoulder to cry on even if it's the first time you've met.

12. My name is Bonnie Yost and I come at least once if not twice a week to walk my dog. I enjoy the open space. I'm a beginning birder and I can't see how a disc golf course where it's being proposed will work. It's not good for the wildlife, the other animals and for those walking animals and for those wanting to walk or just enjoy the beauty of the open space. I support these kids and personally have nothing against disc golf. I think we should help them look for a better option than AJC Park. Please leave this open space. I enjoy sports myself, but where do Parks and Rec. and Open Space – where is the open space?
13. I walk my very scared 7 year old border collie mix at AJC Park a few times a week and we just won't feel safe especially with amateurs (but also with adults for other reasons) there anymore. Makes me very SAD!
14. A comment I forgot when speaking: Multi-use is an issue and not just for disc golf. Another dual use area is AJC Soccer fields next to .5 mile track. This happened to me: At an AJC fountain with my dog (on leash) out of no where, I almost fell to the ground - felt like a 2x4 hit the front of my head. A soccer ball hit me in the back of the head. It truly almost knocked me out. No adults/supervising adults present. Kids laughed at first, and then came to over the check on me – polite. Multi-use comes at a cost and if disc golf comes - walkers and nature will be affected.
15. Is "The Farm Park" (near Hardin and Cunninson Lane) feasible as a spot for a 7 to 8 "hole" disc golf spot? It is not too far from Soquel High School especially by foot using the foot bridge near O'Neill Lane
16. I am an eight-grader student at New Brighton. I am also an active disc golfer and love the sport. Having this course would provide another way for exercise for many ages. I am proud to be a future student of a school with such devoted students that stand up for what they believe in. GO SOQUEL HIGH DISC GOLF.
17. I am the parent of a Soquel High Sophomore and a New Brighton 8th grader. I support the disc golf course at AJC. Disc golf is one of the only activities (sports) that someone can participate in that does not cost anything. I have been on many disc golf courses with my kids. We have seen people walking their dogs in the middle of courses. I think there is a way everyone to co-exist.
18. Please do not destroy one of last open spaces in the Mid County! We have a special opportunity to save our open spaces for generations to come.
19. NO. DISC GOLF!!! I'm an 88-year-old woman and a regular park walker with my family. I'm not agile and walk slow. I'm terrified of the possibility of "flying objects"! Please consider the aged and who enjoys the park as it is. Perhaps a few wooden benches along the beautiful trails so us folks to rest on.
20. Disk golf should not be brought to the park. If the students are serious about playing there, are course already available to them? This is the last wild area in Soquel.
21. Please keep the very precious open space for all of us -one day these lovely young kids will appreciate it.

22. I came tonight with no agenda, just to hear both sides. After tonight, however, I am more concerned about the respectful behavior of the walkers than the disc golfers. Also, regarding the danger of projectiles, soccer and softball are already played there, and there is even a track running immediately adjacent to/around the field. Have these projectiles caused a problem?
23. I have worked for the City of Santa Cruz for 20 years. We (the City) have installed disc baskets along Derby Park on the Westside, San Lorenzo Park and help maintain DeLavega Disc course. We have had many positive feedback from people, some who have never played disc golf and love to practice where there is not many people. It's a great sport and a way to get out in the sun. AJC park needs disc golf!
24. I live next door to the AJC park. I walk in the park virtually every day of the year and see firsthand how many people use and enjoy the open space in the park walking, dog-walking, birding and simply communing with the nature in this small oasis of peace and natural beauty. I think the current balance between active and passive uses meets the needs of the community and should not be changed. I'm specifically opposed to using a portion of the open space for disc golf. I believe the presence of heavy flying discs would fundamentally change the peaceful and relaxing experience of walking in the lower area of the park. I'm also concerned about possible damage to the soil and vegetation as has occurred at the Pinto Lake disc golf course. There is a world-class disc golf course 10-minutes away, and many opportunities for students to play organized sports on the high school campus and in the playing fields at AJC. Open space is limited and precious commodity in our every busier and more crowded world, and I believe the open space at AJC should be rigorously preserved for passive uses only.

WRITTEN CORRESPONDENCE LISTING:

The Written Correspondence Listing is established to act as a report of materials received by the Commission as a whole, but may also include items requested for inclusion by individual Commissioners.

The Parks and Recreation Commission has received the following items of correspondence which require no official action by the Commission at this time:

1. Email from JoAnn Gibson, dated February 4, 2013, regarding proposed disc golf at Anna Jean Cummings Park.
2. Email from David Suddjian, dated February 4, 2013, regarding proposed disc golf at Anna Jean Cummings Park.
3. Email from Bob and Bernadette Ramer, dated February 11, 2013, regarding disc golf at Pinto Lake Park.
4. Email from Steve Gerow, dated February 11, 2013, regarding proposed disc golf at Anna Jean Cummings Park.
5. Email from Bernadette Ramer, dated February 11, 2013, regarding disc golf at Pinto Lake Park.
6. Email from Maureen Ryan, dated February 19, 2013, regarding proposed disc golf at Anna Jean Cummings Park.
7. Email from John Hernlund, dated March 1, 2013, regarding disc golf at Pinto Lake Park.
8. Correspondence from Friends of Anna Jean Cummings Park, dated March 5, 2013, regarding proposed disc golf at Anna Jean Cummings Park.
9. Correspondence from Jean Ryan, dated March 11, 2013, regarding off-leash dogs on the beach.
10. Correspondence from Friends of Anna Jean Cummings Park, dated March 21, 2013, regarding proposed disc golf at Pinto Lake Park.
11. Email from Bob and Bernadette Ramer, dated March 28, 2013, regarding disc golf at Pinto Lake Park.
12. Email from Lisa Sheridan, John David, Don Burbulys, Vivian Fenner-Evans, dated April 8, 2013, regarding disc golf at Soquel High Campus.