

BACKGROUND

The County of Santa Cruz plans to begin construction on two projects in early 2025 at the Juvenile Hall Facility at 3650 Graham Hill Road. The Multi-Use Recreation and Program Facility (Gym) will provide a state required all-weather exercise and training facility for Juvenile Hall youth while the Renovation and Upgrades (Renovation) project will provide critical improvements to the aging facility as well as improvements to implement a new Seed-To-Table educational program.

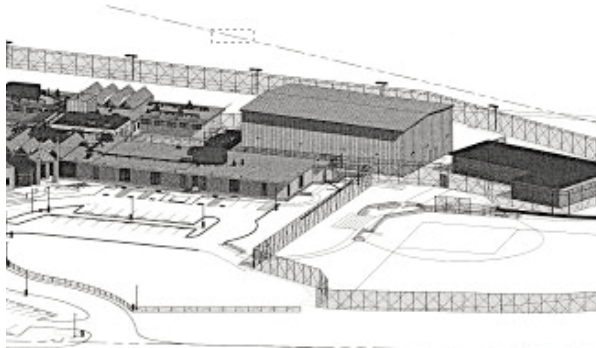

The Renovation includes a teaching garden and greenhouse, as well as a complete kitchen remodel and upgrades to the day use rooms. The Gym will be a pre-fabricated steel building set in the yard of the facility, adjacent to the new teaching garden.

The facility is set in the protected Sand Hills habitat and incorporates habitat mitigation for take of the federally recognized Mt. Hermon June Beetle. This project has been in the making since 2008, after receiving the first round of state SB81 funding. Construction is anticipated to take one year.

APPLICATION PROCESS

All proposals must be submitted via email in one combined PDF not-to-exceed 10 MB. All pages of your application should be presented in the order listed below. Proposals are subject to the Public Records Act and will be provided upon request; identifying information about the artist will be redacted.

Present your materials in the following order:

- A cover page with artist's name, address, phone, and email address.
- A current resume of no more than two typed pages detailing professional artistic accomplishments and at least two references who can speak to your work and qualifications. Teams must submit a short resume for each member.
- Up to ten images of recent relevant work, each annotated with the artist's name, title (if applicable) location of work, medium, date of work, and dimensions. Indicate budget where applicable.
- A written proposal, not to exceed two pages, which addresses the artist's specific approach and design concept for this project, and references installation location(s).
- Visual support, including conceptual drawings which reflect the overall design concept.
- Fabrication and installation Explain your proposed schedule, process, and medium. Describe the anticipated fabrication and installation needs, special equipment or other needs which would require approval.

Email proposals to:

kathy.dewild@santacruzcountyca.gov

Subject Line: Juvenile Hall Art Proposal

CALL TO ARTISTS

Public Art Project



An artist will be selected to create a site-specific public art component for Juvenile Hall in Santa Cruz County

COUNTY OF SANTA CRUZ
Parks, Open Space & Cultural Services
979 17th Avenue
Santa Cruz, CA 95062



PROJECT INFORMATION

Annotated interior and exterior plans and elevations showing desired locations for public art placement, as well as an example of the artist contract which shows required insurance types and limits, are available for review here: <https://www.scparks.com/Home/AboutUs/WorkWithUs/CalltoArtists.aspx>

ELIGIBILITY

The project is open to all experienced professional artists. Artists who are new to the field of public art are encouraged to apply.

The selected artist must provide proof of general liability insurance coverage, and others types if applicable. Please review the contract example on the parks website for details.

BUDGET - \$135,000

The budget amount listed above is the total funds available to the selected artist for design, fabrication, and installation of the proposed artwork.

SELECTION CRITERIA

The proposed site-specific artwork should either enhance the experience of the residents and staff within the Juvenile Hall facility or the families and support persons visiting the facility. Proposals for the exterior may be free-standing in the landscape areas by the facility entrance or teaching garden. Artists may propose murals, sculptural pieces, or other for the interior spaces; suggested locations include the kitchen/dining area, day-use rooms, or the gym.

In addition to being responsive to the setting, artwork must satisfy reasonable standards of permanence and safety, meet all relevant codes required for public places, and offer reasonable proof of soundness against theft, vandalism or excessive maintenance and repair. Artists materials and construction must be of permanent quality.

In making their decision, the Selection Panel will consider the submission of requested materials, artistic merit of concept proposal and sketch, the applicant's professional qualifications; proven ability to undertake projects of a similar scope; and demonstrated ability to work with a team.

Finalists must pass a required background check should they wish to continue in the selection process. This is required as the juvenile hall facility will continue operations while construction and renovations are taking place – background checks are required of anyone, including the construction team, who will be working on site.

ESTIMATED PROJECT TIMELINE

Although every effort will be made to follow the timeline, the schedule is contingent upon meetings with the selection panel and the County Board of Supervisors.

- February 21**
 Proposals must be received by midnight on the due date. Proposals received after the deadline will not be accepted.
- March - Public Art**
 Selection Panel (Panel) meets to review proposals, select finalists.
- April - Panel interviews finalists and selects artist to continue in the process.**
- May 5 - Arts Commission considers panel's recommendation of public artist.**
- June 24 - Board of Supervisors consider artist proposal and agreement.**
- Late 2025-Early 2026 - Installation**

FOR MORE INFORMATION

Please contact Kathy DeWild at the Santa Cruz County Parks Department: kathy.dewild@santacruzcountyca.gov

