



# County of Santa Cruz

## DEPARTMENT OF PUBLIC WORKS PARKS, OPEN SPACE, AND CULTURAL SERVICES DIVISION

979 17<sup>TH</sup> AVENUE, SANTA CRUZ, CA 95062

(831) 454-7901 FAX: (831) 454-7940 TDD: (831) 454-7978

JOHN J. PRESLEIGH  
INTERIM DIRECTOR

### PARKS AND RECREATION COMMISSION AGENDA

---

Monday, May 21, 2012 7:00 p.m. Regular Meeting	Simpkins Family Swim Center 979 17th Avenue Santa Cruz, CA 95062
--	--

---

I. CALL TO ORDER / ROLL CALL

II. AGENDA MODIFICATIONS OR LATE ADDITIONS

III. CONSENT AGENDA

- A. Minutes from March 19, 2012 (Approve) .....Page 1
- B. Information and Reports (Accept and File)
- 1. Maintenance Section – Status Report .....Pages 2-3
  - 2. Facilities Section – Status Report .....Page 4
  - 3. Planning Section – Status Report.....Pages 5-6
  - 4. Recreation Section – Status Report .....Pages 7-12

ORAL COMMUNICATIONS

Opportunity for persons to address the Commission on matters which are within the scope of responsibility of the Commission but not on today's agenda. Presentations must not exceed three (3) minutes in length, and individuals may speak only once during Oral Communications.

IV. DIRECTOR'S REPORT

V. REGULAR AGENDA

A. ACTION ITEMS

- 1. Select Chair and Vice-Chair
- 2. Presentation by Soquel High Disc Golf Club of a Proposal for a Nine Hole Disc Golf Course at Anna Jean Cummings Park and Consideration of Next Steps
- 3. Presentation by Soquel Residents of a Proposal to Preserve Open Space and Dedicate and Enhance Existing Trails at Anna Jean Cummings Park and Consideration of Next Steps
- 4. Review of Proposed 2012-2013 Budget for Parks, Open Space and Cultural Services and Consideration of Recommendations to the Board of Supervisors

B. INFORMATION ITEMS

1. Highlands Park Rubber Tire Mulch
2. Update on the non-profit Supporters & Helper of Arts, Recreation, and Parks (SHARP).

VI. AGENDA/ MEETING FOR: Monday, June 18, 2012, 7:00 p.m.  
Simpkins Family Swim Center  
979 17<sup>th</sup> Avenue, Santa Cruz CA 95062

VII. WRITTEN CORRESPONDENCE LISTING .....Page 56

VIII. ADJOURNMENT



# County of Santa Cruz

## DEPARTMENT OF PUBLIC WORKS PARKS, OPEN SPACE, AND CULTURAL SERVICES DIVISION

979 17<sup>TH</sup> AVENUE, SANTA CRUZ, CA 95062

(831) 454-7901 FAX: (831) 454-7940 TDD: (831) 454-7978

JOHN J. PRESLEIGH  
INTERIM DIRECTOR

### PARKS & RECREATION COMMISSION Minutes of March 19, 2012, 7:00 p.m. meeting 979 17<sup>th</sup> Avenue, Room B Santa Cruz, California

#### I. ROLL CALL

Present: Michael Rosenberg, Katharine Minott, Steven Bennett, Jim Lang, Dave Mercer

Staff: Betsey Lynberg, Bob Olson, Gretchen Iliff

Excused Absence:

Unexcused Absence:

#### II. No modification or late additions to agenda.

#### III. CONSENT AGENDA

A. Approved Minutes from November 14, 2011, and January 23, 2012, meetings.

Motion/Second: Minott/Lang

AYES: 5

NOES: 0

ABSTAIN: 0

ABSENT: 0

B. Approved consent agenda of March 19, 2012.

Motion/Second: Lang/Minott

AYES: 5

NOES: 0

ABSTAIN: 0

ABSENT: 0

#### IV. Director's Report was given.

#### V. REGULAR AGENDA

Motion/Second:

AYES: 5

NOES: 0

ABSTAIN: 0

ABSENT: 0

#### VI. The meeting was adjourned.

# County of Santa Cruz



JOHN J. PRESLEIGH  
INTERIM DIRECTOR

## DEPARTMENT OF PUBLIC WORKS PARKS, OPEN SPACE, AND CULTURAL SERVICES DIVISION

979 17<sup>TH</sup> AVENUE, SANTA CRUZ, CA 95062

(831) 454-7901 FAX: (831) 454-7940 TDD: (831) 454-7978

**DATE:** MARCH 17, 2012

**TO:** PARKS & RECREATION COMMISSION  
ARTS COMMISSION

**FROM:** GRETCHEN ILIFF, MAINTENANCE DIVISION

**SUBJECT:** STATUS REPORT ON CURRENT PROJECTS

### PARKS, BUILDING, AND GROUNDS MAINTENANCE

**NORTH COUNTY PARKS** (Highlands, Ben Lomond, Felton Covered Bridge, Probation, Michael Gray Field, Quail Hollow Ranch and the North Coast)

- ❖ Staff assisted with the Felton Remembers event at the Felton Covered Bridge Parks.
- ❖ A large Oak tree fell and destroyed the group picnic area at Highlands Park. There is still one remaining group picnic area to serve the community. Staff will be adding some additional picnic tables for park users.

**MID-COUNTY PARKS** (Government Center, Emeline Complex, Twin Lakes, Brommer, Felt, Floral, Coffee Lane, Soquel Lyons, Jose Avenue, Winkle Farm, Willowbrook Lane, Moran Lake, Maplethorpe, Santa Cruz Gardens, Mid-County beach access areas)

- ❖ Staff worked in conjunction with the Sheriff's Department to clean Carbonera Creek near the Emeline Complex. The site has been an area of illegal camping and dumping.

Staff spent time this month finding several main line leaks at Anna Jean Cummings Park. A leak detection specialist had to be called in after numerous efforts by staff to isolate all the leaks.

**SOUTH COUNTY PARKS** (Polo Grounds, Valencia Hall, Hidden Beach, Seascape, Aptos Village, South County Beach access areas, Scott Park, Scott Estate, Aldridge Lane, Mesa Village, Pinto Lake, Freedom Government Annex)

- ❖ Staff have begun the seasonal high weed mowing of undeveloped sites. Due to late rains, it will be necessary to mow each site several times for fire control.
- ❖ Staff made some repairs to the Via Palo Alto stairway.

**SIMPKINS FAMILY SWIM CENTER**

- ❖ Staff installed two new, all weather pace clocks this month at the swim center.
- ❖ Staff received First Aid training, Swimming Pool Operator certification and chainsaw safety in the past two months.



# County of Santa Cruz

## DEPARTMENT OF PUBLIC WORKS PARKS, OPEN SPACE, AND CULTURAL SERVICES DIVISION

979 17<sup>TH</sup> AVENUE, SANTA CRUZ, CA 95062

(831) 454-7901 FAX: (831) 454-7940 TDD: (831) 454-7978

JOHN J. PRESLEIGH  
INTERIM DIRECTOR

DATE: May 16, 2012  
TO: Parks & Recreation Commission, Arts Commission  
FROM: Gretchen Iliff, Facilities Management Division  
RE: Status Report on Current Projects

### **Summary for reservations in the parks for the months of March through April 2012, (excluding SFSC):**

#### **Attendance at Reserved Facilities:**

The beginning of spring has been very busy in the area of facility rentals and special event planning. There were picnics, meetings, weddings and athletic field use at all of the rentable locations. Staff estimates that approximately 48,750 park visitors attended events in reserved facilities during the months of March and April 2012, as compared to approximately 2,350 in the previous two months.

#### **Center and Meeting Room Rentals in March and April 2012:**

During this time period there were 11 weddings, receptions and events held at our various park centers, with rental revenues totaling \$5,260. There were 64 meeting room rentals totaling \$1,565.

#### **Picnic Rentals in March and April 2012:**

There were 32 picnics in the reservable picnic areas with rental revenues totaling \$3,550.

#### **Athletic Fields:**

Fields opened in March, and teams have anxiously begun practices and games, despite recent rains. The Facilities section works with approximately 25 youth and adult leagues annually, and rental revenues continue to be an important source of revenue for County Parks. Rental revenues totaled \$31,750 during the months of March and April.

#### **Commemorative Tree, Bench and Picnic Table Program:**

The East Cliff Parkway Project is nearing completion, and Facilities staff, along with project managers, are coordinating the upcoming installation of the benches and picnic tables along the parkway. A total of 15 benches and 7 picnic tables will line the parkway between Pleasure Point Park and the Hook. All benches and most picnic tables have been committed to, and details are currently being finalized. This is a very unique opportunity for families to commemorate their loved ones.

#### **Special Events:**

Our special event season has begun, starting off with the **Santa Cruz Mountain Bike Festival** at the Aptos Bike Park and Aptos Village on April 14th and 15th. Santa Cruz High School sponsored a **High School League Disc Golf Tournament** at Pinto Lake County Park on April 29th. The Big Stick Surfing Association held its annual **Log Jam** on April 28th and 29th, which was coupled with a **paddle out dedication for the World Surfing Reserve**. The month of May brings the new **SLV Chili Cook Off** at Felton Covered Bridge Park on May 20th. The **Felton Remembers**, also at Felton Covered Bridge Park, and the **BluesFest**, at Aptos Park, will both take place Memorial Day weekend. The summer starts off with the **July 4th Celebration**, followed by the **California Beer Festival** on July 28th, both at Aptos Park. The **White Hawk Dancers** hold their annual dance at Pinto Lake County Park on July 14th, and there are three races through Nisene Marks which stage at Aptos Park. In the fall, Aptos Park will host the annual Cancer Benefit Group's **Grazing on the Green** on September 15th, **Reggae in the Redwoods** on September 22nd, and the tentative **Above the Line-Homes for Kids** music festival fundraiser on October 28th. Mark your calendars for another busy season of special events.



# County of Santa Cruz

DEPARTMENT OF PUBLIC WORKS  
PARKS, OPEN SPACE & CULTURAL SERVICES DIVISION  
979 17<sup>TH</sup> AVENUE, SANTA CRUZ, CA 95062

(831) 454-7901 FAX: (831) 454-7940 TDD: (831) 454-7978

JOHN PRESLEIGH  
INTERIM DIRECTOR

**DATE:** MAY 16, 2012  
**TO:** PARKS AND RECREATION COMMISSION, ARTS COMMISSION  
**FROM:** BOB OLSON, PARK PLANNER  
**SUBJECT:** PARK PLANNING DIVISION STATUS REPORT

## **BERT SCOTT ESTATE ROOF REPLACEMENT**

Staff received three responses to the Request for Qualifications to prepare plans and specifications for removing and replacing the roof at the Bert Scott Estate. The evaluation of the three firm's qualifications resulted in the selection of Wald Ruhnke & Dost as the most qualified firm to perform the design work, and a purchase order is being prepared. It is the intent of staff to have the roof replacement project designed and constructed before the next rainy season begins.

## **FELT STREET PARK**

The Contractor has completed all but a few punch list items generated by the preliminary final inspections. They include installation of the permanent park name sign, bocce ball scoreboards and minor reshaping of a drainage swale flow line as requested by Public Works Drainage. Staff is currently working with the Contractor on the final cost of the project and close-out documents.

## **THE FARM PARK**

Parks Maintenance staff has installed two disc golf practice baskets included in the Park Master Plan on the site to establish an interim use for the park site. Staff is also finalizing the contract with the State for a Proposition 84 Urban Greening Grant for riparian restoration and community Garden portions of the Farm Park.

## **FELTON COVERED BRIDGE ROOF RESTORATION**

As part of the preliminary Environmental Study, Caltrans is requesting the specific methodology that will be used to remove and replace the roof over the bridge. Staff has consulted a roofing specialist to assist with the methodology and is compiling this information for Caltrans to review. The results of the Preliminary Environmental Study will indicate if any special environmental documents will need to be prepared to proceed with the project.

### **MCGREGOR PARK SITE**

Parks staff has been informed by State Parks that we were not selected as a grant recipient in the highly competitive Proposition 84 Urban Greening Grant Program application. Parks staff is developing a Request for Qualifications for the selection of a design consultant to shepherd the project through the Development Permit, Master Site Plan approval phase of the project with the existing funding proposed in the Capital Improvement Program for FY 2012-13. Parks staff is currently coordinating with Public Works on a joint meeting with the Seacliff Improvement Association to request feedback on park priorities that could be implemented with the available funding.

### **EAST CLIFF PARKWAY PROJECT**

Construction is continuing on the East Cliff Parkway Project with the underground, Phases I, II and III bike paths installed. The Contractor has begun work on grinding and removing the asphalt in preparation of the road subgrade. Minor concrete for trash enclosures, signage and other footings has been completed. The Pleasure Point Park restroom is under construction with the underground, masonry, stone plinth, shotcrete, stucco and roof sheathing complete. The park terraces have also been completed. The landscape subcontractor is continuing work on the irrigation system in preparation for the plant material. County Public Works construction inspection staff is managing the project with assistance from Parks staff.

### **PROPOSITION 40 UNALLOCATED FUNDING**

In July 2011, Parks received notification that the enacted State Budget provided additional time for Proposition 40 grant recipients to complete their projects under the Per Capita and RZH Block Contracts. To date, Parks has utilized all but \$131,119 of the original grant amounts. Parks staff has submitted three new grant applications to the State. The projects include: additional picnic tables at Ben Lomond Park; new poured in place surfacing and tot structure at Willowbrook Park; and a new group picnic area and shelter at Pinto Lake Park. New Contracts with the State have been signed by the County. Parks staff will proceed with the projects as soon as copies of the fully executed contracts from the State are returned.

### **SIMPKINS FAMILY SWIM CENTER VARIABLE FREQUENCY DRIVE (VFD)**

Parks staff is currently working with the Contractor on the approval of construction submittals. There has been a delay in the submittal approval process due to insufficient data provided by the Contractor to the satisfaction of Design Engineer. It appears we are getting closer to a submittal package that the County would agree on. Parks is currently waiting for the new submittal package. The project will include a variable frequency drive control system for the 50-meter pool recirculation pump and the recreation pool recirculation pump. Once installed, the VFD system will help off-set energy costs to operate the pool pumps.





# County of Santa Cruz

## PARKS, OPEN SPACE & CULTURAL SERVICES

979 17TH AVENUE, SANTA CRUZ, CA 95062

(831) 454-7901 FAX: (831) 454-7940 TDD: (831) 454-7978

JOHN PRESLEIGH  
INTERIM DIRECTOR

DATE: May 14, 2012  
TO: Arts Commission, Parks and Recreation Commission  
FROM: Kathy DeWild, Program Coordinator  
RE: Recreation and Cultural Services Division Status Report – April through June, 2012

### AQUATIC PROGRAMS

**Spring Schedule starts March 10, 2012 and runs through June 16, 2012**

**The spring pool schedule is as follows:**

**Lap Swimming** - The lap pool is open Tuesdays and Thursdays from 6:00 a.m. to 7:30 p.m., Wednesdays and Fridays from 6:00 a.m. to 7:30 a.m. and 11:30 a.m. to 7:30 p.m. (closed 7:30 a.m. to 11:30 a.m.) Saturdays it is open from 9:00 a.m. to 3:00 p.m. It was closed on Sundays until April 15, 2012.

**Warm-water Pool** - The warm-water pool is available for general use on:

Tuesday and Thursday	6:00 a.m. to 5:00 p.m. (Shared w/swim lessons 10:30a.m.-12:30 p.m. & again open from 6:00 a.m. to 7:30 p.m.)
Wednesdays	6:00 a.m. to 7:30 a.m. 6:00 p.m. to 7:30 p.m.
Fridays	6:00 a.m. to 7:30 a.m. 3:00 p.m. to 7:30 p.m.
Saturday	9:00 a.m. to 10:30 p.m. (adults only) 10:30 a.m. to 12:30 p.m. (adults & kids 6 years and younger) 12:30 p.m. to 3:00 p.m. (all ages)

**Recreation Swim** – This includes the Warm Water Pool and the 1<sup>st</sup> lane of the 50M pool

Tuesday through Friday 3:00 p.m. to 5:00 p.m.

Saturday 12:30 p.m. to 3:00 p.m.

**Swim Lessons** – Spring Swim lessons held on Tuesday and Thursday mornings from 10:30 a.m. to 12:30 p.m., and Tuesday, Wednesday, Thursday evenings from 5:00 a.m. to 7:00 p.m., are full. Summer lessons begin June 26.

**Adult Fitness Swimming** - Adult Fitness Swimming is very popular at the Simpkins Family Swim Center. The best-attended workouts are Tuesday and Saturday mornings; up to 49 swimmers fill the 50-meter pool at these times. Fitness swimmers may choose from several different workout times: Tuesday through Thursday workouts are at 6:00 a.m., 12:00 p.m. and 6:00 p.m.; Friday workouts are offered at 6:00 a.m. and 12:00 p.m.; Saturday workouts are offered at 9:00 a.m.

**Water Aerobics & Exercise** - The water exercise classes this year have reached their highest capacity to date. Water exercise is an excellent way for people to meet their fitness goals without impact on the joints. Classes are designed to appeal to all levels of ability including, healthy, pre-natal, seniors, and rehabilitating or cross training fitness enthusiasts. A monthly calendar is available with dates, times and instructor's names. Previous swimming or water-exercise experience is not required for participation in any of the water exercise classes.

**Water Polo** - Drop-in water polo is offered Saturdays from 10:30 a.m. to 12:30 p.m. One must be a member of USAWPA to participate in the program.

**Pool Rentals** - The Santa Cruz County Aquatics and the Cabrillo Threshers swim teams continue to rent lanes in the 50-meter pool. The swim teams offer school-age competitive swimming programs Monday through Friday from 4:00 p.m. to 6:30 p.m.

**Private Pool Parties** – Private Pool Parties are available on Saturdays starting March 10, 2012, and on both Saturdays and Sundays starting April 15, 2012. A variety of aspects of the facility may be rented for Private Pool Parties, from just the warm pool to aspects accommodating up to 110 people. Private Pool Parties are scheduled on weekends, spring, summer and fall, after the facility has closed to the public.

## ARTS AND CULTURAL

### Public Art Projects

The Board of Supervisors approved Andy Dufford as the artist for the Behavioral Health Unit public art project at their March 6 meeting, and work has begun on the project. Mr. Dufford's project, "Continuum," consists of three integrated stone elements. The first two – a totem with accompanying seating – will sit in the landscaped area adjacent to the front door. The third element is a carved interior relief panel that echoes the forms of the totem, and would be equally appropriate for the lobby, conference room or the patient area. Carvings on the totem and panel abstract the unfolding of plant forms and wave patterns. Nighttime lighting adds another layer of beauty and interest to the exterior elements.

A Call to Artists has gone out for the Outside the Box Program, with proposals due from artists on July 20. Ten traffic controller boxes, located throughout the county, will be painted by local artists.

Selection panels will be convened by the Arts Commission to select artists for the Hidden Beach Pump Station and Heart of Soquel public art projects.

### **Art Exhibitions**

Four Artists have been selected to exhibit their work at the Simpkins Family Swim Center for 2012 and early 2013. Erika Perloff's pastel paintings will be up through the end of May. Sandra Cherk will show her pastel landscapes from June to August. Oil paintings by Erika Gakovich will be exhibited September through November. The final exhibition will feature acrylic paintings of Santa Cruz locales by Laurie Longenecker from December 2012 through February 2013.

### **Artist of the Year**

Gary Young has been named the 2012 Artist of the Year by the Santa Cruz County Arts Commission. Gary, a nationally-recognized poet, is the County's 26th artist to be so honored. As a poet, printer, visual artist and educator, Gary has contributed extensively to the cultural life of Santa Cruz County. The high level of artistic production in Santa Cruz County is acknowledged through the Artist of the Year Award. Recipients must live in Santa Cruz County and have a national and/or international reputation, as well as having contributed to the cultural enrichment of the local community. Gary will give a "Profile Performance" on Friday, May 25 at 7:00 p.m. at the Museum of Art & History, 705 Front Street, Santa Cruz. The evening will celebrate the convergence of literary and visual arts. Enjoy a discussion and demonstration of poetry, typography and letter press printing. Admission is FREE to the public. Advance tickets are not available. Seating is limited and available on a first-come, first-served basis the night of the event.

## **QUAIL HOLLOW RANCH INTERPRETIVE PROGRAMS**

### **Recent interpretive programs:**

1. A *Broom Bash* was scheduled for Saturday, April 7, from 10:00 a.m. to 1:00 p.m. with Chuck Baughman and Linda Brodman as we begin to wind down the broom season. A total of seven people helped pull several sites.
2. Another *Broom Bash* took place on Saturday, April 21, from 10:00 a.m. to 1:00 p.m. Chuck Baughman with Linda Brodman led seven hearty volunteers to clean up broom sites in the park in an effort to halt the blooming/seed production cycle. Temperatures were up in the high 70s.
3. Park visitors wanting to learn about bats came to Quail Hollow on Sunday, April 22 from 2:00 p.m. to 3:30 p.m. and joined Monique Lee as she shares her abundant knowledge in her program: *Bats: Gentle Masters of the Night*.
4. A final *Broom Bash* took place on Saturday, April 28 from 10:00 a.m. to 1:00 p.m. with six hearty French broom weeders joining – all of them regulars to the program.
5. Renee Shepherd, from Renee's Garden, visited Quail Hollow to offer a program entitled *Great Gardens from Seed for Busy People* on Sunday, April 29 from 1:00 p.m. to 3:00 p.m. A total of 11 gardeners joined the program.
6. *Bird Houses for Mom* was a new program offered by Parks docent Simon Stapleton on Sunday, May 6 from 10:00 a.m. to 12:00 p.m. A total of nine kids and dads made their own bird boxes, potted flowers and Mother's Day cards as gifts for their mothers.

7. Paul Haskins was back for another *In Search of Herps* program on Sunday, May 6 from 1:00 p.m. to 3:00 p.m. Six participants had a chance to participate in a presence/absence survey identifying many of the reptiles and amphibians in the park.
8. On Sunday, May 13 from 1:00 p.m. to 3:00 p.m. Lee Summers, Park interpreter, led visitors in preparing, cooking and eating acorns in the Ohlone tradition in her program Acorn Preparation the Ohlone Way.

A nine-year-old celebrated his birthday at Quail Hollow on Sunday, April 1 from 2:00 p.m. to 4:00 p.m. with a *Running with the Wildcats* party. Lee Summers led eight kids (with 10 adult on-lookers) along trails playing a variety of predator – prey games. A *Pioneer* birthday took place on Saturday, April 14 from 1:00 p.m. to 3:00 p.m. Lee Summers, along with Aly Benton, led 15 children in a series of old fashioned games. Eleven adults looked on from a safe distance.

St. Andrews Preschool was out for their annual bug hunt field trip on Friday, April 13 from 10:00 a.m. to 11:30 a.m. A total of 14 kids, along with parent chaperones, attended the program.

This year's volunteer of the year award ceremony was on Tuesday, April 17 at 10:00 a.m. in the Board of Supervisors chambers. The Quail Hollow recipient is Tim Jolly who has spent six years and over 400 hours working on broom removal, bird surveys, outreach programs, trail roving, research and most recently has been helping Al Keuter with Sunset trail maintenance and extension development.

Staff met with Conrad Jones, from the Department of Fish and Game (F&G), to hike the prospective Sunset trail extension which will go on and off F&G property. Volunteer Al Keuter, who was also invited, provided maps and background on trail building. The decision to grant permission was postponed for a few weeks to "mull it over." If approved, signage would be required identifying to hikers when they were entering and leaving F&G property, in addition to signage required by County Planning. A visit to the sandhills also took place which gave staff a chance to point out a very healthy Santa Cruz wallflower population for this year.

Lee Summers, along with volunteers Sean Warton and Maggie Hooper, have been caging the endangered Santa Cruz wallflowers in order to keep deer from grazing on the flowers. There are so many flowers this year that we have run out of cages necessitating the purchase of more chicken wire. The increased number of wallflowers this year may be due to the very wet year last year and the fact that these flowers have a two-year life cycle – growing a basal rosette of leaves the first year followed by a blossom the second year. Sean Warton pooled \$40 in donations from himself and his neighbors to purchase chicken wire and also donated bamboo steaks for securing the cages.

Sempervirens Outdoor School staff visited Quail Hollow for a staff-training about the sandhills on Friday, April 20 from 2:00 p.m. to 4:30 p.m. Lee Summers led seven educators to the east ridge.

Eagle Scout, Nathan Wahler, had his Court of Honor at Quail Hollow on Sunday, May 6 from 5:00 p.m. to 7:00 p.m. A total of 60 family, friends and scouts attended the event. Nathan completed his Eagle project at the ranch when he built two picnic tables and reconstructed the middle look out point along the Sunset trail. He also added a vista point bench. We are grateful to Nathan for all his work on this project.

Interviews for first-time Day Camp Volunteers took place on Saturday, May 5. Three new, 12-year-old volunteers will assist staff at Time Travelers and Science Sleuths Day Camps this year: Savannah Zachau, Shelby Slaughter, and Madi Ahrens.

The Monterey Bay Master Gardeners have been working on weeding the gardens in preparation for the busy spring and summer. Several new volunteers have joined the ranks and have attended several work parties.

A series of non-public Broom Bashes have taken place over the past few weeks in order to supplement the public work parties. Unusual growing conditions and an early blooming season has led to many maintenance sites in need of care. Chuck Baughman and Linda Brodman along with others have revisited the park to address this need.

### **Upcoming interpretive programs:**

1. Local naturalist extraordinaire, Randy Morgan, rescheduled his Quail Hollow Sandhills trek from Sunday, May 6 to Sunday, May 27 from 12:00 p.m. to 4:00 p.m. He will lead 15 visitors to the sandhills.
2. Visitors will have a chance to learn all about the Wild World of Frogs with Kerry Kriger on Sunday, May 20 from 1:00 p.m. to 3:00 p.m.
3. The UCSC Women's Club has scheduled a field trip to Quail Hollow on Thursday, May 24 from 10:00 a.m. to 1:00 p.m. for a house tour with Lee Summers and a cooking class with Phyllis Endicott.
4. The Astronomy Club will return for another Star and Moon Gazing session on Friday, May 25 from 7:30 p.m. to midnight. Views of Mars and Saturn will highlight the evening (weather permitting).
5. A Composting program with Master Gardener, Otis Johnson, will take place on Sunday, May 27 from 10:00 a.m. to 12:00 p.m. Visitors will have a chance to learn about the principles of composting kitchen and yard waste.
6. Master Gardener Angus Mills, will come to Quail Hollow on Sunday, May 27 from 12:30 p.m. to 2:30 p.m. to teach Vermaculture and Compost Tea.
1. A Beginning Birding walk with Eirc Feuss will be offered on Sunday, June 3 from 8:00 a.m. to 10:00 a.m.
2. The Fly Fishing Club of Santa Cruz will offer their annual Introduction to Fly Fishing on Sunday, June 3 from 10:00 a.m. to 4:00 p.m.
7. A final In Search of Herps walk with Paul Haskins will take place on Sunday, June 3 from 1:00 p.m. to 3:00 p.m. This hike will be the last of the season and commence again in December.

The Quail Hollow Ranch facility will be rented out for weddings and other events on all but the first Sunday of each month, as well as all Saturdays, June through August. Programming will continue on the first Sunday of the month, as well as two summer camps (Time Travelers and Science Sleuths) which will operate Monday through Friday for two 2-week sessions.

## **ADULT AND SENIOR PROGRAMS**

**Senior Trips** – Recent well-attended trips included the “Beach Blanket Babylon” in February, Golden Gate Fields in March, and Cirque du Soleil in April. Upcoming trips, a San Francisco Giants Game in June and a Delta Discovery Cruise in July, are both full with waiting lists. Staff have planned some exciting new destinations for 2012 and 2013, including Yosemite National Park / Chukchansi Resort, Cantor Arts Center in Palo Alto, the Napa Valley Wine Train, and Golden Gate Park.

**Capitola Mall Walk Program** – Over 40 people are enrolled and active in the Mall Walk Program. The stretch class is Monday, Wednesday and Friday and averages 20 to 30 participants each day. The Birthday celebration is held on the third Monday of the month. Free Blood Pressure checks are held on the third Wednesday of the month.



JOHN J. PRESLEIGH  
INTERIM DIRECTOR

# County of Santa Cruz

## DEPARTMENT OF PUBLIC WORKS PARKS, OPEN SPACE, AND CULTURAL SERVICES DIVISION

979 17<sup>TH</sup> AVENUE, SANTA CRUZ, CA 95062  
(831) 454-7901 FAX: (831) 454-7940 TDD: (831) 454-7978

**AGENDA: MAY 21, 2012**

May 16, 2012

**SUBJECT: PROPOSALS FOR ANNA JEAN CUMMINGS PARK**

Members of the Parks and Recreation Commission:

The Soquel Disc Golf Club, a student club at Soquel High School, has requested time on this agenda to present their proposal for a nine-hole disc golf course at Anna Jean Cummings Park. Soquel residents have also requested time on this agenda to present their proposal for preservation of open space and dedication and enhancement of existing trails at Anna Jean Cummings (AJC) Park.

A report to the Commission on the March 19, 2012, agenda included a copy of the Recreational Master Plan for AJC Park and described in general terms a process for considering new proposals for AJC Park. Also on that agenda was a proposal from the Friends of AJC Park to Preserve Open Space and Dedicate and Enhance Existing Trails at AJC. These items are attached for your information. Staff has received the attached proposal from the Soquel High Disc Golf Club for Enhancement to AJC Park, Seasonal Nine Hole Recreational Disc Golf Course.

Given the level of community interest in the future of AJC Park, a community meeting or workshop is warranted. A community meeting or workshop would allow the Soquel community to identify common goals and work together on a plan to provide a safe, well designed and maintained park that addresses recreational opportunities for our diverse community.

A significant amount of volunteer effort has been put into the preparation and presentation of each proposal, and each proposal warrants further evaluation and analysis in preparation for a community meeting. In the interest of moving forward in a timely manner and given the current Parks staff workload, staff would recommend that Soquel Park Dedication funds be allocated in the proposed fiscal year 2012/13 Budget to hire a consultant to assist with an initial evaluation and preparation for a community meeting or workshop.

It is therefore recommended that the Parks and Recreation Commission take the following actions:

1. Consider each proposal in the order given on the agenda.
2. Take public comment.

3. Recommend to the Board of Supervisors that funds be allocated in the proposed fiscal year 2012/13 Parks Budget to hire a consultant for further evaluation and analysis of each proposal for the Anna Jean Cummings Parks.
4. Direct staff to schedule an initial community meeting/workshop for fall 2012 and to report back to the Commission on the results of that meeting/workshop.

Yours truly,  
JOHN J. PRESLEIGH  
Director of Public Works

By:

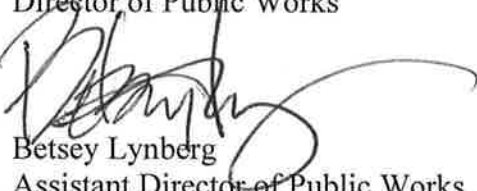
  
Betsey Lynberg  
Assistant Director of Public Works  
Parks, Open Space and Cultural Services Division

BAL:mh

Attachment





JOHN J. PRESLEIGH  
INTERIM DIRECTOR

# County of Santa Cruz

## DEPARTMENT OF PUBLIC WORKS PARKS, OPEN SPACE, AND CULTURAL SERVICES DIVISION

979 17<sup>TH</sup> AVENUE, SANTA CRUZ, CA 95062  
(831) 454-7901 FAX: (831) 454-7940 TDD: (831) 454-7978

March 13, 2012

SUBJECT: PROCESS TO ADD DISC GOLF AT ANNA JEAN CUMMINGS PARK

Members of the Parks and Recreation Commission:

As you will recall, a group of students and supporters for the installation of a disc golf course at Anna Jean Cummings Park addressed your Commission during Oral Communications at the November 14, 2011, and January 23, 2012, Commission meetings. As of the date of this letter, staff has not received a proposed course layout from this group. Commissioner Lang previously requested that staff return with a process for adding disc golf at the park. Additionally, staff has received a written request to post directional and informational signage along existing trails in the park (Attachment 1). The purpose of this report is to respond to Commissioner Lang's request to outline steps that may need to be taken to add recreational elements not included in the original master plan.

There is a long history of proposals, community input, environmental review, and permits related to the development of Anna Jean Cummings Park. It is not the intent of this report to document that long history but instead to share the process for review and approval of the original park improvements and outline a likely process for review and approval of new park features.

It is important to distinguish the process of developing a Park Master Plan from the permit review and approval process. The County Redevelopment Agency worked in conjunction with the Parks Department to prepare a Park Master Plan for the development of Anna Jean Cummings Park. In 1998, after a series of community meetings and a hearing before the Parks and Recreation Commission, the Board of Supervisors approved the Park Master Plan. The Anna Jean Cummings Park Recreational Master Plan is included as Attachment 2. That plan identifies areas to be developed for recreational uses, areas to be preserved as open space, and an area reserved for "future park uses."

Based upon that plan, proposed improvement plans and reports necessary for development permits and review under the California Environmental Quality Act (CEQA) were finalized. Those documents were submitted to the County Planning Department. Then in March 2000, after a public hearing, the Planning Commission approved a Master Plan Development Permit for the development of recreational uses at Anna Jean Cummings Park.

Typically the addition of new recreational uses at an existing County park includes consideration of a proposal or project at public meetings of the Parks and Recreation Commission and the Board of Supervisors. Then, once the project has been defined, a determination is made by the Planning Department as to the level of review required to amend existing permits. Parks staff has consulted with the Planning Director, who has responded that expanded use at the park would likely trigger the need to amend the Master Plan Development Permit. The level of review (administrative, Zoning Administrator, Planning Commission) would be determined by Planning Department staff after review of the specifics of the proposed expanded use. Any impacts of the proposed expanded use would also be evaluated per California Environmental Quality Act requirements. Depending upon the impacts of the specific elements of the proposal, if any, mitigation measures would be identified.

Yours truly,

JOHN J. PRESLEIGH  
Interim Director

By:

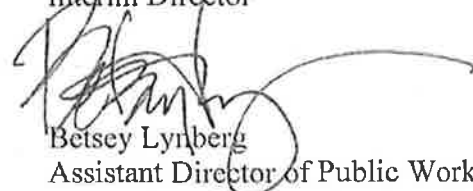

Betsey Lynberg  
Assistant Director of Public Works  
Parks, Open Space and Cultural Services

BAL:mh

Attachments

---

# Anna Jean Cummings Park County of Santa Cruz

## Draft Recreational Master Plan

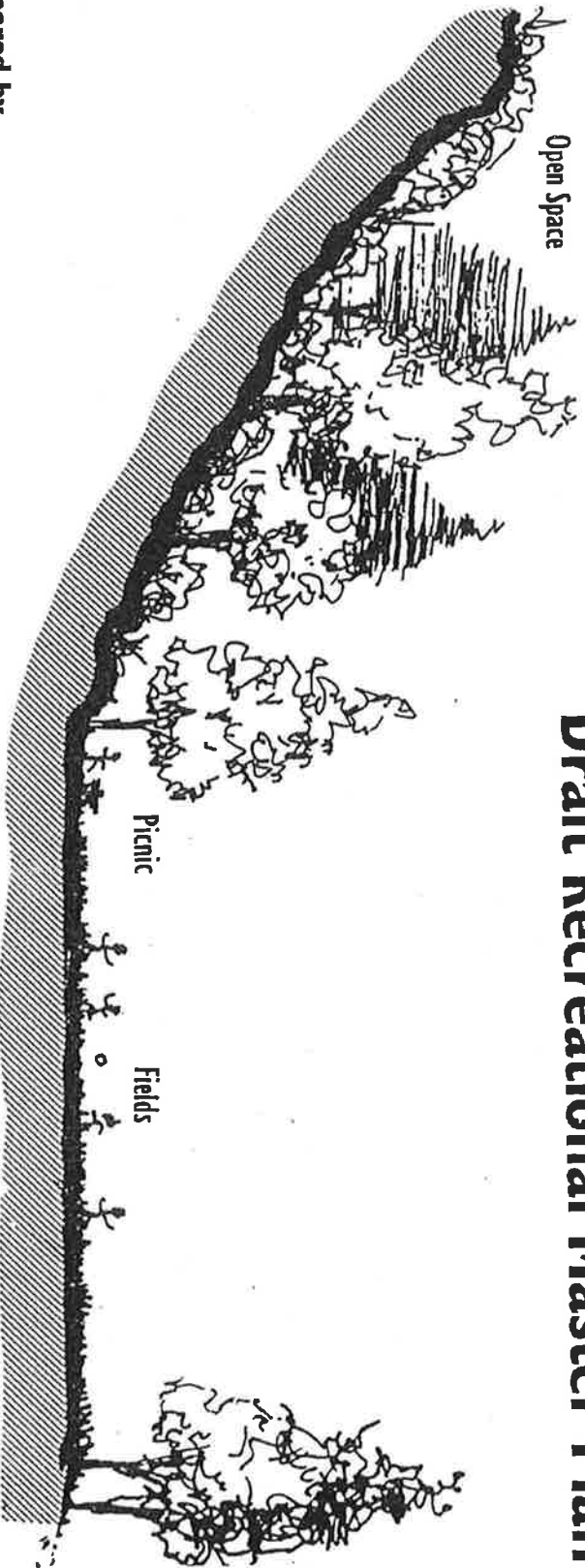

Prepared by  
County of Santa Cruz Redevelopment Agency

May 1998

---

## Introduction

The O'Neill Ranch property, now known as Anna Jean Cummings Park, was originally purchased by the Redevelopment Agency in 1989. Since that time, there has been an on-going dialog with the community about protection of the property and the design of the improvements. In 1996 the Board of Directors of the Redevelopment Agency approved an Environmental Impact Report as well as a Conceptual Plan for the property. With the approval of the concept plan attention was then focused on planning a portion of the property known as the upper and lower benches for active recreational uses. The purpose of this master plan report is to review the conceptual land use planning efforts that became the basis for the park master plan and to present the park master plan, setting the stage for the construction of major new recreational facilities serving Soquel and the mid-county area.

## Background & Setting

The Anna Jean Cummings Park property is a 96.5 acre, "T" shaped property, located about one quarter mile north of Soquel Village (see figure 1 - Setting and Context). The property is vacant, and is characterized by a series of terraces, vegetated by grasses and shrubs. Riparian corridors with willow oak and eucalyptus trees, as well as riparian under story vegetation are in the southern, eastern and northeastern portions of the property.

Historically the property was used for grazing dairy cattle as a part of a large ranch which once also encompassed the Soquel Highlands neighborhood. There is no evidence that any structures were ever built on the site. For years the property has been used informally by hikers and enjoyed by the community as a visual reminder of Soquel's rural past.

The property includes more than 200 feet of frontage along Soquel-San Jose Road. An existing unpaved access from Soquel -San Jose Road travels along the property line with Soquel High School and provides access to the upper areas of the property. One private road (Greenbrae Lane) and several public roads (Valera Drive and Dawn Lane) parallel or dead-end at the property line. Many informal pathways are also found on the property.

The Anna Jean Cummings Park property has been designated for both community and neighborhood park use for a number of years. The property is adjacent to Soquel High School to the east and the currently undeveloped Tan property to the northwest. Residential uses surround the remainder of the property, with a larger lot, semi-rural neighborhood to the west (Greenbrae Lane), and suburban subdivisions to the north and northeast (Soquel Highlands, Dawn Lane and Paper Mill). To the south, a mobile home park borders the property across a broad riparian corridor. Various small businesses and vacant commercially zoned properties are located to the southwest of the property.



**Anna Jean Cummings Park  
Setting And Context**

**Figure 1**

## Topography

The site can be described by a series of topographic features, several of which are visible from some distance. A series of benches characterizes the northeast leg of the "T." The lower bench (immediately adjacent to Soquel-San Jose Road) is level, approximately 4 acres, and vegetated with scrub bushes and nonnative grasses. The lower bench is separated from the upper bench by a high, steep slope.

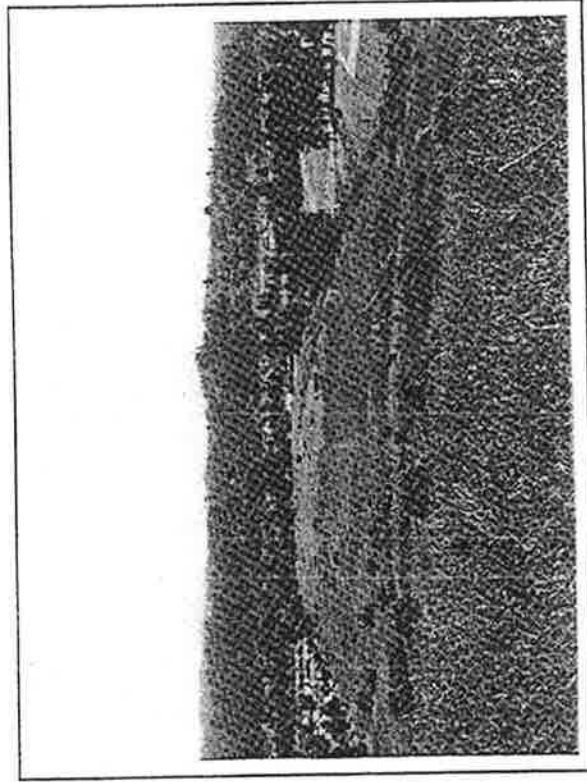

**A view looking east from the upper slopes of the Anna Jean Cummings Park property, down across the upper bench.**

The natural contours of the slope were altered by the placement of fill which was generated some time ago, possibly when Soquel High School or Soquel-San Jose Road were constructed.

The upper bench is a large, approximately 18 acre, nearly level area. Beyond a rolling hillside (created by an ancient, dormant landslide) is yet another terrace, the uppermost portion of the property. Portions of this series of terraces and slopes are visible from Soquel-San Jose Road.

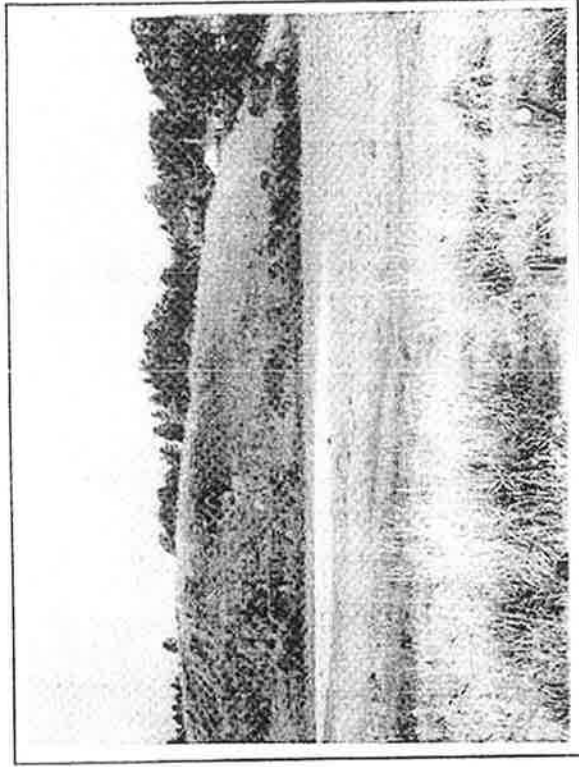

**A view looking west from Soquel-San Jose Road across the lower bench, where access to the park is proposed.**

The northeast leg of the "T" is composed of a terrace that is geographically continuous with the Tan property to the north. This uppermost terrace is bisected by a gully which terminates to the west in a riparian corridor that drains into Rodeo Gulch. This terrace is the habitat for rare and endangered plant species: Santa Cruz tarplant and Gairdner's yampah.

The main vertical leg of the "T" is bound on the east by a riparian corridor characterized by willows. This riparian corridor separates the property from the Soquel High School campus. Dominating this area is the knoll, a conical, steep-sloped feature which is a remnant of an ancient stream terrace. Between the knoll and the slope to the west (extending to the Greenbrae neighborhood), is a saddle or low point. South of the knoll is a gently sloping area, which terminates in an incised riparian corridor, composed mainly of oak and eucalyptus trees with a few other riparian tree species. On the other side of the riparian corridor, there is a small vacant area fronting on Soquel Drive.

### Conceptual Plan

#### **Community Process**

Over the years, as various proposals were considered for the Anna Jean Cummings Park property, a considerable amount of environmental information has been developed for the site. Although the property is large, there are a number of constraints which restrict the suitable areas for development. As a part of the community planning process for the property,

12

a constraints map was prepared based on the information from environmental documents<sup>1</sup>, field reconnaissance, and other technical information (see figure 2 - Site Constraints). This map helped guide decisions made about the uses and areas of activity proposed for the site.

These site constraints included:

- \* Riparian corridors
- \* Steep Slopes
- \* Geologic Hazards
- \* Rare and Endangered Plant Habitats
- \* Visually Sensitive Areas

Of the entire 96-acre property, only approximately 36 acres are suitable for development. The areas of the site identified as appropriate for development include the area south of the knoll, an area between the knoll and Soquel High School, and the upper and lower benches. Because the two benches are relatively level and are not in proximity to sensitive habitats or riparian areas, it was determined that they were the best location for park uses such as playing fields.

Based on these constraints and ideas from the community planning process, a series of land use plan alternatives were proposed and environmental analysis prepared<sup>2</sup>. This information was ultimately used to reach community agreement

---

<sup>1</sup> Environmental documents include a 1979 EIR prepared by Jones and Stokes for a proposed residential development.

<sup>2</sup> O'Neill Ranch Master Plan Draft Environmental Impact Report, prepared by Michael Clayton & Associates July 1991

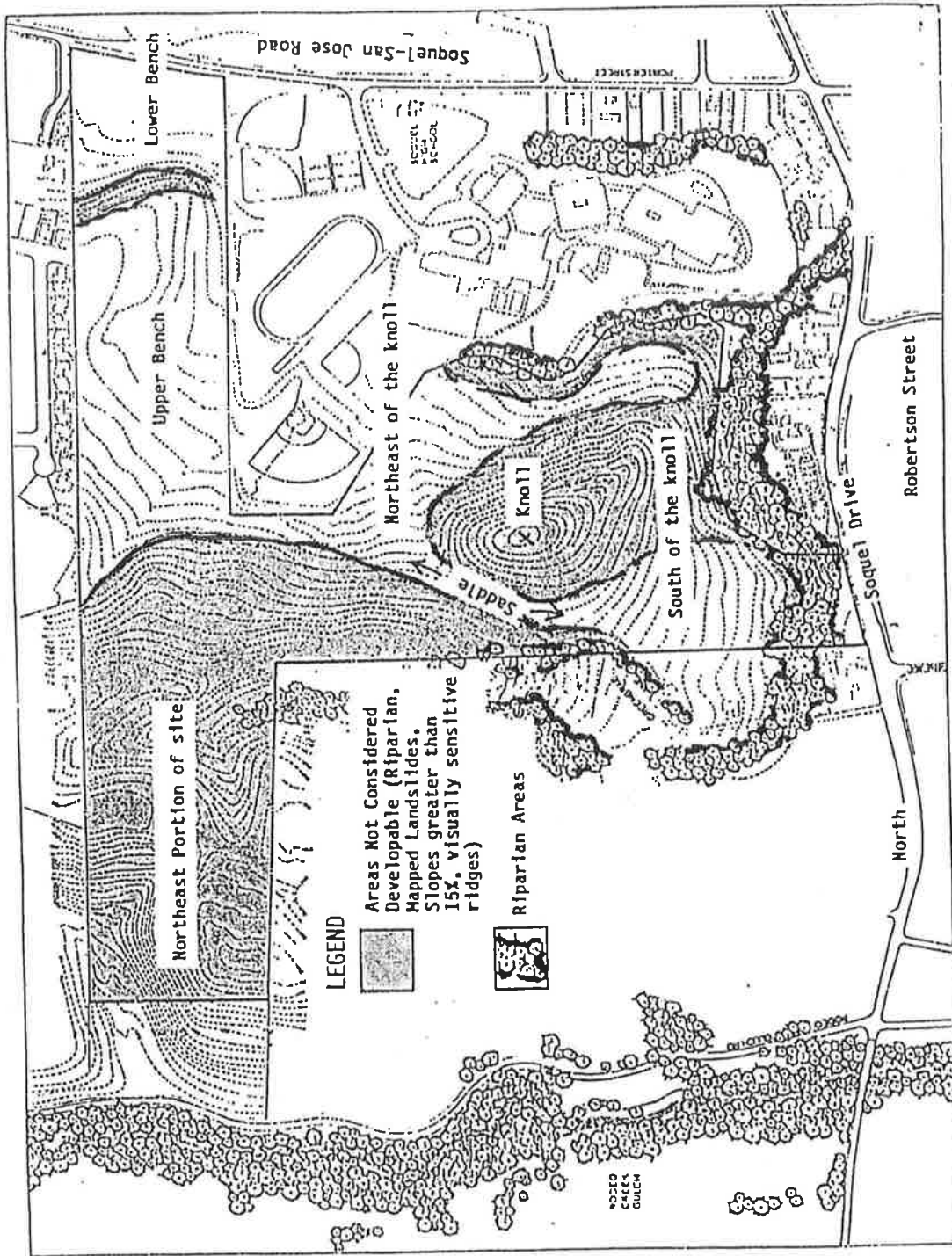

**Anna Jean Cummings Park  
Site Constraints**

**Figure 2**



on a preferred land use plan for the purposes of further analysis. The preferred land use plan was analyzed in an Environmental Impact Report (EIR) prepared by Brady and Associates in August 1995. The EIR also looked at a number of alternatives to the project including development of the site entirely as a park.

After several public hearings and considerable community input, the Board of Directors of the Redevelopment Agency approved the O'Neill Ranch Conceptual Plan in August 1996 (see Figure 3- Conceptual Land Use Plan).

**The Conceptual Land Use Plan**

The conceptual land use plan sets aside areas of the property for active recreational use, open space, future park uses, and a small commercial/office use. These general activity areas provide locations on the site to accommodate a broad range of activities, consistent with the site recreational goals developed during community and neighborhood meetings and the overall goals for development of the property (see Figure 4 - Conceptual Plan Goals).

This plan clusters active recreational uses in the northeastern portion of the site, on the upper and lower benches adjacent to Soquel-San Jose Road. These uses include a wide range of community and neighborhood recreational activities including picnic areas, play structures and playing fields for adult and youth league sports. The master plan for these active recreational uses and site access is discussed in greater detail in the following section.

- Anna Jean Cummings Park  
Conceptual Plan Goals*
- *Meet critical needs for active playing fields to serve the mid-county area*
  - *Provide for community and neighborhood park needs*
  - *Preserve open space and protect plant and animal habitats*
  - *Retain the beauty and natural character of the property*
  - *Locate access and active recreational uses to minimize grading and site disturbance as well as to respond to the concerns of adjacent neighborhoods*

Figure 4

The upper terrace area is reserved for hiking, nature appreciation and other passive recreation activities. Habitat preservation of the Santa Cruz tarplant and Gairdner's yampah will also occur in this area.

Additional park uses, to be defined at a future time, would be located south of the knoll, and between Soquel High School and the knoll. The remaining steeper portions of the property and riparian areas would be retained as open space.

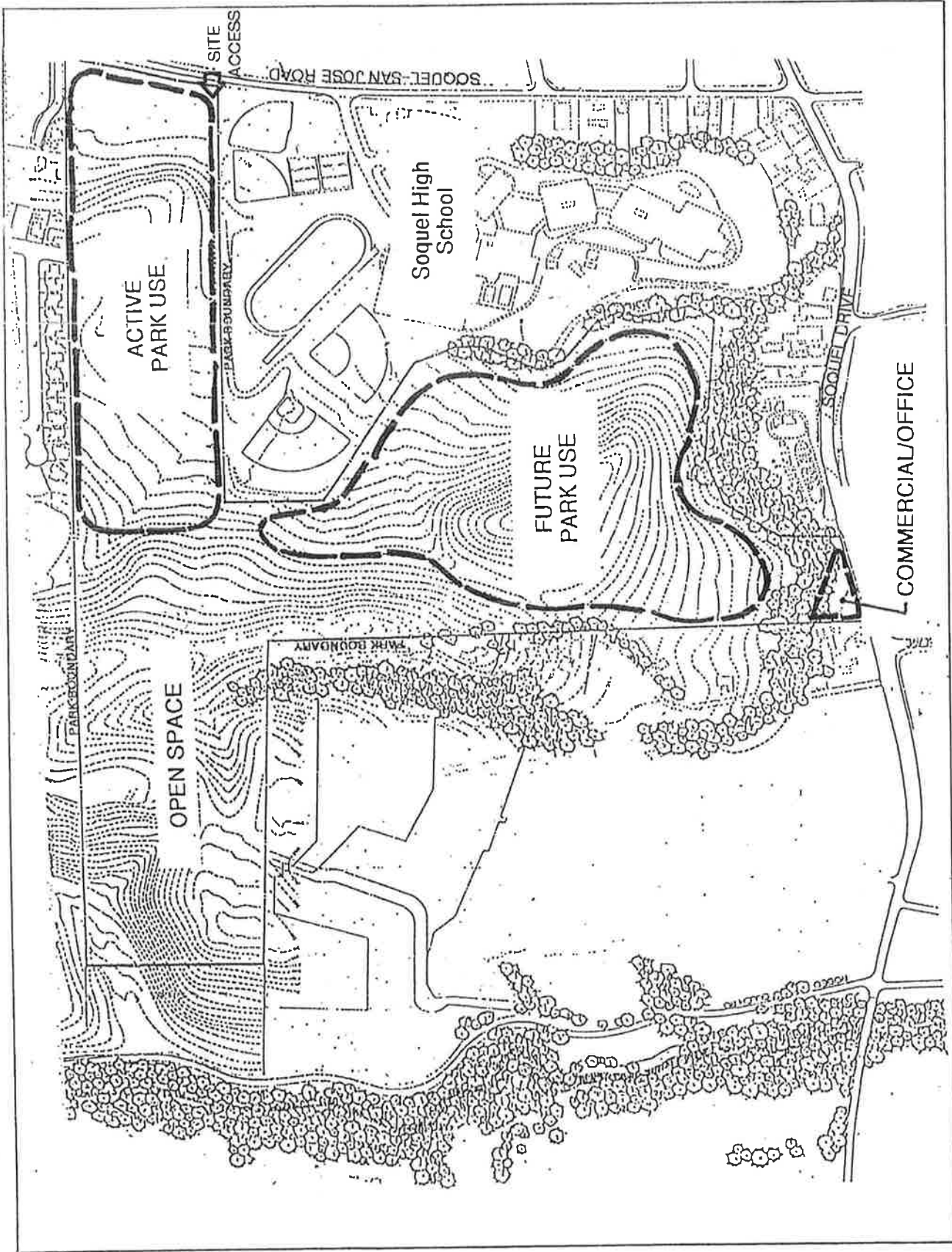

Anna Jean Cummings Park  
 Conceptual Land Use Plan

Figure 3

158

Every effort was made to locate the site access and active playing fields away from riparian corridors, steep slopes and rare and endangered plant habitats (see Appendix 1 - Tar Plant Mitigation). The proposed locations of the most intensive activity have also been planned to minimize site disturbance and grading. In addition, through the community planning process, the concerns of adjacent neighborhoods and members of the community have been incorporated into the plan.

***Anna Jean Cummings Park  
Recreation Elements***

- *Playing Fields for Youth and Adults*
- *Community and Family Picnic Areas*
- *Hiking and Jogging Trails*
- *Open Space and Habitat Management*
- *Access and Parking Close to Playing Fields and Picnic Areas*
- *Community Funding Partnership*
- *Potential future Expansion of Park Uses*
- *Possible Cooperative Use of Facilities with Soquel High School*

**Park Master Plan**

A critical community need for the expansion of active playing fields to serve the mid-county area was identified during the planning process. The need for neighborhood and regional park facilities serving the Soquel area was also recognized. As a result the park master plan envisions broad community use of the Anna Jean Cummings Park property in a variety of activities (see figure 5- Conceptual Plan for Upper and Lower Benches).

**Community Design Workshops**

A number of community and neighborhood design concerns were identified from the EIR and previous planning processes. Several of these concerns specifically related to how the design of the active recreation facilities affects the adjoining neighborhood, while others were tied to the function and design of the park uses that will serve the entire community.

In the spring of 1997, community design workshops were held with representatives of organized sports leagues in mid-county and members of the community to develop a plan for active recreation on the upper and lower benches. These series of meetings focused on design solutions to address the issues and concerns relating to the proposed park, and concluded with a presentation of a Preliminary Master Plan for Anna Jean Cummings Park, which with minor modifications to field layout and landscape buffers received general community support.

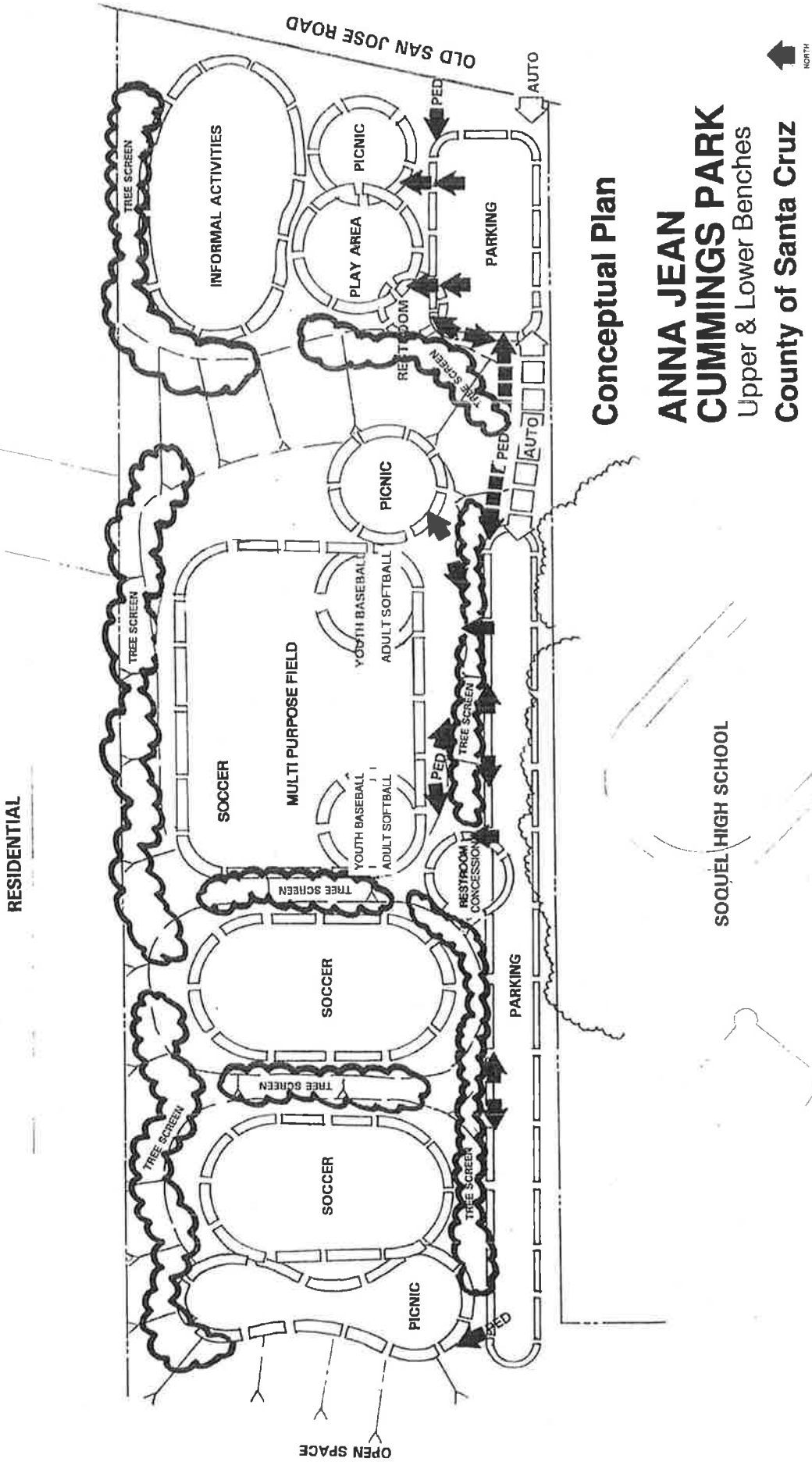

**Conceptual Plan**

**ANNA JEAN CUMMINGS PARK**  
 Upper & Lower Benches  
 County of Santa Cruz



**Figure 5**

The area on the upper and lower benches proposed for active recreation is approximately 25 acres and is designed to blend with the natural topographic features of the site. The general features of the plan are described below followed by more detailed descriptions of actual facilities (see Figure 6- Preliminary Master Plan).

### **Access and Parking**

Access to the site is planned from Soquel-San Jose Road at the location of an existing, unpaved driveway parallel to the southern property boundary with Soquel High School. This access has been chosen because it is the most cost effective, creates the least environmental impacts and provides direct access to the areas of most intensive activity. Because parking is proposed both on the lower bench and on the northern side of an access road on the upper bench (between the road and the playing fields), this design concept also addresses a major neighborhood concern about park users parking on residential streets. The access road would terminate in a turnaround at the base of the slope leading to the open space and regional park area. In addition to the parking along the northern edge of the access road, an area on the upper bench has been reserved for future parking, if needed

### **Recreational Uses**

The main entrance to the park will be located on the lower bench. The master plan calls for "neighborhood" park uses, a picnic area, children's play area, restrooms and informal turf on

the lower bench as suggested by the community. Parking will be provided to accommodate use of these facilities and provide for spillover parking from the upper bench uses. As a part of development of park uses sidewalks will be constructed along the Soquel San-Jose Road property frontage. No formal access to the park will be provided from Dawn Lane. Both the access road and a pedestrian pathway will lead up to the upper bench, where the most active recreational uses will be located. These uses include two soccer fields, a multipurpose field, and additional informal picnic areas. The intention is to design the fields so that they can be reconfigured as necessary to allow for use by varied age groups and sports organizations. In order to minimize grading, the fields will be constructed in three levels. Restrooms with a concession area will be provided between the two field levels, adjacent to the parking lot and walkways.

As opportunities arise, cooperative use of park and Soquel High School athletic facilities will be explored. Future expansion of park areas and activities will occur as funds are available and community interest grows. In the interim, the area designated for future park use will continue to be used informally for passive recreation.

Highlights of the Preliminary Master Plan include:

### **Upper Bench**

- Parking Lot - is located in close proximity to the active recreation, space for 100 cars is shown on the upper

12

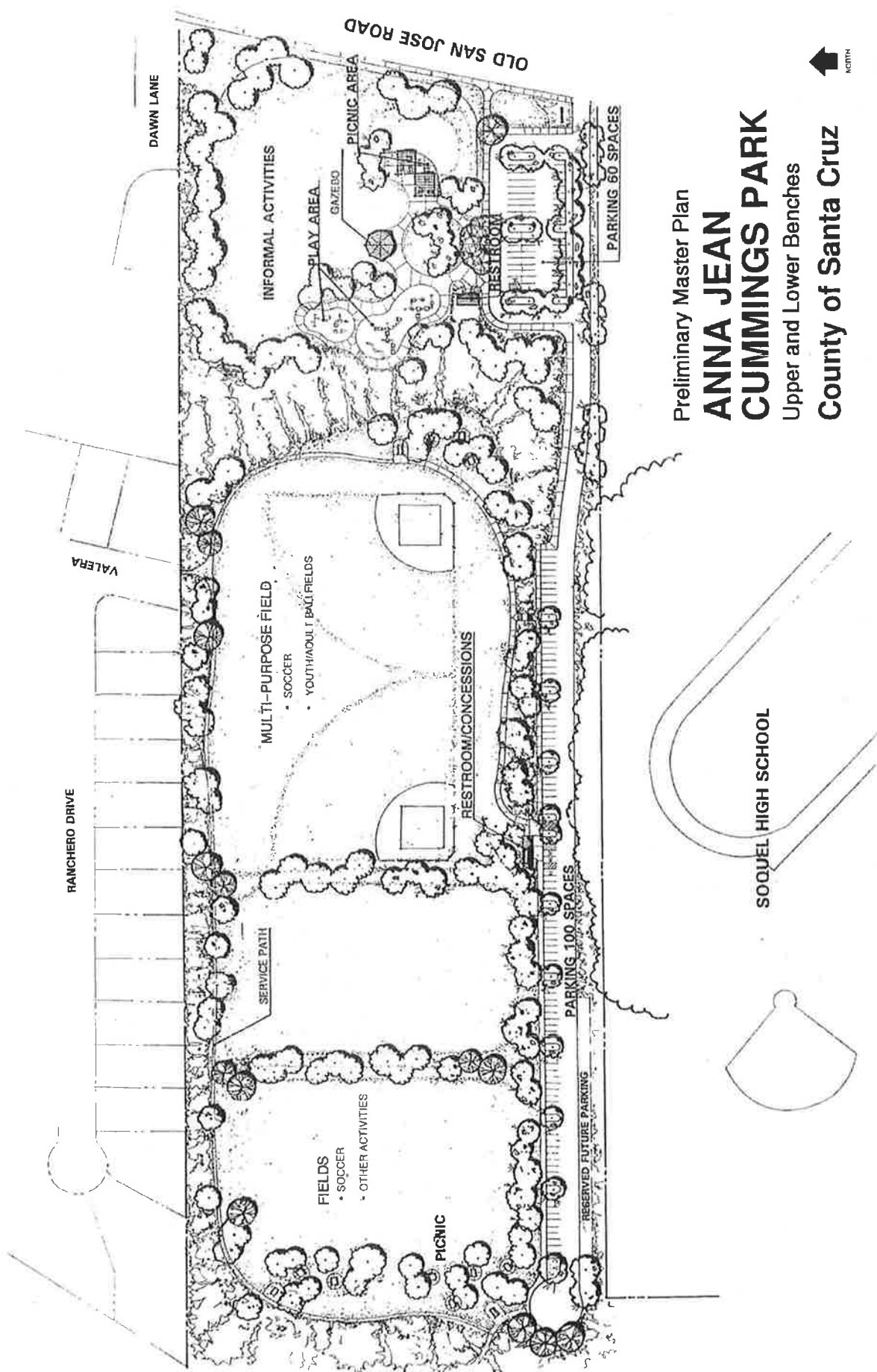

Preliminary Master Plan  
**ANNA JEAN CUMMINGS PARK**  
 Upper and Lower Benches  
 County of Santa Cruz

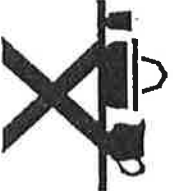

Figure 6

bench with an additional area set aside which could increase the lot size to 140 spaces in the future. This amount of parking will discourage the use of residential street parking in the surrounding neighborhoods. The parking lot will have signage to inform high school students of restricted to park use parking only and will be landscaped.

Fields for Active Recreation - the upper bench will be regraded to create 3 terraces to accommodate 2 soccer fields and a large multi-purpose field. The multi-purpose field will incorporate 2 youth/adult ball fields or soccer play in a variety of arrangements. This plan will help the community meet the needs for active recreation in the mid-county area.

Picnic Areas - informal picnic opportunities will be available at individual locations in the upper bench area of the park intended for more private gatherings or a small party after a game. These locations will have a table and possibly a barbecue set a upon a concrete pad (away from open space) located in



the open sun or sometimes near a shade tree.

Restroom/Concession Building - will be conveniently located next to parking and the fields for active recreation. The prefabricated structure will be designed to not only accommodate restrooms, but also storage and concessions as suggested by organized teams. The

building will meet all codes and accessibility requirements.

Pedestrian Access - will be possible from Valera Drive, Old San Jose Road, and different points along the High School property line providing greater access to the park.

Landscaping - will consist of mixed species of trees located to shade and define activity areas such as field spaces and picnic areas and to buffer residential property lines. Landscaping will be designed to blend into the native hillside areas beyond the formal park improvements. The understory will consist of native material mixed with drought tolerant perennials for water conservation and selected with consideration of fire resistance, erosion control, and low maintenance requirements. Open turf areas will be suitable for a variety of active recreational uses.

Setback Buffer - included in the development of the park is a requirement for a buffer to mitigate noise and restrict encroachment of active park uses for residences adjacent to the park along Rancho and Valera Drives. A substantial landscaped setback will slope down from the property line to the field areas and will be planted with a variety of trees and shrubs. (see Figure 7 - Section Drawings). Existing fencing will be left in place. If after the park has been constructed and is in use, residents desire additional noise mitigation, the Redevelopment Agency will construct a new 6 foot high solid board fence.

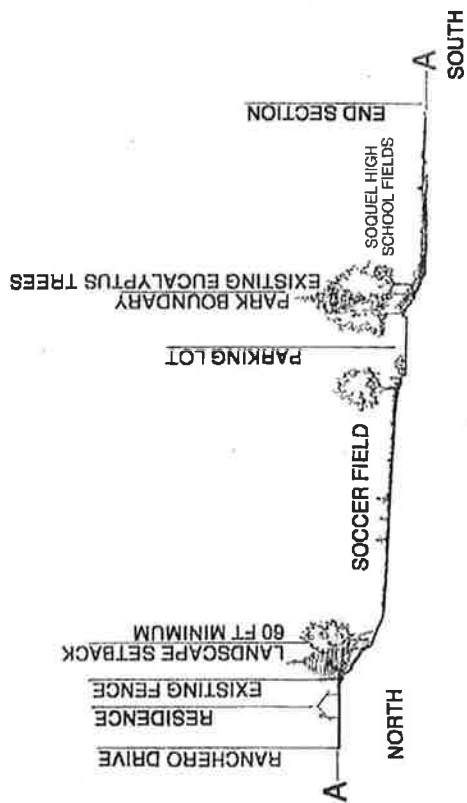

SECTION A-A ACROSS THE UPPER BENCH

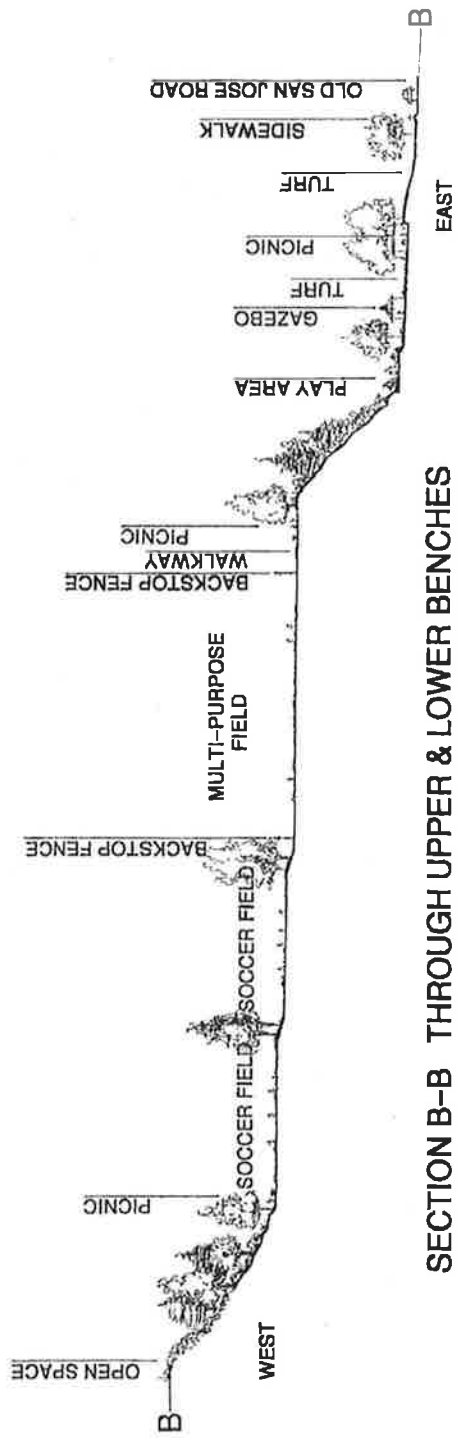

SECTION B-B THROUGH UPPER & LOWER BENCHES

PRELIMINARY MASTER PLAN

**ANNA JEAN CUMMINGS PARK**  
**UPPER & LOWER BENCHES**

Figure 7



## Lower Bench

- Parking Lot - located off Soquel-San Jose Road, will provide vehicle access to the park site. Spaces for 60 cars are located on the lower bench where picnicking and play areas are located. The lot will be landscaped.
- Picnic Area - the picnic area located on the lower bench, near the play area and will consist of a groups of tables, barbecues, trash receptacles under a shade structure surrounded by a tree canopy.
- Play Areas - on the lower bench, a large free form play area is planned which will house a multiple of play structures and swings for various age groups and will be surrounded by bench seating for careful watch by parents. The play area will meet all safety and accessibility guidelines.
- Gazebo - located off the walkway near the picnic area will provide a focal point for the lower bench and be used for presentations, informal performances, displays, or other recreation programs.
- Restroom/Maintenance Building - this small scale prefabricated structure is tucked up at the base of the slope, yet is conveniently located to serve the play area and group picnic area. This building area will also include space for equipment and supplies related to maintenance of this park facility. Maintenance areas will be appropriately screened from public views.
- Landscaping - will consist of shade trees mixed with occasional flowering accent trees grouped in locations to shade and distinguish activity areas such as; picnic areas,

the play area, or the edges of turf areas where someone might relax away from other park activities. The understory will consist of native material mixed with drought tolerant perennials for water conservation and selected with consideration of fire resistance, erosion control, and low maintenance requirements. Open turf areas suitable for all types of informal park activities will cover the rest of this portion of the park.

- Informal Activities - the park improvements on the lower bench offer opportunities for formal and informal recreation.
- Safety and Visibility - the layout of the park elements has been done with safety and visibility as a key requirement. The arrangement of these elements in the vicinity of the parking area allows the sheriff and other security personnel direct visibility of the restroom, play area, picnic areas, soccer and baseball fields, from the patrol vehicles. The parking lot entrance will be secured with a gate during nighttime hours.
- Public Art - a public art component will be included in the development of the park. Two percent of the construction cost is budgeted to cover the cost of the artist fees and art component.

### **Anna Jean Cummings Memorial**

Anna Jean Cummings, the original executive director for the Land Trust of Santa Cruz County, was instrumental in bringing community focus to the O'Neill Ranch property eventually leading to the purchase of the property by the Santa Cruz

County Redevelopment Agency. The Land Trust of Santa Cruz County has established a memorial fund in Anna Jean's name with the intention of constructing a tribute to her on the park property. The Land Trust will work with the Redevelopment Agency and the Parks Department to determine an appropriate setting and theme for this memorial.

### **Preliminary Cost Estimates**

#### **Park Development Costs**

A preliminary cost estimate for the design and construction of improvements described in this plan is \$2,200,000. This estimate includes all costs associated with the design and development of the park improvements including utilities, grading and drainage, parking lots, restroom and concession buildings, all walkways, picnic areas, play equipment, a gazebo, irrigation, turf areas, landscaping and a public art project. However, only \$2,100,000 in funds have been identified for this project in the Redevelopment Agency's Capital Improvement Project Budget leaving a budget shortfall of \$100,000. In the past, organized sports leagues have expressed interest in possibly contributing to the park development to bridge any funding gaps. The budget shortfall may thus be addressed by a cooperative venture with organized sports leagues.

#### **Park Maintenance Costs**

While the development of the upper and lower benches at

Anna Jean Cummings Park will be funded by the Redevelopment Agency, state law prohibits Redevelopment Agency's from funding on-going maintenance and operations costs. Thus once the park improvements have been completed, the County Parks Department will assume maintenance and operations responsibilities.

Park maintenance cost are based on personnel costs, the cost of supplies and materials, and utility costs. The maintenance costs indicated in this report are based on existing County Park Department standards which represent a medium to high quality level of maintenance. This level of maintenance insures protection of the initial development investment as well as providing useable, well maintained facilities for the park user.

Based on existing maintenance practices within the County Parks Department, one Park Maintenance Worker is responsible for 7.3 acres of developed parkland. This figure includes supervision and specialist classifications currently used for equipment operation and repair. Material/supply costs are based on current expenditures within the County Parks Department.

Using these standards the estimated annual cost of maintaining the proposed park improvements is \$221,000 in 1998 dollars. It should also be noted that there is the opportunity for this facility to generate revenues from the use of park facilities to offset part of these maintenance and operation costs. Funding for operations and maintenance of Anna Jean Cummings Park is not currently allocated in the Parks Department Budget and will

32

need to be approved by the Board of Supervisors as part of the department's annual budget process.

### **Plan Adoption and Implementation**

#### **Plan Adoption**

This Preliminary Park Master Plan must be reviewed and approved by the Parks and Recreation Commission. Then the plan will be forwarded to the Board of Supervisors for review and adoption before the Redevelopment Agency can proceed with the next steps towards implementing this plan. Public hearings will be scheduled by both the Parks and Recreation Commission and the Board of Supervisors.

#### **Implementation**

Once the park master plan has been adopted the Redevelopment Agency can proceed with the following:

- Public Art Process - which includes formation of a selection committee, development of conceptual ideas, artist selection, and public art project approval by the Art Commission and the Board of Supervisors.
- Tar Plant Management Plan- will be developed and implemented to address the management and protection of this endangered species.
- Development Permit- submitted to the Planning

Department includes review of preliminary grading and drainage plans as well as other preliminary site development plans by county departments and other agencies.

- Detailed Design- once the Development Permit is approved, detailed drawings will be generated clarifying all aspects of the design and the details necessary to construct the improvements. Cost estimates will be fine tuned.

- Construction Documents and Specifications- these documents are the nuts and bolts needed to hire a Contractor to develop the park. From the detailed drawings this set of documents will be used to bid the project.

- Bidding and Construction- once bids have been received and reviewed by the Redevelopment Agency, a recommendation will go to the Board of Supervisors for an Award of Contract, and then actual construction will begin. At this time that date is anticipated by the Spring of 2000.



**Appendix I**

**Tar Plant Mitigation**

A Santa Cruz tarplant management plan will be prepared by a qualified botanist and implemented. The plan will identify areas where tarplant growth is likely, and management methods to encourage tarplant growth in these areas. Tarplant grows in moisture retaining soils where competing grasses are short due to grazing, mowing, or fire. Plan preparation is to include research on the site slope and soil conditions conducive to tarplant growth, and pilot management program (such as mowing) of some of the areas. A 5 year monitoring program and management will be set up and adjusted per habitat changes. These actions are also expected to benefit the growth of the Gairdner's yampah.

A 10 foot buffer zone will be established around existing populations of Santa Cruz tarplant and Gairdner's yampah in the northwestern part of the site. These buffer zones will be protected from human intrusion by low fences and "Do Not Enter" signs.

**Acknowledgments**

**Santa Cruz County Redevelopment Agency Board of Directors and Santa Cruz County Board of Supervisors**

- Jan Beautz First District
- Walter J. Symons Second District
- Mardi Wormhoudt Third District
- Ray Belgard Fourth District
- Jeff Almquist Fifth District

**Santa Cruz County Redevelopment Agency**

- Susan A. Mauriello Executive Director
- Tom Burns Agency Administrator
- Sue Gilchrist Project Coordinator
- Betsy Lynberg Urban Designer
- Gary Carlson Park Planner

**Santa Cruz County Department of Parks, Open Space and Cultural Services**

- Barry Samuel Director
- Dave Mitchell Park Planning and Development Manager
- Gretchen Illiff Facilities and Maintenance Manager
- Clark Beattie Recreation and Cultural Services Manager

## **Anna Jean Cummings Park Proposal:**

1. Preservation of Open Space
2. Dedication and Enhancement of Existing Trails

### **Summary**

The open space and trails at Anna Jean Cummings Park are highly popular with the immediate Soquel community and residents from throughout the county. Most of these trails existed prior to the establishment of the park in 2000. Trail use has increased exponentially over the years since then. It is the only public open space in Soquel and only one of a few areas in the mid-county where safe, natural trails are available and easily accessible. Both the moderate and the more challenging trails continue to be used by nature-lovers, dog-walkers, hikers, runners, athletic teams from sport clubs and the neighboring high school, and out-of-town visitors while enjoying local sports events.

See EXHIBIT A: AJC Trail Map

### **Goal #1: Preserve Open Space and Dedicate Existing Trails**

The open space of Anna Jean Cummings Park has offered the community an historical and visual corridor, gracing the village since Soquel was established in the 1800's. In the years prior to becoming a park, the property was a dairy farm known as the O'Neill Ranch. After the dairy stopped operating almost 50 years ago, Soquel residents began using the property as a corridor from Soquel Highlands to the high school and village and as a place for running, walking and passive enjoyment of the open space.

Maintaining this open space and trail use was a priority during the extensive community planning process that resulted in the 1998 Parks Master Plan still in effect today. Dedication of the trails and open space would encourage good stewardship and would ensure that the existing open space be protected for passive recreational use for future generations.

### **Goal #2: Enhance Existing Trails**

Visitors to Anna Jean Cummings Park are often confused about the boundaries of the open space areas of the park and unclear about where the trails lead. Informational maps, trail names and directional signage would help visitors orient themselves in the open space and assist them in planning their time there. Information would also protect the natural terrain. Some specific improvements might include:

1. Informational and directional signs for trail users near the upper parking lot and at several key points along the trails. These might include a trail map, arrow signs, trail names and mileage markers.
2. Educational information highlighting the chronological history of the park and its ecological features such as geological, flora and fauna. This could possibly include the six known biotic habitats (seasonal wetland, mixed evergreen forest, non-native grassland, coyote scrub, chaparral, and mixed riparian forest.)
3. "Sensitive Habitat" or "Stay on Trail" signs located where terrain is especially vulnerable to users. This might include areas within a high water table, riparian corridor, or containing endangered plants, such as Gairdner's Yampah, Bunchgrass and Tar Plant.
4. Identification markers for common, rare and endangered species of animals, plants and insects identified in the 1995 E.I.R. which inhabit the Anna Jean Cummings Park open space. Such markers could be placed along trails to help familiarize visitors with the unique characteristics of the park and act as an educational opportunity and enhancement. This project could encourage participation by both local environmental and educational groups.
5. "Dog Etiquette Rules" and "Pack Your Trash" signs along the trail. The land and wildlife should be respected. Dog poop and trash left behind have negative visual and environmental impact. Additional biodegradable poop stations (as are commonly found in other parks) and trash receptacles would be helpful.

Respectfully Submitted by:

Friends of AJC Park

# EXHIBIT A: AJC Trail Map

— AJC Park Boundary — Existing Trails

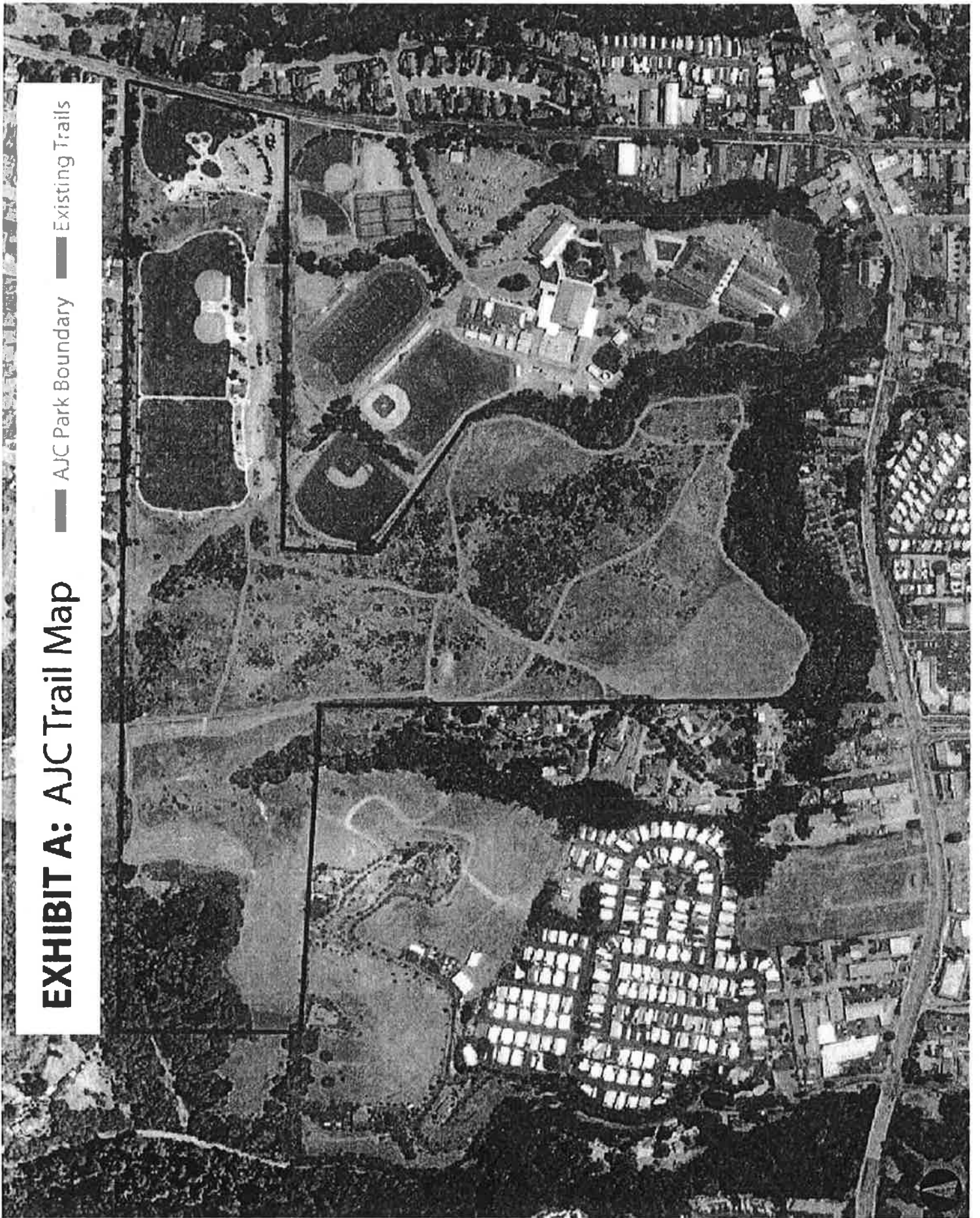

Left  
Blank  
Intentionally



# Proposal for Enhancement to Anna Jean Cummings County Park; Seasonal Nine Hole Recreational Disc Golf Course

---

The Soquel High Disc Golf Club (SHDGC) proposes to install a 9-hole seasonal disc golf course at Anna Jean Cummings (AJC) County Park "south of the knoll and between Soquel High School and the knoll."<sup>1</sup> The course will be installed on a 12 month provisional basis, after which time there will be a review to determine whether the course should remain, any changes should be made, or be removed.

## BACKGROUND

In 1999, the Soquel High School Disc Golf Club was founded, and in that same year they started competing in the Santa Cruz County Interscholastic Disc Golf League (SCCIDGL). The original club included current world champion Nate Doss, however, it is the current club and its members who are finally acting on the club's long time dream to design a disc golf course for interscholastic competition, team practice, and off season recreation at Anna Jean Cummings County Park. Our season starts in mid March and continues into May. Each Sunday, during the season, all the teams of the league (Soquel, Aptos, SLV, Santa Cruz, Harbor, PCS, and Scotts Valley) meet for inter-league competition. All the matches this past season were split between the SLV and Aptos home courses. Scotts Valley is currently working on one for their school while Harbor has a 6 hole course around the track and their playing fields.

## RATIONALE

Like the Disc Golf Clubs of SLV, Aptos, Scotts Valley and to some extent Harbor, the Soquel club would like to have a local home course as well. Unfortunately our campus only has the space to support a couple of practice holes and so we have looked to AJC not only to install a course for team practice and league competition, but for the promotion of the sport with the students of Soquel High School, the SHS physical education program and for the greater Soquel community itself. Our closest disc golf course, DeLaveaga, is a 27-hole championship course that is rated as one of the most difficult courses in the world. What we are proposing for AJC is a *recreational* course designed for all types of players especially for beginners and those just learning the game. With limited space on the Soquel High grounds, and with AJC being adjacent to the campus and part of our local community, it is the ideal location for our proposed course.

The installation of a disc golf course would also be consistent with the stated goals of the recreational master plan for AJC. Under the Conceptual Land Use Plan on page 6 the plan mentions "Additional park uses, to be defined at a future time, would be located south of the knoll, and between Soquel High School and the Knoll" and then the Conceptual Land Use map on pg. 7 (figure 3) designates an area for "future park use." It is within this "future park use" area that we have designed our 9 hole course.

On pg. 8 of the master plan, under the AJC Park Recreation Elements "cooperative use of facilities with Soquel High School" is mentioned and later on pg. 10 under Recreational Uses once again it states that "As opportunities arise, cooperative use of park and Soquel High School athletic facilities will be explored. Future expansion of park areas and activities will occur as funds are available and community interest grows." The P.E. Department from Soquel High School has been very supportive of our proposal and would look forward to cooperative use of the facilities as would we during our disc golf season.

With kids spending more and more time in front of the computer on the Internet, watching TV, playing video games or doing all the above on their phones, we are proposing a healthy alternative. The cost to play a sport on campus can run a family hundreds and hundreds of dollars, disc golf is inexpensive and can be enjoyed immediately on your first time out, not just by students, but people of all ages and abilities.

---

<sup>1</sup> County of Santa Cruz Redevelopment Agency, *Anna Jean Cummings Park*. County of Santa Cruz Redevelopment Agency. N.p.: n.p., 1998. 10. Print

# Proposal for Enhancement to Anna Jean Cummings County Park; Seasonal Nine Hole Recreational Disc Golf Course

---

## **What is Disc Golf?**

Disc golf is a fun and inexpensive game that can be enjoyed by people of all ages and abilities. It is played much like traditional golf, only instead of hitting a ball into a "hole", you throw a disc into an elevated metal basket. As players progress from the "tee" to the "hole," they must make each consecutive shot from the spot where the previous throw landed. Once you get close enough, you throw the "putter" into the basket, ending the hole. The natural changes in terrain provide challenging obstacles for the golfer to meet the goal of completing the course in the fewest number of shots.

## **Meeting Recreational Needs:**

Disc golf is the fastest growing sport across the United States, especially in the Bay Area. There are now more than and more than 2,400 disc golf courses (with over 52,000 registered disc golfers) in the United States and Canada, many installed by city and county parks departments who have found that there are few recreational activities that offer the high benefit-to-cost ratio of disc golf. A disc golf course at AJC will provide an inexpensive form of recreation for people of all ages, from children to seniors, and be a welcome addition to the Physical Education Department curriculum at Soquel High School.

## **Affordability & Accessibility:**

At a time when school sports can cost hundreds of dollars to play, disc golf is an inexpensive alternative. The course will be free to the public and open on a seasonal basis to coincide with the County Parks seasonal use of the playing fields at AJC. The only equipment needed is a disc which can cost between \$5-\$20 and can be used over and over again.

## **Environmental Impact: Why a seasonal 9 hole Course?**

Though the impact is less significant compared to other recreational sports, a byproduct of disc golf is foot traffic and trails will be created. We are proposing a seasonal course (pulling the baskets in the off season) from November 15th thru March 15th in hopes to significantly reduce environmental impact during the rainy winter months. AJC Park closes their playing fields during this same time period, and so we we would coincide with AJC's seasonal closures.

Disc golfers tend to take great pride in where they play, which helps reduce potential litter on the course. Most recreational activities require alterations to the landscape and continual maintenance, while disc golf uses each unique landscape as an obstacle and requires minimal maintenance. The visual corridor or impact of a disc golf course on the surrounding area is also minimal: the tees are level with the ground and are visible only from a short distance, while the baskets are a dull metal color and do not significantly stand out. At AJC, the course has been designed to avoid riparian areas. The existing trails will be improved during course installation (especially the steep path down the eastern side of the knoll), and new paths will be added in certain areas to minimize the impact of foot traffic, and reduce erosion.

## **Course Design/Safety:**

The 9 hole course has been designed with the safety of players and park-users as the top priority. Flight path is directed away from trails, while out-of-bounds helps to ensure safety, and reduce environmental impact. Eight of the nine proposed holes are specifically designed to discourage the throwing of discs in the direction prospective shared users using the perimeter trail. Care has been taken in the design of the course to eliminate user conflicts, minimize potential damage to foliage, and reduce erosion.

The course has also intentionally been designed as a *recreational* course, in comparison to a *Champion* Course, like those found at Pinto Lake and DeLaveaga. A recreational course tends to be shorter and caters more towards the beginner and intermediate players; perfect for youth, families, and anyone else who is unfamiliar with the sport. There are many of these beginners attending Soquel High who could use this course, either for their PE class, an after-school sport, or for practice and competition in the disc golf club.

# Proposal for Enhancement to Anna Jean Cummings County Park; Seasonal Nine Hole Recreational Disc Golf Course

---

## The holes (a brief summary and length):

The course begins at the upper parking lot where a rules and etiquette sign will be posted with a course map, notifying both players and walkers where the shared use area of the park will be. Along the "Saddle" trail, and throughout the course are located small signs close to the ground with arrows that will help direct players to the following tee. The perimeter trail and the major trails dissecting the knoll are all to be designated out of bounds.

- 1 140 feet (O'Neil Ranch\*): Located in the south west corner of the knoll on a slight uphill slope, it's a great first tee shot that shoots away from the perimeter trails and it is not too difficult. From hole one basket to hole two tee, we will create a defined path (115 feet) with rope going to the trail to the top of the knoll establishing a single trail.
- 2 449 feet (41st): Starting on top of the knoll, this hole slopes into the grassy plain and is the longest of the nine holes. We will create another defined path going down from the 3rd tee.
- 3 250 feet (Low Income Housing, The Development): Slightly aside from the grassy plain, there is out of bounds to the right of the hole to even further discourage players to avoid the perimeter trail.
- 4 238 feet (Soquel High School): Laying on the side of the knoll at a gradual incline, this putt ends at the top of the knoll. As you crest the knoll you have your first view of the Soquel High School campus behind the pin, before the existing trail which leads you out of bounds.
- 5 249 feet (Riparian Corridor): At the bottom of the knoll, this hole slopes into the Eastern corner of the park. We will set up an out of bounds behind the hole, marked with rope, to prevent people from throwing towards the trail and the riparian corridor.
- 6 240 feet (Save Soquel): The hole goes away from the path and we have added out of bounds to ensure discs avoid the perimeter trail. This hole is damp during the winter and will benefit from seasonal closure.
- 7 280 feet (The Pasture): A slightly rising hole in a large open field shooting away from the trail along the base of the slope on the west side of the field.
- 8 150 feet (Anna Jean Cummings): is a short uphill hole that starts in a small oak grove and goes through an open field, ending near the base of the knoll. A sign will direct you to hole 9 and a small trail will need to be created through the coyote brush on the north side of the perimeter trail.
- 9 180 feet (Soquel High Disc Golf Club): Is directly behind the varsity baseball field (right field). To reach the tee pad, you have to walk into an inner meadow past the large coyote bushes. Similar to hole eight in length, it shoots around the curve of the baseball's outfield and ends near the parking lot, completing the loop. Another sign will direct you towards the parking lot.

**Average hole length: 242 ft. According to Disc Golf designers, the average hole length of an intermediate/beginner course should be under 250 ft.**

\*Within the parenthesis ( ) are possible names with historical meaning honoring the preservation of AJC. Later signs could be added telling a history of the park as you play the course.

***The Mission of the Santa Cruz County Department of Parks, Open Space and Cultural Services is to provide safe, well-designed and maintained parks, and a wide variety of recreational and cultural opportunities for our diverse community.***

We believe the proposed course at AJC not only works with the goals of the recreational master plan, but also the Santa Cruz County Parks mission statement by providing a safe, well designed and maintained course that offers an opportunity for our diverse community to play disc golf!

# Proposal for Enhancement to Anna Jean Cummings County Park; Seasonal Nine Hole Recreational Disc Golf Course

---

## RESPONSIBILITIES OF SHSDGC

### **Construction:**

The installation of a 9-hole disc golf course in AJC will involve the construction of tees, the installation of inexpensive yet durable signs and baskets, and minimal clearing of poison oak, coyote brush and dead branches. Under the proper supervision of the Park & Recreation staff, the SHDGC, along with volunteers, will install the equipment in accordance with manufacturer instructions.

#### *Pads:*

Each hole will have one tee pad measuring approximately 4' x 8' x 4" and will be made of concrete (**Annex 1**) We have researched a rubber alternative but have found that Concrete is less expensive and safer for the discgolfer.

#### *Baskets:*

DGA Mach III Disc Hole basket with a locking collar set in a cement hole measuring approximately 10" in diameter and 28" deep (technical specifications for the installation of tees and baskets can be found in **Annex 2**). All 9 baskets are to be donated by the De Laveaga Disc Golf Club.

#### *Signs:*

Club members have discussed with both the wood shop and metal shop teachers to create tee signs, and the information/rules sign that will be placed in the upper parking lot for players to read before they begin the course. The rules and information sign will be constructed using two 4' x 4' wood posts sunk in concrete four feet apart. A board measuring 4' x 4' and 1" thick will then be attached to the posts with the help of new club members, students, volunteers, wood shop, and metal shop.

Each hole will have a tee sign indicating the hole number, length, out of bounds, constructed by sinking a 6 foot long 4' x 4' wood post into a cement hole measuring 18" wide and 24" deep. A 1' x 1' piece of wood 1" thick will then be attached to the post and then an aluminum sign attached to that. The design of the signs will be done in cooperation with the Parks and Recreation Department to ensure consistency with the overall Park "look" and standards.

#### *Paths and Out of Bounds:*

Install steps (possibly railroad ties) into the trail on the Eastern Side of the Knoll and install roped pathways where designated. Out of Bounds would be designated by a yellow rope on the ground between short 4x4 posts in the ground much like the Out of Bounds found at Pinto Lake.

### **Maintenance:**

#### *Baskets:*

SHDGC will be responsible for pulling the baskets each November, storing them, and replacing them in March. In the unlikely event that one of the baskets is stolen or damaged beyond repair, the Club agrees to repair or replace it.

#### *Signs:*

SHDGC will be responsible for maintaining the course signs, ensuring that they remain free of graffiti and replacing them in the event they become damaged due to vandalism or weather.

# Proposal for Enhancement to Anna Jean Cummings County Park; Seasonal Nine Hole Recreational Disc Golf Course

---

## *Trash:*

SHDGC will be responsible for taking care of all trash cans and picking up any trash on the course or nearby. The trash cans will be locked to a foundation with a dead bolt, unlocked with a key, and will be taken out when full. The club will replace them in the event that they are stolen or damaged beyond repair.

We will have a rotating schedule of duties that members of the SHDGC will perform weekly. We have an active recruiting program, which already includes six incoming 8th graders from both Shoreline and New Brighton Middle School, ensuring that we will have a steady flow of members to continue course maintenance under the supervision of the Club Adviser.

## ***Additional Responsibilities:***

- 9 temporary baskets can be brought in so that Park staff can have a chance to see what the proposed course would look like.
- Provide a liaison to the Department on maintenance and recreational program issues.
- All physical changes to the facility shall be requested in writing and approved in advance by the Recreation and Parks Department.
- Provide the Department with a quarterly report on the installation, operation and maintenance issues.

## ***RESPONSIBILITIES OF THE PARKS & RECREATION DEPARTMENT***

The Parks Department will:

- Designate Department personnel to work with SHDGC in coordinating the approval process for the course layout and development of the course.
- Provide two waste receptacles for the course.
- Provide wood-chips for the club to distribute on the course when necessary.
- Notify the club of any grievances communicated to the department about the appearance or operation of the course.

# Proposal for Enhancement to Anna Jean Cummings County Park; Seasonal Nine Hole Recreational Disc Golf Course

---

## ESTIMATED PRELIMINARY BUDGET

<u>Item</u>	<u>Quantity</u>	<u>Unit Cost</u>	<u>Total</u>
Mach III Deluxe Disc Pole Hole	9	\$399.00	\$00.00
Additional Anchor Assemblies	9	\$24.00	\$216.00
Concrete for Installation of Baskets and signs,	9x4=36 (80lb. bags)	\$4.00	\$144.00
Small directional signs	9	\$10.00	\$90.00
Tee Signs (Wood and Metal Shop)	9	\$50.00	\$450.00
Master Locks	9	\$11.00	\$99.00
Rope (3/8" Hollow Braid)	4 (100ft. ea.)	\$12.00	\$48.00
4x4 Pressure Treat Posts	16 (10')	\$17.00	\$272.00
Rules and Information Sign	1	\$100.00	\$100.00
Concrete Tee Pads	9x24=216(80lb. bags)	\$4.00	\$864.00
Forms for pads	Will be donated by local concrete contractor		
<i>(Alternative Rubber tee pads (fly18.com) 90' x5'x 1/2"</i>		\$1260.00	\$1260.00)
Labor for Installation	Volunteers		Volunteers
<b>Total (Concrete) : Approx.</b>			<b>\$2193.00</b>
<b>Total (Rubber) : Approx.</b>			<b>\$2589.00</b>

### Fundraising completed

-Sold discs for a Team Keen sponsored fundraiser , in which the proceeds were donated to the club

### Fundraising to be done if proposal is approved

-Disc Golf Tournament at SLV and Aptos (work together with other schools for common goal)

-Place a donation box at the beginning of the course

-Pizza My Heart, Panda Express fundraisers (30% of proceeds)

-Tee Sponsors (1 year=\$100) (5 year \$350) (Lifetime \$1000) (x9)

-Bake Sales

# Proposal for Enhancement to Anna Jean Cummings County Park; Seasonal Nine Hole Recreational Disc Golf Course

## Annex 1

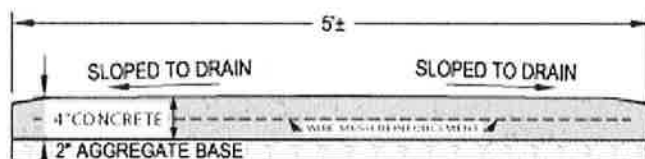
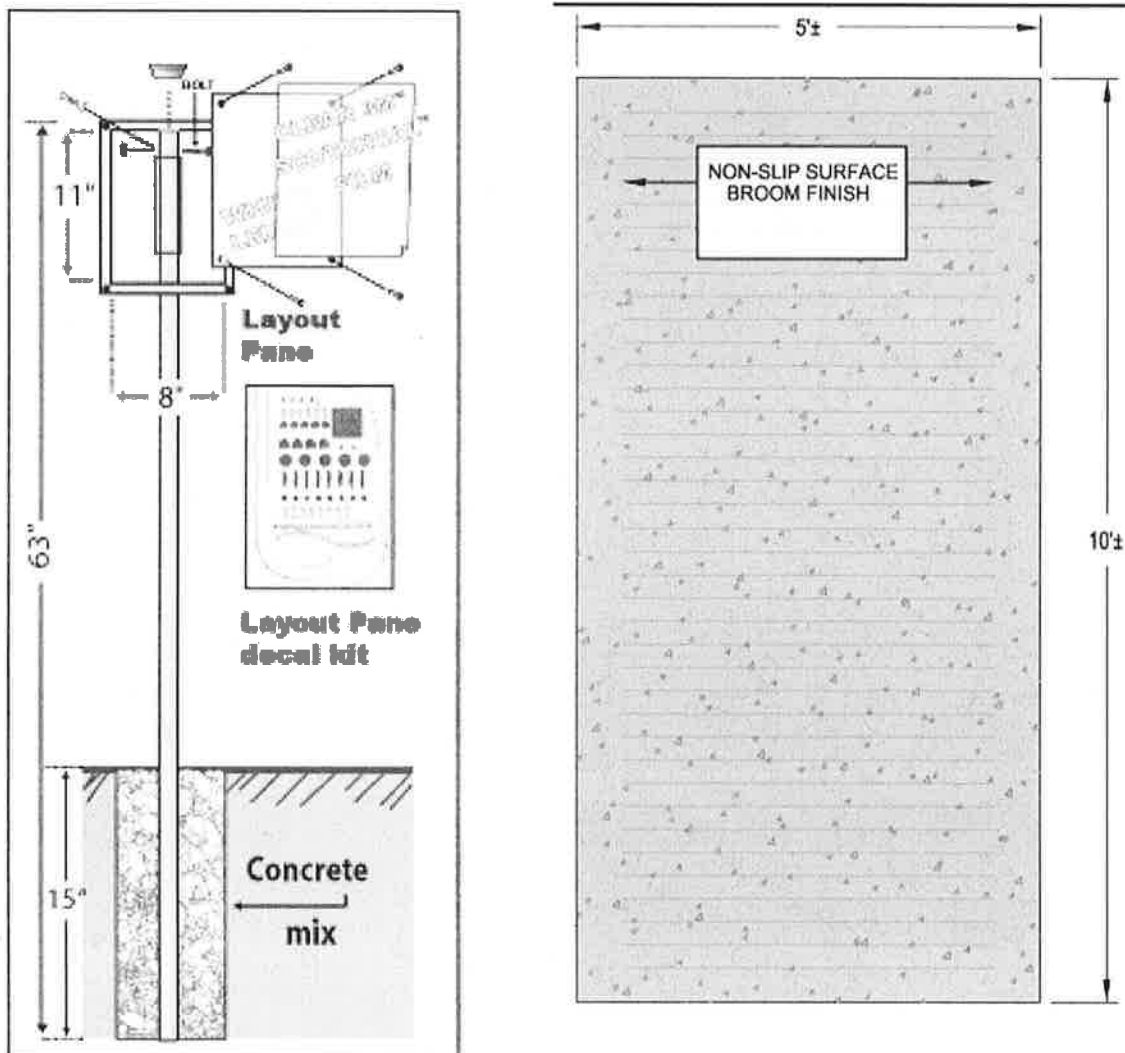

# Proposal for Enhancement to Anna Jean Cummings County Park; Seasonal Nine Hole Recreational Disc Golf Course

## Annex 2

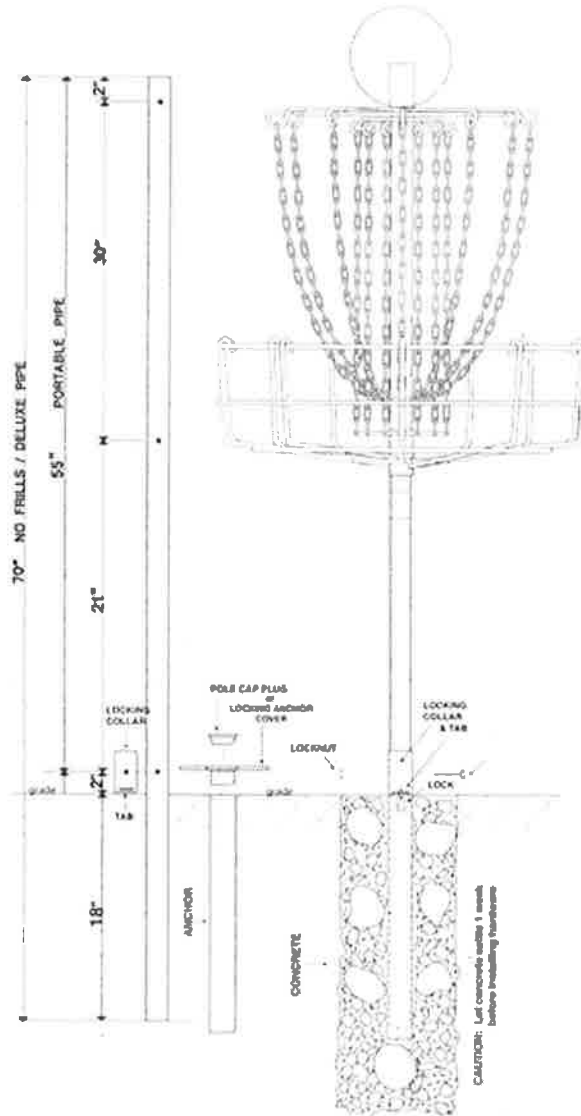

### Sequel Disc Golf Course Proposal Works Cited

County of Santa Cruz Redevelopment Agency. *Anna Jean Cummings Park*. County of Santa Cruz Redevelopment Agency. N.p.: n.p., 1998. 10. Print.



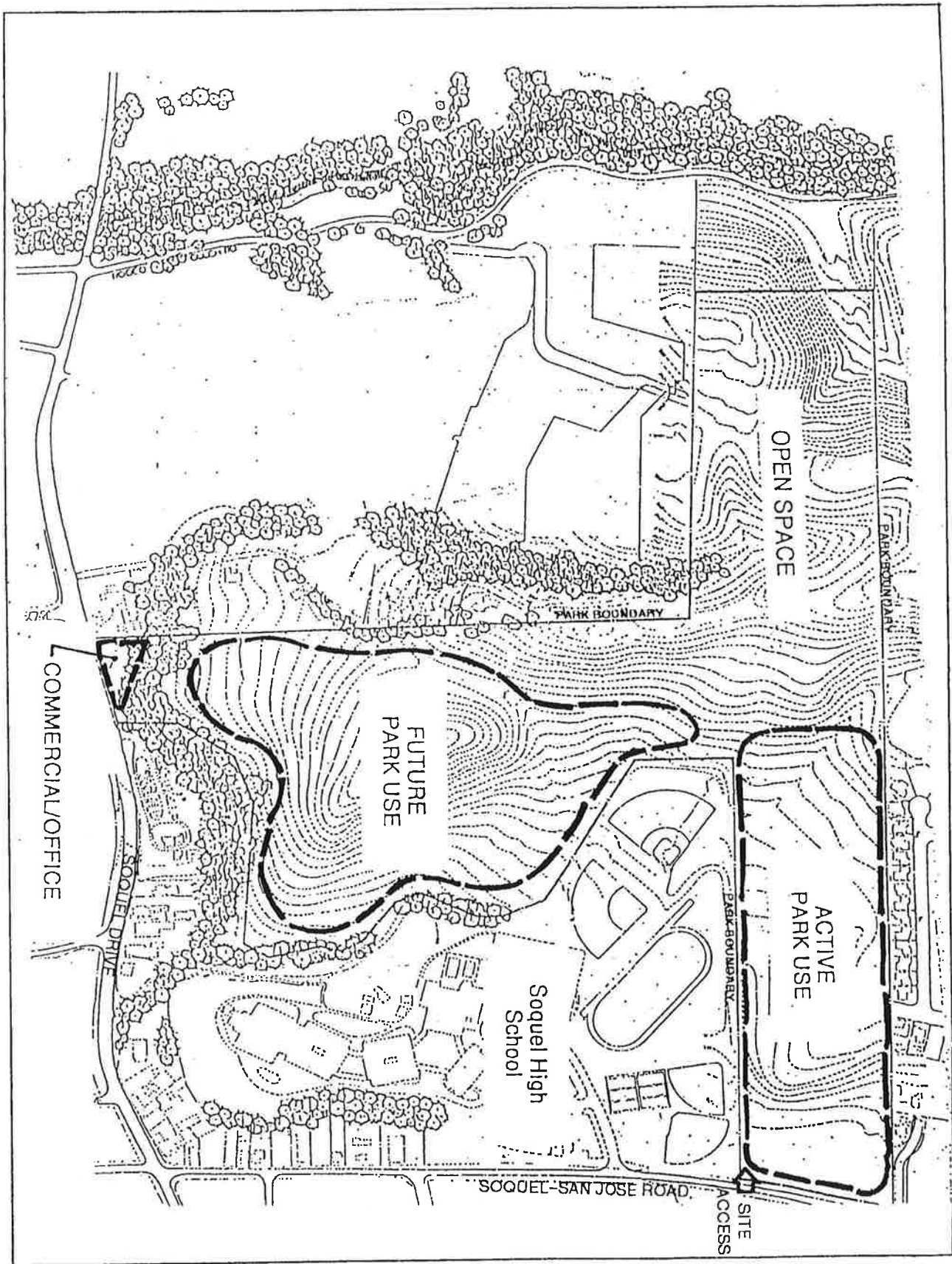



Anna Jean Cummings Park  
 Conceptual Land Use Plan

Figure 3



# Soquel Disc Golf Course Proposal



-  tee box
-  basket

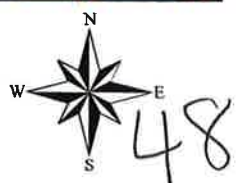
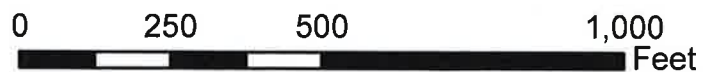





# County of Santa Cruz

## DEPARTMENT OF PUBLIC WORKS PARKS, OPEN SPACE, AND CULTURAL SERVICES DIVISION

979 17<sup>TH</sup> AVENUE, SANTA CRUZ, CA 95062

(831) 454-7901 FAX: (831) 454-7940 TDD: (831) 454-7978

JOHN J. PRESLEIGH  
INTERIM DIRECTOR

**AGENDA: MAY 21, 2012**

May 16, 2012

**SUBJECT: SANTA CRUZ COUNTY FISCAL YEAR 2012-13 PROPOSED BUDGET**

Members of the Parks and Recreation Commission:

One of the duties of the Commission is to review the annual budget for Parks, Open Space and Cultural Services, and make recommendations to the Board of Supervisors. Attached is the Santa Cruz County Fiscal Year 2012-13 Proposed Budget for Parks, Open Space and Cultural Services. The entire County Fiscal Year 2012-13 Proposed Budget is available on-line at

[http://sccounty01.co.santa-cruz.ca.us/prop\\_budget2012-13/Proposed\\_Budget\\_2012-2013.pdf](http://sccounty01.co.santa-cruz.ca.us/prop_budget2012-13/Proposed_Budget_2012-2013.pdf)

The County is facing another difficult budget year, and the proposed budget reflects a reduction in net County cost for the Parks Division of over \$280,000 for a total net County cost of \$2,274,066. We are pleased to note that the proposed budget does not include any staff reductions. In addition, the proposed budget incorporates increased revenues of over \$260,000, offsetting the need for deeper cuts. The attached narrative describes the accomplishments of the Parks Division over the last fiscal year and recommendations for the coming fiscal year.

It is recommended that the Parks and Recreation Commission review and discuss the proposed budget and make recommendations to the Board of Supervisors.

Yours truly,

JOHN J. PRESLEIGH  
Director of Public Works

By:

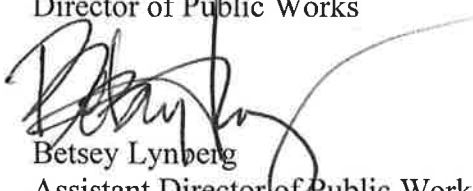
  
Betsey Lynberg

Assistant Director of Public Works

Parks, Open Space and Cultural Services Division

BAL:mh  
Attachment

May 21 proposed budget letter.doc

**PARKS, OPEN SPACE AND CULTURAL SERVICES**  
**John J. Presleigh, Director of Public Works**  
 Index Numbers: 491100 - 495900

Fund: General Fund  
 Function: Recreation  
 Title: Parks, Open Space  
 and Cultural Services

Requirements	Actual 2010-11	Appropriated 2011-12	Estimated 2011-12	Requested 2012-13	Recommended 2012-13	Change From 2011-12
Salaries & Benefits	\$4,292,789	\$3,680,079	\$3,835,475	\$3,856,721	\$3,856,721	\$176,642
Services & Supplies	\$1,461,221	\$1,994,624	\$1,947,479	\$1,796,604	\$1,796,604	(\$198,020)
Other Charges	\$0	\$0	\$0	\$13,000	\$13,000	\$13,000
Fixed Assets	\$0	\$0	\$0	\$0	\$0	\$0
Intra-Fund Charges	(\$194,587)	(\$39,731)	(\$53,431)	(\$53,431)	(\$53,431)	(\$13,700)
<b>TOTAL EXPEND</b>	<b>\$5,559,423</b>	<b>\$5,634,972</b>	<b>\$5,729,523</b>	<b>\$5,612,894</b>	<b>\$5,612,894</b>	<b>(\$22,078)</b>
Less: Revenue	(\$2,808,775)	(\$3,078,066)	(\$3,172,617)	(\$3,338,828)	(\$3,338,828)	(\$260,762)
<b>NET COUNTY COST</b>	<b>\$2,750,648</b>	<b>\$2,556,906</b>	<b>\$2,556,906</b>	<b>\$2,274,066</b>	<b>\$2,274,066</b>	<b>(\$282,840)</b>
Positions		34.80	34.80	34.80	34.80	0.00
Unfunded Positions		0.00	0.00	0.00	0.00	0.00

In an effort to achieve operational efficiencies in County operations and conserve limited general fund resources, the Parks, Open Spaces and Cultural Services Department was consolidated with the Department of Public Works in fiscal year 2011-12 as a separate division.

The Parks Division continues its mission to acquire, develop and provide safe, well designed and maintained parks while offering a variety of recreational and cultural opportunities for the community. This includes the operation of the County's 1,400 acre park system, Simpkins Family Swim Center, a variety of after-school and summer recreational programs, as well as cultural services programs. Over the last decade the community of Santa Cruz County has seen a 30 percent increase in the number of active parks. These new parks and open space areas provide a wealth of recreational opportunities for residents and non-residents alike. The Parks Division is also responsible for providing staff to the County's Parks and Recreation Commission and the County's Arts Commission. Funding of community programs offered through other providers is included in the Parks Division budget. Staff continues to evaluate and implement new processes and fee structures to improve efficiencies in order to continue to provide quality recreational and cultural opportunities with a smaller workforce.

Responsibility for maintenance of managed park sites has grown from 56 to 59 sites over the last fiscal year, and the division continues to host over 900 functions annually. In addition, staff manage concessionaires and the rentals of private houses in County park sites, provide oversight of community gardens, the memorial bench program, grazing contracts, volunteer programs, and horse-boarding. Park sites range in location from Pinto Lake Park in the south to Greyhound Rock in the north, and from beach access points along the coast to the 410 acre Miller property located in Boulder Creek.

The Parks Division is divided into four areas with the following responsibilities:

Maintenance and Facilities

This section provides maintenance to all 59 park sites and hosts over 900 functions annually. Park sites range in location from Pinto Lake Park in the South, to Greyhound Rock in the North, and from beach access points along the coast to the 410 acre Miller property located in Boulder Creek. In addition, facilities staff administer the use and rental of all park buildings, beaches and park sites, manage concessionaires and the rentals of private houses in County park sites, provide oversight of community gardens and grazing contracts, horse-boarding activities, and work closely with maintenance staff to maximize the use of public facilities.

Aquatics

Aquatics Program staff manage the Simpkins Family Swim Center programs, including lap and recreational swimming, swim lessons, Junior Lifeguards, lifeguard training classes, water aerobics classes, adult fitness, and adult drop-in water polo. In addition, the Swim Center hosts a Therapeutic Swim Program through Dominican Hospital, Cabrillo and Santa Cruz County Aquatics swim teams, private swim lessons, physical education swim classes for Shoreline Middle School students, and over 40 private rental pool parties each year. In all, Swim Center visits exceed approximately 110,000 a year. Staff continue to develop new program opportunities to meet the needs of the community and increase participation at the Swim Center. During the 2011-12 fiscal year a Spring Break Swim Camp was added, and a new Little Guards Program is planned for the summer.

Recreational and Cultural Services

Recreational Program staff has been restructured in order to provide greater flexibility and better meet the workload demands. Recreational staff have continued to administer Youth Programs, including summer camps and after-school programs; interpretive nature programs centered at Quail Hollow Ranch; Senior Programs, including a variety of well-attended trips and the Capitola Mall Walking and Exercise Program; Cultural Services and Arts Programs, including managing the selection process and installation of public art, coordinating art exhibitions in various County buildings, installation of new pieces of work for the permanent County art collection, and selection of the County Artist of the Year. Finally, Recreation and Cultural Services Program staff conducted a number of annual special events, such as free swim on the 4th of July, the Super Kid Triathlon, and the Holiday Art and Craft Fair.

Resource and Development

Resource and Development staff has experienced a busy year overseeing the completion of Felt Street Park in Live Oak; planning for and implementing grant funded park improvements, including play area and picnic area improvements at Ben Lomond, Willowbrook and Pinto Lake parks, beach access improvements, re-roofing of the historic Felton Covered Bridge, habitat and community garden improvements at the Farm Park; managing needed facility repairs; as well as planning for phased construction of improvements at a number of park sites. The Resource and Development staff includes three Project Managers responsible for completion of the final redevelopment funded capital improvement projects, including the Center for Public Safety Project, the Behavioral Health Unit, East Cliff Drive Parkway, Twin Lakes Beachfront, Heart of Soquel, Upper Porter Street, coordination with the City of Santa Cruz for implementation of the Arana Gulch Path, and coordination with the Live Oak School District and the Boys and Girls Club for a new Youth Center on the Shoreline Middle School campus in Live Oak.

2012-13 RECOMMENDED BUDGET

The recommended budget provides for a decrease of \$22,078 in expenditures and an increase of \$260,762 in revenues resulting in a net decrease of \$282,840 in Net County Cost. The 2012-13 budget places priority on maintaining core park services, facilities, and programs on a year-round basis.

### Expenditures

The recommended increase in salaries and benefits in the amount of \$176,642 is due to a general increase in salary and benefit costs.

Reductions in the amount of \$198,020 in services and supplies accounts are the result of decreases in several areas, primarily liability insurance, DPW service charges, supplies and materials for parks maintenance.

An increase in the amount of other charges for \$13,000 is the result of a lease-purchase of a new lawn mower and an increase in intra-fund charges of \$13,700 is primarily due to increase in reimbursements for the maintenance of County-owned facilities.

### Revenues

The recommended increase in revenues of \$260,762 is primarily due to the increase in revenues from summer facility rentals at Quail Hollow Ranch, after-school and summer recreation fees, and Swim Center fees.

The proposed budget is expected to achieve the following efficiencies and have the following impacts:

#### Maintenance

Maintenance staff will continue to prioritize its reduced workforce on providing clean and usable parks, based on visitor use and public safety. Facilities and park sites such as playfields and community centers require a higher maintenance priority than smaller parks and remote beach access points.

#### Aquatics

Staffing at the Swim Center remains status quo and the recommended budget reflects adjustments to the pool schedule that result in an overall increase in hours that the Swim Center will be open to the public. We are pleased to report that with the anticipated changes that have been incorporated, the pool will be open 296 days in the year. Hours of operation will remain essentially the same as for the past two fiscal years, with increased hours expected on some Saturdays. Fees for multiple entry passes and for lessons and classes are proposed to increase based on costs but will remain at or below market for the Santa Cruz area.

The addition of a spring swim camp, a little guards program and winter swim lessons will continue in fiscal year 2012-13. The overall increase in hours that the Swim Center is open is anticipated to result in increased use and programming, and thus higher revenues during the busy season and a reduction in cost during the slower seasons. The fee structure and schedule continue to be evaluated for improvements to better serve the community while reducing Net County Cost.

#### Recreational Programs and Cultural Services

Arts-related programs, year-round classes, youth programs, and the nature programs at Quail Hollow will continue as the result of improved cost recovery for after-school and summer recreation programs, and expenditure of the balance of one-time grants for programs at Quail Hollow Ranch. A number of new trips are proposed for the Seniors Program along with the continuation of the popular Capitola Mall Walking Program.

Resource and Development

There are no proposed budget impacts for the Resource and Development area.

STAFFING

There are no staffing changes other than the mid-year reclassification of a 1.0 FTE Recreation Coordinator to a Program Coordinator.

Position	Salary Range	2011-12 Allowed	Mid Year Change	2011-12 Total	2012-13 Request	2012-13 Recomm	Recomm Change	2012-13 Unfunded
Aquatics Coordinator	Y4	1.00	0.00	1.00	1.00	1.00	0.00	0.00
Aquatics Supervisor	52	1.00	0.00	1.00	1.00	1.00	0.00	0.00
Building Maintenance Wkr III	IF	0.00	0.00	0.00	0.00	0.00	0.00	0.00
Parks Maintenance Supervisor	JM	4.00	0.00	4.00	4.00	4.00	0.00	0.00
Parks Maint Worker II/I	Y8/36	17.00	0.00	17.00	17.00	17.00	0.00	0.00
Parks Maint. Worker III	ES	1.00	0.00	1.00	1.00	1.00	0.00	0.00
Parks Manager – Maintenance	LP	1.00	0.00	1.00	1.00	1.00	0.00	0.00
Parks Mgr-Resource & Develop	TBD	1.00	0.00	1.00	1.00	1.00	0.00	0.00
Program Coordinator	BV	1.00	1.00	2.00	2.00	2.00	1.00	0.00
Project Manager	MY	3.00	0.00	3.00	3.00	3.00	0.00	0.00
Recreation Coordinator	Y4	4.80	(1.00)	3.80	3.80	3.80	(1.00)	0.00
<b>Parks Division Total</b>		<b>34.80</b>	<b>0.00</b>	<b>34.80</b>	<b>34.80</b>	<b>34.80</b>	<b>0.00</b>	<b>0.00</b>

**CULTURAL RESOURCES**  
**John J. Presleigh, Director of Public Works**  
 Index Number: 134904

Fund: General Fund  
 Function: Recreation  
 Title: Cultural Resources

Requirements	Actual 2010-11	Appropriated 2011-12	Estimated 2011-12	Requested 2012-13	Recommended 2012-13	Change From 2011-12
Other Charges	\$263,117	\$294,210	\$294,210	\$235,445	\$235,445	(\$58,765)
<b>TOTAL EXPEND</b>	<b>\$263,117</b>	<b>\$294,210</b>	<b>\$294,210</b>	<b>\$235,445</b>	<b>\$235,445</b>	<b>(\$58,765)</b>
Less: Revenue	\$0	\$0	\$0	\$0	\$0	\$0
<b>NET COUNTY COST</b>	<b>\$263,117</b>	<b>\$294,210</b>	<b>\$294,210</b>	<b>\$235,445</b>	<b>\$235,445</b>	<b>(\$58,765)</b>

The Cultural Resource budget funds contracts with the Cultural Council of Santa Cruz County, the Museum of Art & History at the McPherson Center, and the Santa Cruz County Veterans Memorial Building Board of Trustees.

2012-13 RECOMMENDED BUDGET

The recommended budget for Cultural Resources reflects a \$58,765 decrease due to 15% reduction in funding for the three community programs financed in this budget index, due to fiscal constraints. All of the agencies requested status quo funding.

Cultural Council of Santa Cruz County: The contract with the Cultural Council provides funds for a broad range of arts, entertainment and educational activities benefiting County residents and visitors. These programs include workshops, grants to existing programs such as SPECTRA (Arts in Education) and overall coordination of arts activities in the County. The Arts Commission annually reviews the activities of the Cultural Council. The recommended budget allocates \$106,427 for this contract, a reduction of \$18,781 from FY 11/12.

The Museum of Art & History at the McPherson Center: The contract with the Museum of Art & History (MAH) provides funds for the operation and maintenance of the MAH, liaison services to the Historical Resources Commission, and development of historic preservation services throughout the County. MAH's strategic vision is to share the excitement and passion of Trustees, members, volunteers and staff for both history and contemporary art to all residents through exhibitions, educational programs and opportunities for research in the organization's archives. Pursuant to the agreement between the County and MAH, the organization retains any revenues generated by activities under the agreement to expand historical services to County residents. The recommended budget allocates \$94,019 for this contract, a reduction of \$16,592 from FY 11/12.

Santa Cruz County Veterans Memorial Building: The contract with the Santa Cruz County Veterans Memorial Building Board of Trustees for the operation and maintenance of the Santa Cruz County Veterans Memorial Building was cancelled on April 2, 2010 due to potential life safety issues with the building. The recommended budget includes appropriations of \$34,999 for ongoing responsibilities for the Veterans new space at the Emeline complex. This amount reflects a reduction of \$6,176 from the FY 11/12 amount of \$41,175. Additional funds of \$17,216 were carried over to this budget from FY 10/11 to accommodate moving and improvement costs at the Emeline location.



**ART IN PUBLIC PLACES**  
**John J. Presleigh, Director of Public Works**  
 Index Number: 134909

Fund: Custodial Funds/Parks  
 Function: Recreation & Cultural Services  
 Title: Art in Public Places

<u>Requirements</u>	<u>Actual 2010-11</u>	<u>Appropriated 2011-12</u>	<u>Estimated 2011-12</u>	<u>Requested 2012-13</u>	<u>Recommended 2012-13</u>	<u>Change From 2011-12</u>
<b>Appropriations</b>						
Other Charges	\$0	\$0	\$13,500	\$151,300	\$151,300	\$151,300
Fixed Assets	\$49,350	\$122,450	\$148,648	\$80,000	\$80,000	(\$42,450)
<b>Total</b>	<b>\$49,350</b>	<b>\$122,450</b>	<b>\$162,148</b>	<b>\$231,300</b>	<b>\$231,300</b>	<b>\$108,850</b>
Increase Reserve	\$4,988	\$26,198	\$26,198	\$700	\$700	(\$25,498)
<b>Total Requirements</b>	<b>\$54,338</b>	<b>\$148,648</b>	<b>\$188,346</b>	<b>\$232,000</b>	<b>\$232,000</b>	<b>\$83,352</b>
<b>Available Funds</b>						
Fund Balance Avail.	\$185,417	\$143,560	\$143,560	(\$25,598)	(\$25,598)	(\$169,158)
Cancel Reserve	\$3,355	\$4,988	\$4,988	\$26,198	\$26,198	\$21,210
Revenue	\$9,126	\$100	\$14,200	\$231,400	\$231,400	\$231,300
<b>Total</b>	<b>\$197,898</b>	<b>\$148,648</b>	<b>\$162,748</b>	<b>\$232,000</b>	<b>\$232,000</b>	<b>\$83,352</b>

The Art in Public Places budget was established to provide art in the design and development of County building and remodeling projects with construction costs exceeding \$100,000. Public art is located in highly visible public areas or in areas regularly frequented by the general public and is intended to be enjoyed for the life of the facility.

Projects are considered for the Art in Public Places budget as part of the County's annual budget cycle. If approved, a budget allowance up to 2 percent of the total construction costs may be allocated for works of art for projects subject to this policy.

2012-13 RECOMMENDED BUDGET

The recommended financing includes an estimated June 30, 2012, fund balance of \$(25,598), cancellation of designations/reserves of \$26,198, project funding of \$151,300 from third-party agreements for the Behavioral Health Unit, Heart of Soquel and Twin Lakes beachfront projects, contribution from the Sanitation Department of \$60,000 for the Hidden Beach Pump Station project, contribution from CSA 9 of \$20,000 for Traffic Box Art, and interest earnings of \$100. The recommended appropriations are \$231,300, leaving an estimated \$700 in reserves.

<u>Project</u>	<u>12-13 Recom</u>
Traffic Box Art	\$ 20,000
Twin Lakes Beachfront Improvements	1,500
Behavioral Health Unit	140,000
Heart of Soquel	9,800
Hidden Beach Pump Station	60,000
<b>TOTAL</b>	<b>\$ 231,300</b>

WRITTEN CORRESPONDENCE LISTING:

The Written Correspondence Listing is established to act as a report of materials received by the Commission as a whole, but may also include items requested for inclusion by individual Commissioners.

The Parks and Recreation Commission has received the following items of correspondence which require no official action by the Commission at this time:

1. Letter of County of Santa Cruz Board of Supervisors dated February 14, 2012, conveying gratitude for the biennial report submitted to the Board.
2. Letter of John Shower dated March 18, 2012, regarding proposed addition of disc golf course at Anna Jean Cummings Park.
3. Correspondence of Jean Brocklebank and Michael Lewis dated March 20, 2012, regarding off-leash dogs on Santa Cruz County Beaches.
4. Letter of Lisa Sheridan dated March 21, 2012, regarding proceedings at the March 19, 2012, Parks and Recreation Commission meeting.
5. Letter of Elizabeth Levy dated March 23, 2012, regarding proceedings at the March 29, 2012, Parks and Recreation Commission meeting.
6. Letter of Nikki Simpson dated March 26, 2012, regarding proceedings at the March 19, 2012, Parks and Recreation Commission meeting.
7. Letter of Vivian Fenner-Evans dated March 26, 2012, regarding proceedings at the March 19, 2012, Parks and Recreation Commission meeting.
8. Letter of Jeri Bethesda regarding off-leash dogs on county beaches.
9. Letter of Becky Kohler regarding off-leash dogs on county beaches.
10. Letter of Brett Walter dated March 24, 2012, regarding off-leash dogs on county beaches.
11. Letter of Wayne Haffner regarding off-leash dogs on county beaches.
12. Letter of Joseph Stevens regarding off-leash dogs on county beaches and parks.
13. Letter of Robert Mallon regarding off-leash dogs on county beaches.
14. Letter of County of Santa Cruz Commission on the Environment dated April 3, 2012, regarding Highlands Park recycled tire chip.
15. Letter of Liz Levy dated April 12, 2012, regarding off-leash dogs on county beaches.
16. Correspondence of Christopher Mann dated April 23, 2012, Polo Grounds Park Improvement Idea.
17. Correspondence of Derek Barbe regarding off-leash dogs on county beaches.